



GENERAL PRODUCT INFORMATION:



This product is suitable for indoor dry locations only.

NOTE: MAX Load 50W per port.



Install the MonoPoint Canopy

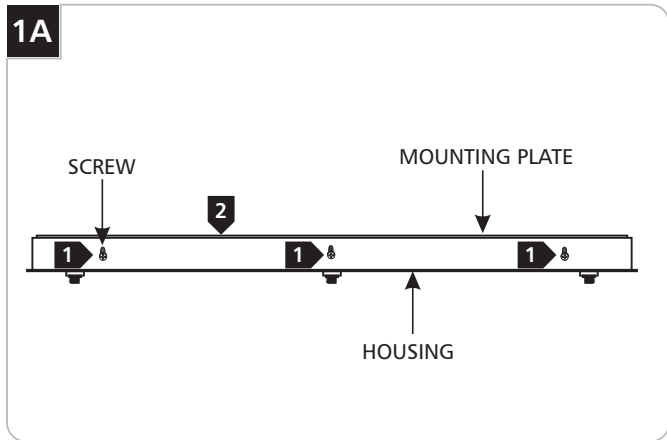

- 1** Remove the six screws on canopy sides with a Phillips screwdriver.
- 2** Lift the mounting plate from housing.

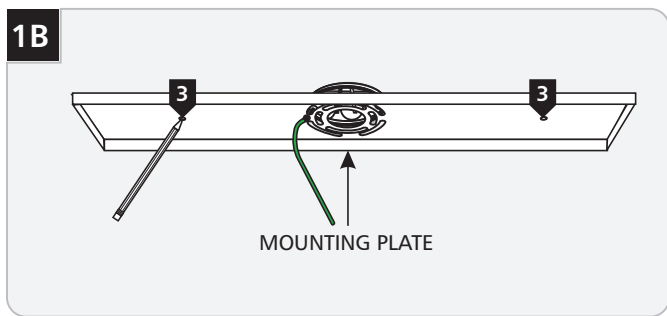

- 3** Align the mounting plate slots with the electrical box holes and mark two points onto the ceiling through the mounting holes.

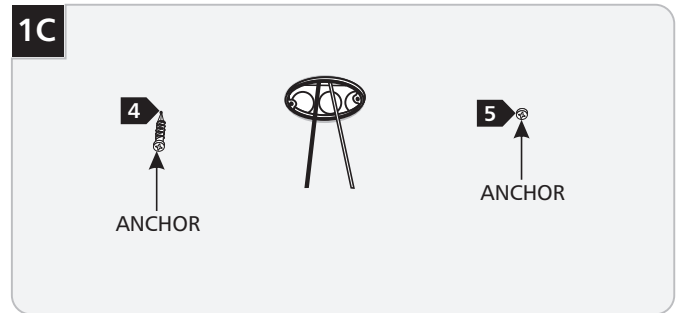

- 4** With a hammer tap the anchors at the marked points up to the threaded portion.
- 5** Screw the anchors in the rest of the way with a Phillips screwdriver.

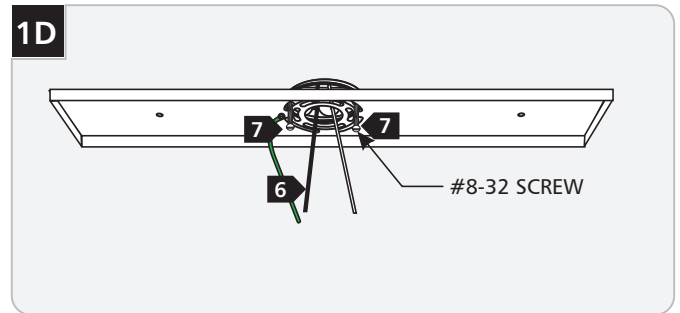

- 6** Feed the 120 volt power line wires through the mounting plate center hole.
- 7** Line up the two mounting plate slots with the electrical box holes and use the two provided #8-32 screws to mount it to the electrical box.

1E



- 8 Secure the mounting plate to the anchors with the provided #8 screws.

1F

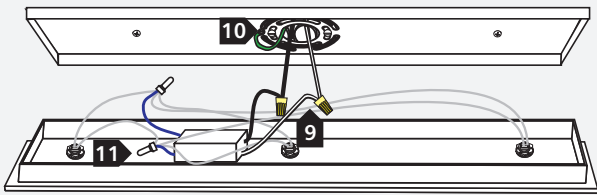

- 9 Connect the black wire to the hot power line wire and the white wire to the neutral power line wire with wire nuts.
- 10 Ground the mounting plate in accordance with local electrical codes.
- 11 Place all wires properly inside the canopy.

1G

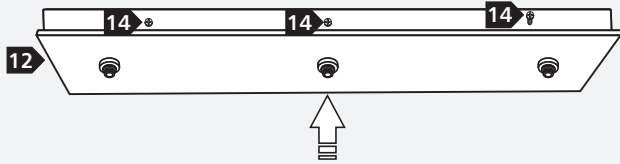

- 12 Slide the housing onto the mounting plate.
- 13 Line up the housing holes with the mounting plate.
- 14 Replace and tighten the six screws to secure the canopy.

Connect the Fixtures to the 3-Port MonoPoint Canopy

2A

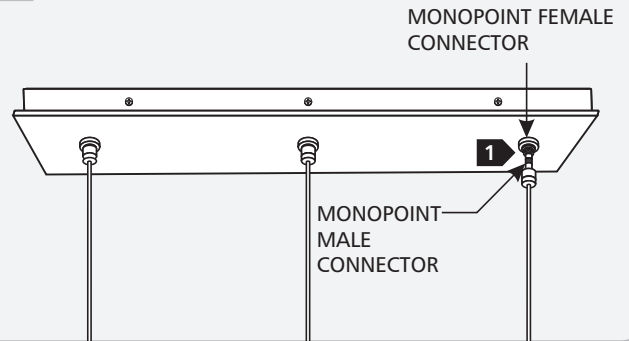

- 1 Screw the fixture MonoPoint male connectors into the canopy female connectors.

SAVE THESE INSTRUCTIONS!

tiella[™]
real light, real simple

7400 Linder Ave, Skokie, IL 60077
847.410.4400

www.tiella.com

© 2008 Tech Lighting, L.L.C. All rights reserved. The "tiella" graphic is a registered trademark of tiella. tiella reserves the right to change specifications for product improvements without notification.

A Generation Brands Company