

Largo Sconce

800SCLARWS 1.4

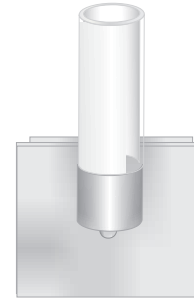

GENERAL PRODUCT INFORMATION:



This product can mount to either a 4" square electrical box with round plaster ring or an octagon electrical box.

This product can be dimmed with a standard incandescent dimmer.

CAUTION—RISK OF FIRE
 This product requires installation by a qualified electrician. Before installing be sure to read all instructions and **TURN THE POWER TO THE ELECTRICAL BOX OFF.**

Install the Backplate

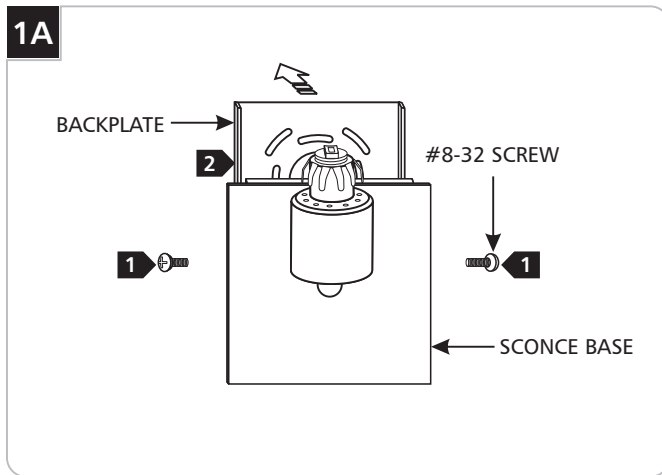

- 1** Remove the two #8-32 screws on the backplate with a Phillips head screwdriver.
- 2** Remove the backplate from the sconce base.

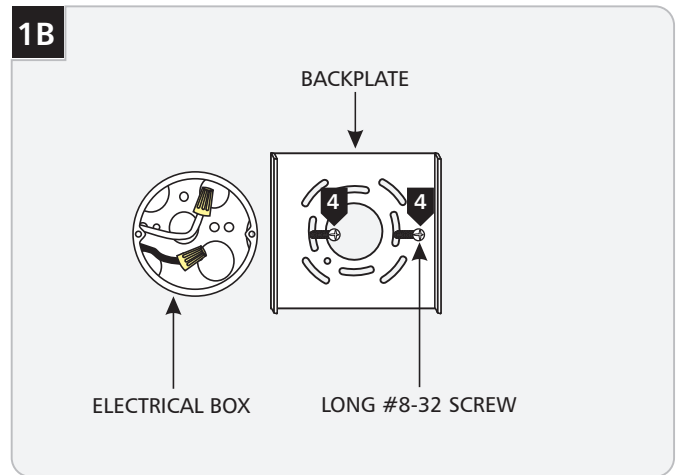

- 3** Turn the power to the electrical box off.
- 4** Mount the backplate to the electrical box with two long #8-32 screws.

Connect the Power

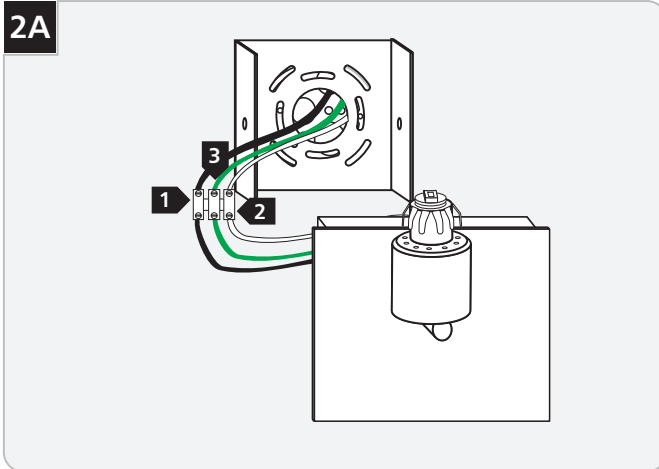

- 1 Insert the hot power line wire into the terminal contact, that is in line with the black fixture wire, and tighten the screw.
- 2 Insert the neutral power line wire into the terminal contact, that is in line with the white fixture wire, and tighten the screw.
- 3 In accordance with local electrical codes, connect the ground into the terminal contact, that is in line with the green fixture wire, and tighten the screw.

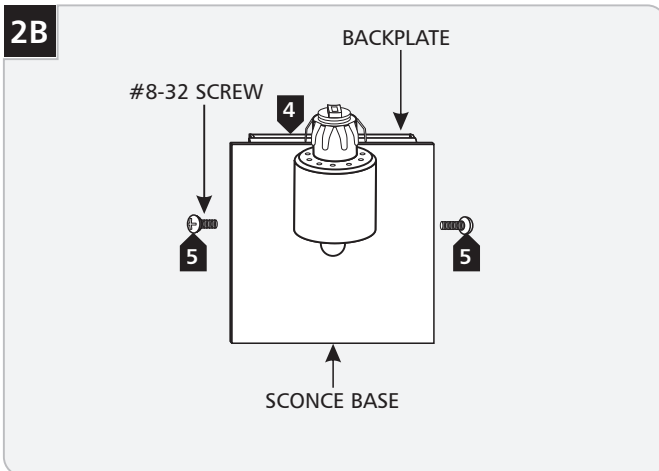

- 4 Place the sconce base onto the backplate and align the holes.
- 5 Replace and tighten the #8-32 screws.

Install the Lamp and Shade

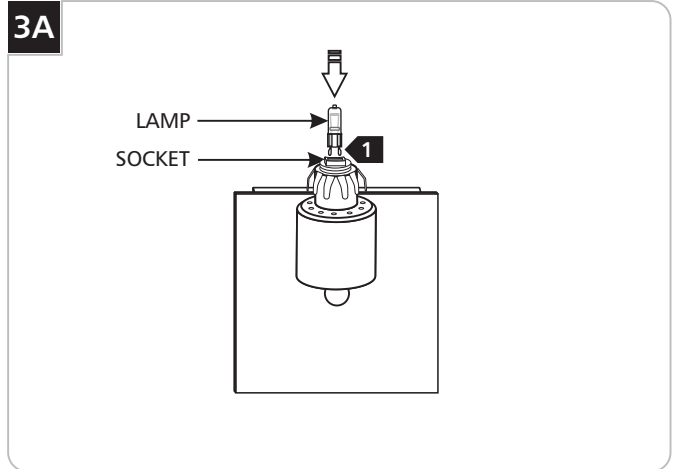

CAUTION: To reduce the risk of a burn or electric shock during relamping, disconnect the power to the fixture.

NOTE: The G9 lamp has an integral glass envelope and is thus safe to be used without a lamp shield.

NOTE: Use only your fingers and a soft cloth to replace the lamp.

Use **MAX 120 Volt, 40 Watt Type T4, G9 Base, Bi-Pin Halogen Lamp.**

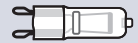

- 1 Push the lamp completely into the socket.

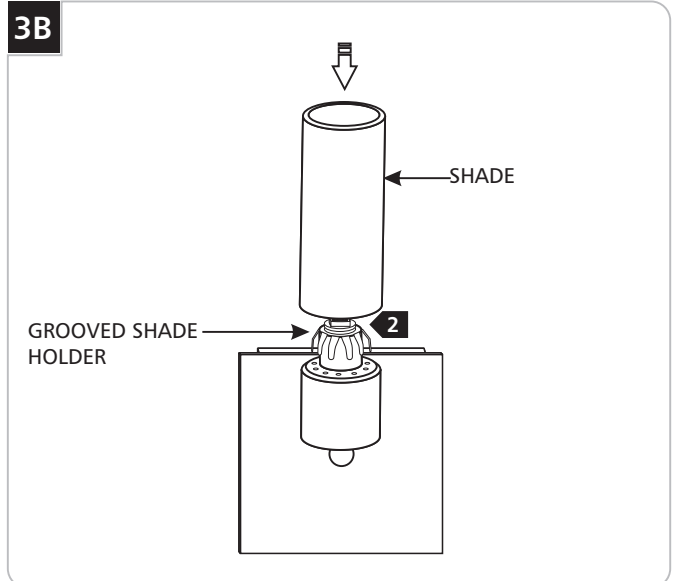

- 2 Carefully, push the shade completely onto the grooved shade holder.

IMPORTANT SAFETY INSTRUCTIONS

To reduce the risk of fire, electrical shock, exposure to excessive UV radiation, or injury to person:

- Use this fixture indoors only.
- Do not look directly at the lighted lamp.
- Do not remain in light if skin feels warm.
- Risk of fire: Use only the type of lamp and maximum wattage indicated in this instruction manual.
- Never cover the halogen lamp and never place flammable material close to your fixture.
- Never turn the fixture on and off by connecting and disconnecting the halogen lamp.
- Do not touch the fixture shade while the fixture is on. This surface may be HOT.

Halogen Lamp General Information

- A new halogen lamp may smoke slightly when it is used for the first time. This is perfectly normal; the protective coating is simply being vaporized.

Two Tips For Prolonging Halogen Lamp Life

- First avoid touching the lamp with bare hands during installation. Any contaminant, even the oil from your hands can deteriorate the lamp. Rubbing alcohol can be used to remove any contaminant.
- Second, do not run the lamps at full power when you do not need to. However, if dimming the fixture for an extended period of time, occasionally bring the light up to full brightness for a few minutes to complete the halogen cycle.

SAVE THESE INSTRUCTIONS!

tiella[™]
real light, real simple

7400 Linder Ave, Skokie, IL 60077
847.410.4400

www.tiella.com

© 2008 Tech Lighting, L.L.C. All rights reserved. The "tiella" graphic is a registered trademark of tiella. tiella reserves the right to change specifications for product improvements without notification.

A Generation Brands Company