



# Pico Sport Series

Personal Table Top Projection Screen

with dual projection materials

## User's Guide

### Contents of this package

Parts List	QTY
a. Pico Sport dual-sided screen panel	1
b. Screen base feet	2
c. Travel case	1

a.



b.



c.



#### Notes:

1. Dual sided design features a high gain (4.0) StarBright 4 material and VersaWhite (matte white 1.1 gain) material.
2. Detachable base feet minimize the dimensions of the Pico Sport to fit easily into a briefcase or laptop bag.
3. Vinyl travel case protects the Pico Sport when not in use.
4. Avoid screen material contact with any hard or sharp objects.

# Installation

1. Remove the base feet from the Pico Sport.
2. The notches on the Base feet connect with the notches at the bottom of the screen as demonstrated in the illustration.
3. Reverse steps 1 & 2 when dismantling.

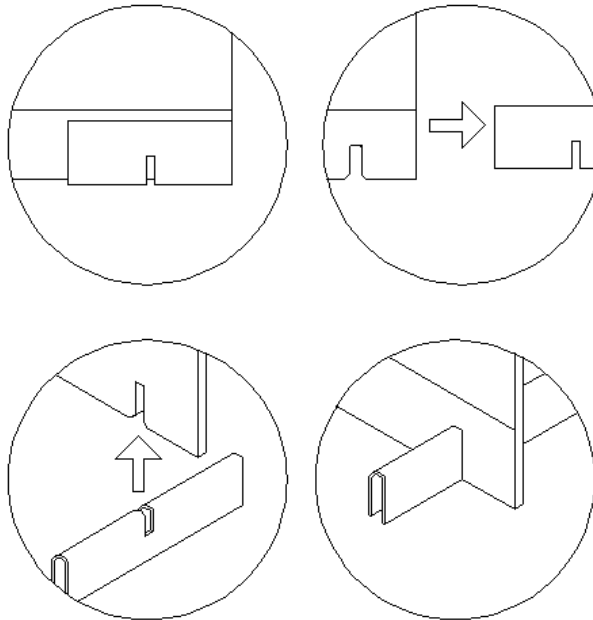

## **About the projection screen materials in the Pico Screen Series:**

The Pico Sport portable table top projection screen is a high quality product that features dual-sided front projection materials. The silver side is a 4.0 high gain material for environments with ambient light and low lumen projectors. The high gain material allows ambient room rejection which helps retain the brightness of the projector.

The white side is the matte white material which is typically the most versatile projection screen material in the market. The VersaWhite projection material used in this product is best coupled with either a high lumen projector with ambient light or with the lights almost completely off for best projection results.

For local Elite Screens contact or Technical Support, please visit

[www.elitescreens.com](http://www.elitescreens.com)