



CELESTE

FR42645SLF

Bulbs: 60W CAND. Replacement Parts: GLASS: R42640GL CRYSTAL: R42640CRY

ASSEMBLY INSTRUCTIONS

Assembly of this fixture will be accomplished by first assembling the main body, installing the mounting hardware to the junction box, making all necessary electrical connections, hanging the fixture and then attaching the fixture glass.

SAFETY WARNING: Read wiring and grounding instructions [FRIS 18] and any additional directions. Turn power supply off during installation. If new wiring is required, consult a qualified electrician or local authorities for code requirements.

STEP 1

- 1 Spread out arms (a) on lower body (1) until they are approximately 72 degree apart - See Drawing 1.
- 2 Slip secondary arm assembly (2) along wire and onto main body (1), and spread arms (b) apart until they are equally spaced over lower arms (a).
- 3 Slip center column (3) along wire and thread onto coupler (c) on top of main body (1).
- 4 Attach top of arms (b) to center column (3) using ball knob studs (4).
- 5 Slip loop (5) along wire and thread onto top of center column (3).
- 6 Thread decorative finial (6) onto bottom of fixture.
- 7 Crystals (9) can now be threaded onto the end of the stems (d).
- 8 Fixture can now be installed.

STEP 2 Refer to Hanging Instruction Sheet [FRIS19] to hang fixture. Then refer back to this sheet to continue installation of this fixture.

STEP 3

- 1 To install glass (7), slip glass over socket (e).
- 2 Slip candle sleeve (8), ringed end down over socket (e) making sure end of candle sleeve passes through hole in glass so flat ring holds glass in position.

[DRAWING 1]

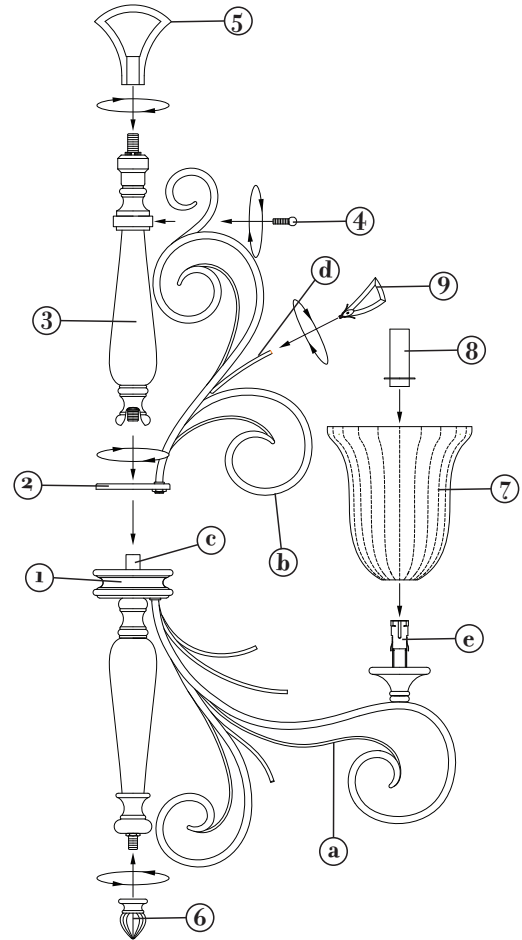

FREDRICK RAMOND

ESTABLISHED 1965

800.421.3517 WWW.FREDRICKRAMOND.COM

7.1.08