

Faucet Installation Instructions

CL101

- Hole Diameters are 1 ³/₁₆" minimum to 1 ⁵/₈" maximum
- Maximum deck thickness is 1 ¹/₂"
- This faucet comes completely assembled and water tested
- Tools required-channel lock pliers (or pipe wrench), basin wrench, small crescent wrench and Teflon tape
- Shut off water supply prior to beginning installation

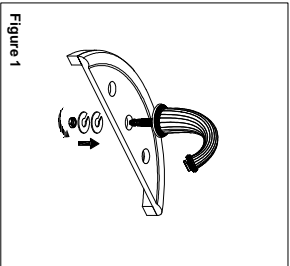

Figure 1

Step 1
Slide reseatclean onto spout shank and place spout through mounting hole in sink. Secure spout with rubber washer, metal washer and nut (in that order).

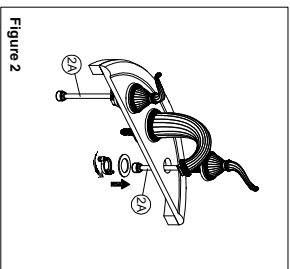

Figure 2

Step 2
Insert valves through mounting hole in sink. Hot valve is marked with red tag and should be installed on the left side of the spout. Make sure copper tubes (2A) are installed facing away from the spout. Align handles to desired position and then secure valves from underneath with metal washers and threaded lock nuts. Hand tighten lock nuts onto shank and secure position by tightening screws.

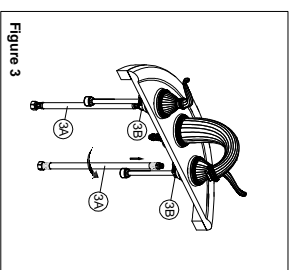

Figure 3

Step 3
Connect the supply hoses (3A) to the bottom of valve bodies (3B) as shown.

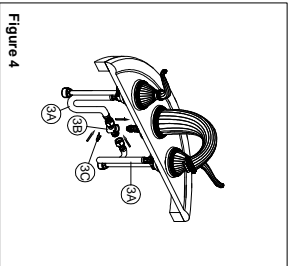

Figure 4

Step 4
Carefully bend hoses (9A) to fit available space and thread hose couplings onto sides of the Tee (9B). Insert Tee (9B) onto spout shank until it is completely seated. Place clip (9C) onto slot at bottom of Tee to secure.

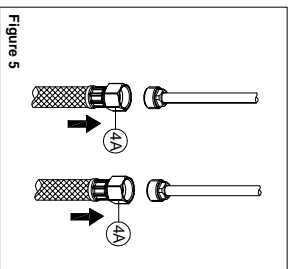

Figure 5

Step 5
Make connections to 1/2" IPS water lines (4A, not included). Use wrenches to tighten connections. Do not overtighten.

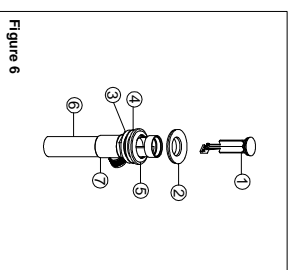

Figure 6

Step 6
Remove stopper (1) and flange (2). Screw nut (3) all the way down. Push washer (4) and gasket (5) down. Remove taplice (6) from body (7), add Teflon tape, replace taplice.

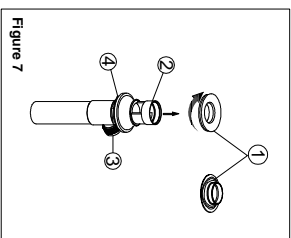

Figure 7

Step 7
Apply a small bead of Plumber's putty to underside of Flange (1). Insert body (2) into sink. Screw flange (1) into body (2). Pivot (3) must face back wall. Pull assembly down firmly and hold in place. DO NOT TWIST. Tighten nut, washer & gasket (4), clean off excess Plumber's putty.

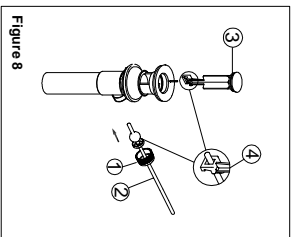

Figure 8

Step 8
Remove pivot nut (1). Insert stopper (3) into drain body, then insert rod (2) into eyelet of stopper (as shown above). Hand tighten pivot nut (1).

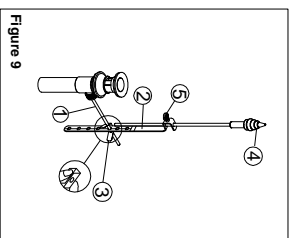

Figure 9

Step 9
Attach horizontal rod (1) to stopper (2) using clip (3). Insert lift rod (4) into strap and tighten screw (5).

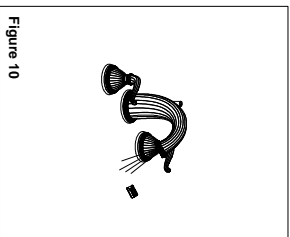
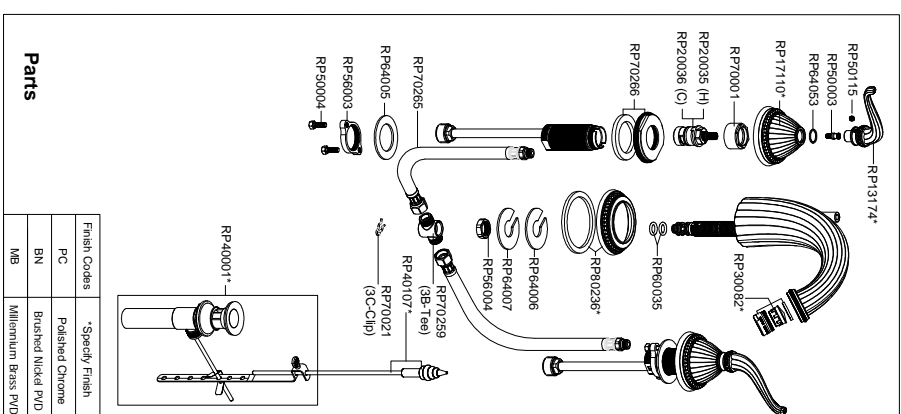

Figure 10

Step 10
Important: After installation is completed, remove aerator. Turn on water supply and allow both hot and cold water to run for at least one minute each. While water is running, check for leaks. Replace aerator.



Parts	Finish Codes	Specify Finish
RP40001	PC	Polished Chrome
	BN	Brushed Nickel PVD
	MB	Millennium Brass PVD

Maintenance: Clean with warm water, soft cotton cloth and non-abrasive liquid dish soap. Towel dry.
Never use acids, harsh abrasives, detergents, or products containing chlorides on any parts of this product.

Giag ni

For additional assistance or service call: 1-888-560-5222 USA 8:30 a.m. to 5:30 p.m. EST Monday-Friday

Faucet Installation Instructions

CL101

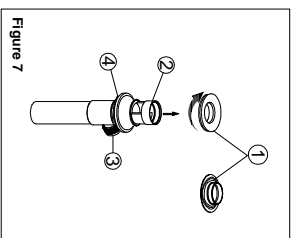

Figure 7

Step 7
Apply a small bead of Plumber's putty to underside of Flange (1). Insert body (2) into sink. Screw flange (1) into body (2). Pivot (3) must face back wall. Pull assembly down firmly and hold in place. DO NOT TWIST. Tighten nut, washer & gasket (4), clean off excess Plumber's putty.

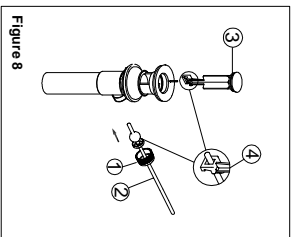

Figure 8

Step 8
Remove pivot nut (1). Insert stopper (3) into drain body, then insert rod (2) into eyelet of stopper (as shown above). Hand tighten pivot nut (1).

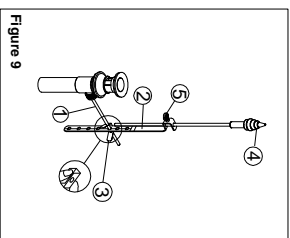

Figure 9

Step 9
Attach horizontal rod (1) to stopper (2) using clip (3). Insert lift rod (4) into strap and tighten screw (5).

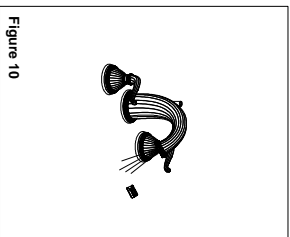
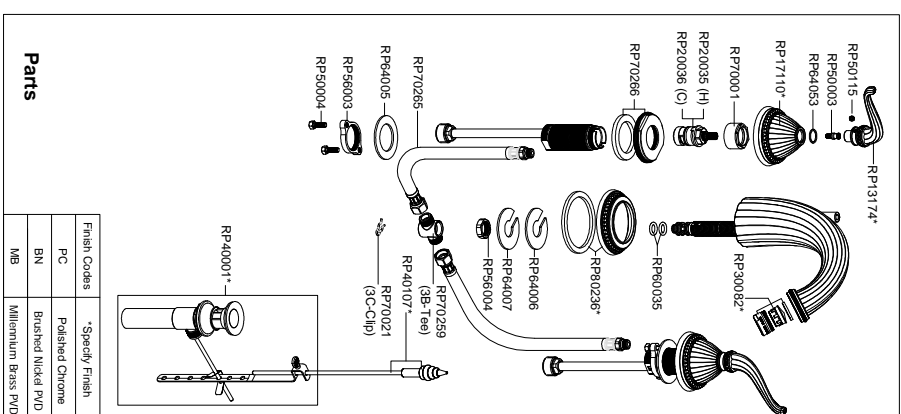

Figure 10

Step 10
Important: After installation is completed, remove aerator. Turn on water supply and allow both hot and cold water to run for at least one minute each. While water is running, check for leaks. Replace aerator.



Parts	Finish Codes	Specify Finish
RP40001	PC	Polished Chrome
	BN	Brushed Nickel PVD
	MB	Millennium Brass PVD

Maintenance: Clean with warm water, soft cotton cloth and non-abrasive liquid dish soap. Towel dry.
Never use acids, harsh abrasives, detergents, or products containing chlorides on any parts of this product.

Giag ni

For additional assistance or service call: 1-888-560-5222 USA 8:30 a.m. to 5:30 p.m. EST Monday-Friday