



910028

KITCHEN ISLAND

ASSEMBLY INSTRUCTIONS  
COASTER FINE FURNITURE



[www.coastercompany.com](http://www.coastercompany.com)

## ASSEMBLY TIPS:

1. Remove hardware from box and sort by size.
2. Please check to see that all hardware and parts are present prior to start of assembly.
3. Please follow attached instructions in the same sequence as numbered to assure fast & easy assembly.



## Warning!

1. Don't attempt to repair or modify parts that are broken or defective. Please contact the store immediately.
2. This product is for home use only and not intended for commercial establishments.

## PARTS IDENTIFICATION :

A) TOP RAME - 1PC

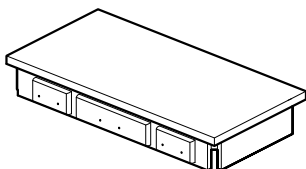

B) RIGHT FRONT LEG - 1PC



C) RIGHT REAR LEG - 1PC



D) LEFT TABLE LEG - 2PCS

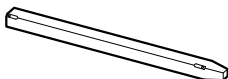

E) BOTTOM FRAME - 1PC

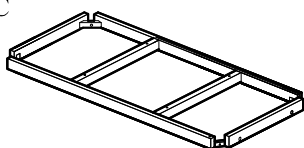

F) RIGHT DIVIDER - 1PC

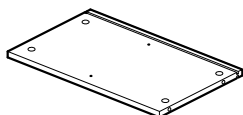

G) LEFT DIVIDER - 1PC

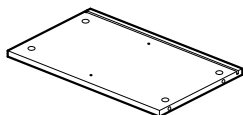

H) GLASS HOLDER - 1PC

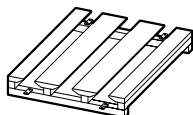

I) BACK PANEL - 2PCS

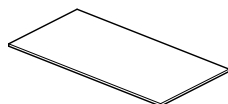

## PARTS IDENTIFICATION :

J) SIDE PANEL - 1PC

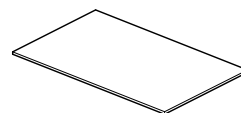

K) DOOR - 1PC

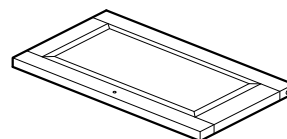

L) BRACKET - 2PCS



M) ROD - 1PC

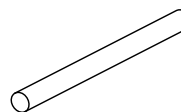

N) LEFT AND RIGHT TOP SHELF PANEL - 2PCS

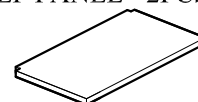

O) LEFT AND RIGHT BOTTOM SHELF PANEL - 2PCS

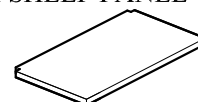

P) CENTER TOP SHELF PANEL - 1PC

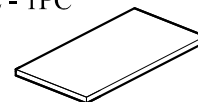

Q) CENTER BOTTOM SHELF PANEL - 1PC



R) WINE RACK PANEL - 2PCS

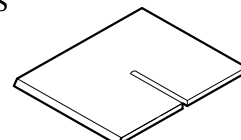

ASSEMBLY TIPS:

- 1. Remove hardware from box and sort by size.
- 2. Please check to see that all hardware and parts are present prior to start of assembly.
- 3. Please follow attached instructions in the same sequence as numbered to assure fast & easy assembly.



Warning!

- 1. Don't attempt to repair or modify parts that are broken or defective. Please contact the store immediately.
- 2. This product is for home use only and not intended for commercial establishments.

HARDWARE IDENTIFICATION :

1.LONG BOLT - 4PCS

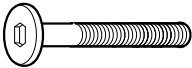

2.SHORT BOLT - 4PCS

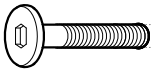

3. LOCK WASHER - 10PCS



4. FLAT WASHER - 10PCS



5. CAM BOLT - 8PCS

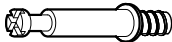

6. CAM NUT - 8PCS



7. SHELF SUPPORT - 12PCS

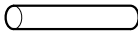

8. PULL - 4PCS



9. PULL SCREW - 8PCS

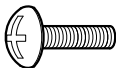

HARDWARE IDENTIFICATION :

10. MAGNETIC CATCH -1PC

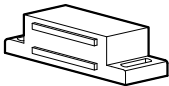

11. FLAT HEAD SCREW - 6PCS

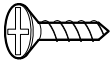

12. PLASTIC DOOR SPRING - 2PCS

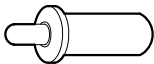

13. MEDIUM BOLT - 2PCS

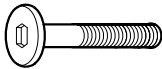

14. ALLEN WRENCH - 1PC



## STEP 1

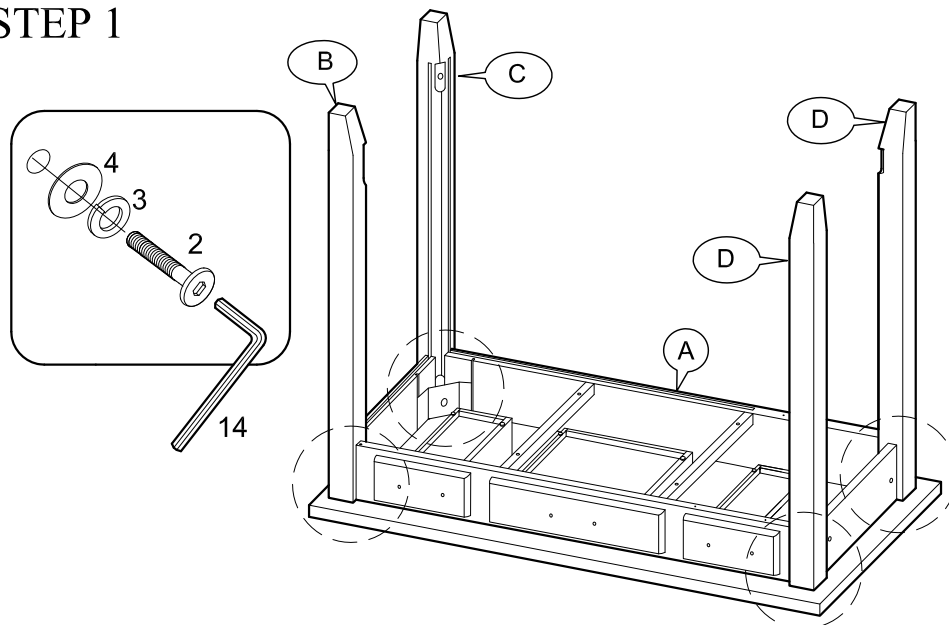

Place the top frame upside down on soft surface. Align and fasten left, right front and right rear legs to top frame using short bolt, lock washer and flat washer and tighten with Allen wrench.

## STEP 2

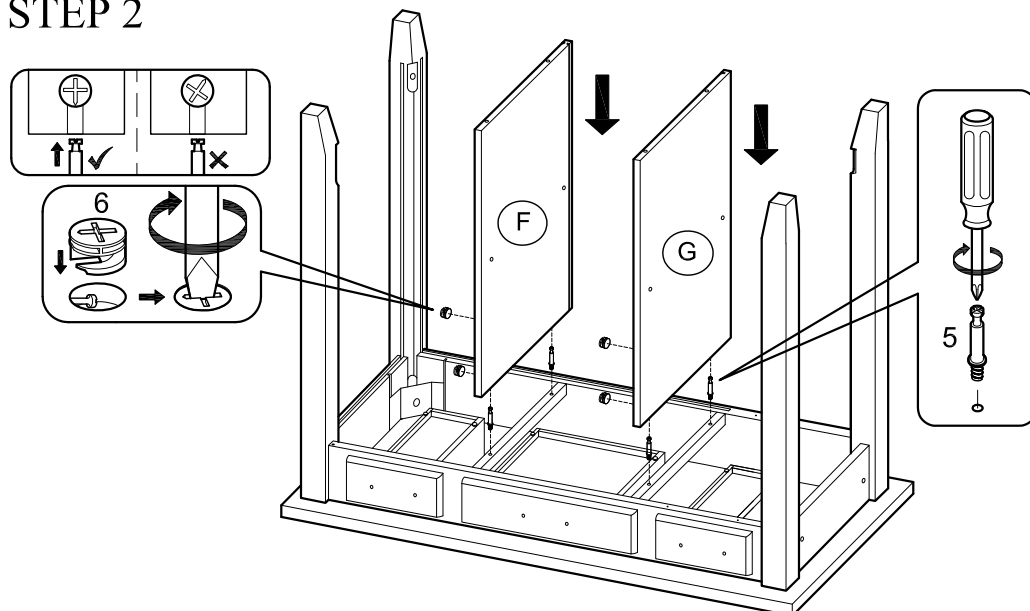

Screw in cam bolt to top frame using screw driver (Not Included) as shown in the diagram. Align the cam bolt with pre-drilled holes on left and right divider then insert cam nut into pre-drilled holes on the left and right divider and tighten with screw driver (Not Included) as shown in the diagram.

## STEP 3

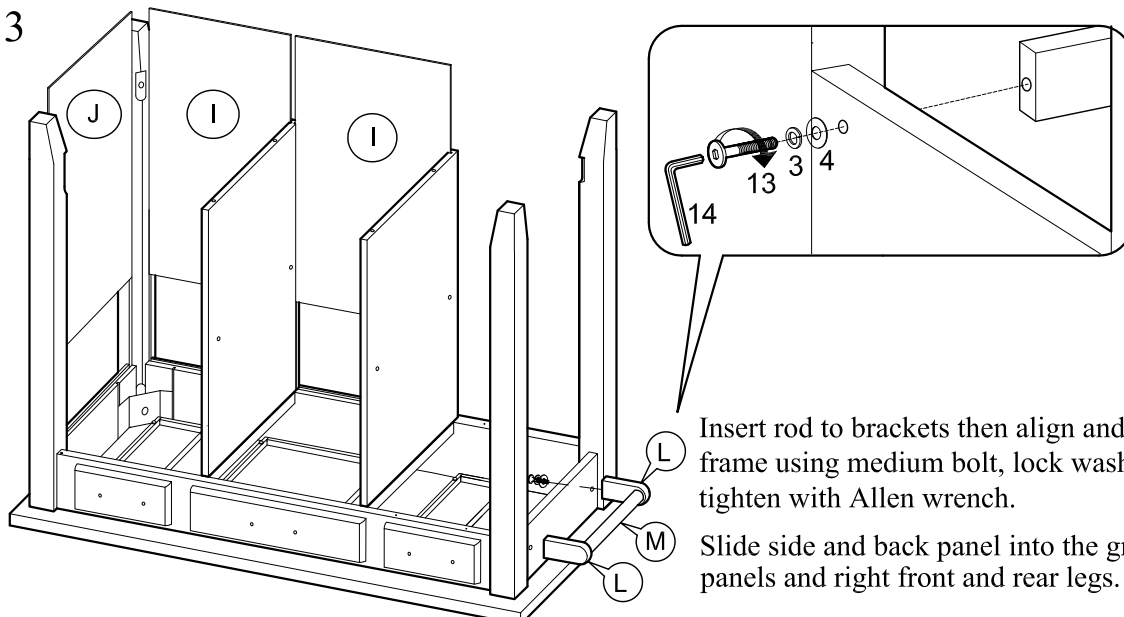

Insert rod to brackets then align and fasten brackets to top frame using medium bolt, lock washer and flat washer and tighten with Allen wrench.

Slide side and back panel into the groove on left and right panels and right front and rear legs.

**STEP 4**

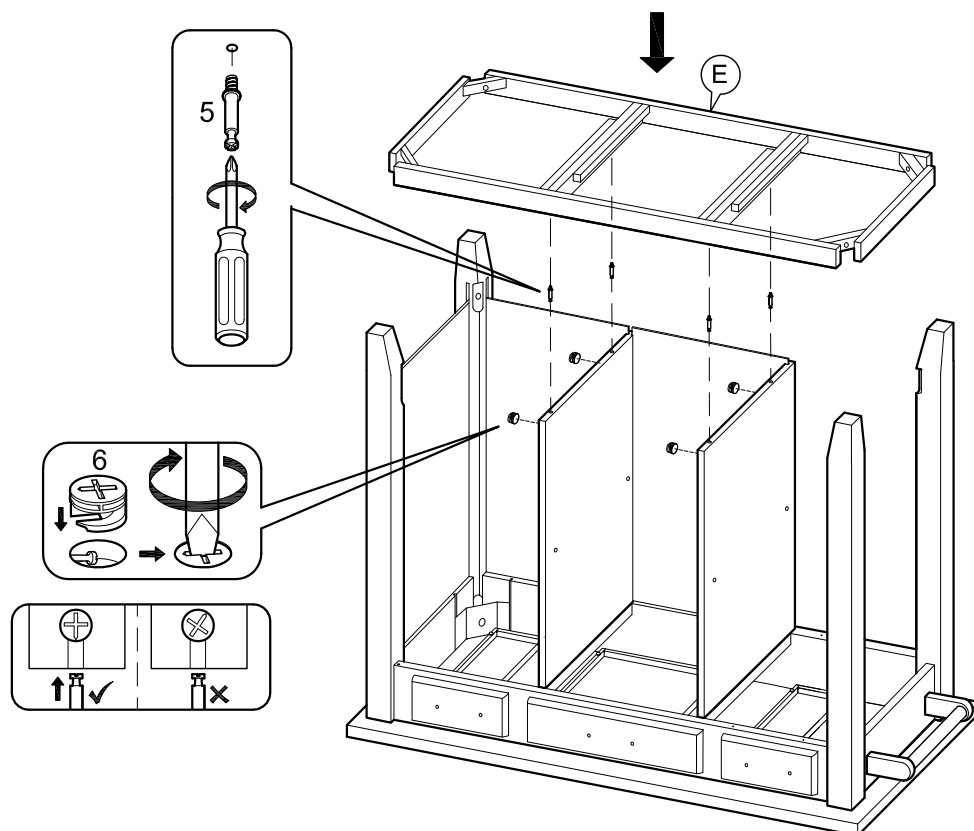

Screw in cam bolt to bottom frame using screw driver (Not Included).

Align cam bolt on bottom frame with pre-drilled hole on left and right divider then insert cam nut into pre-drilled holes on left and right divider and tighten with screw driver (Not Included) as shown in the diagram .

**STEP 5**

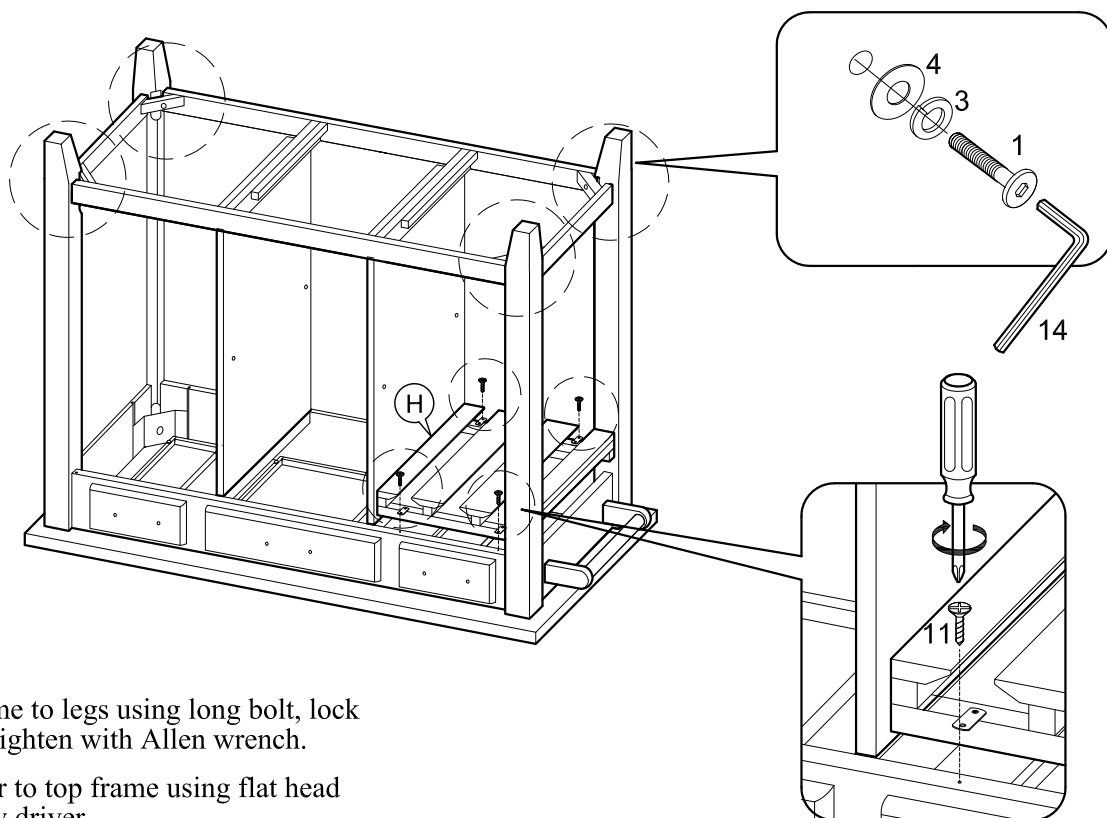

Align and fasten bottom frame to legs using long bolt, lock washer and flat washer and tighten with Allen wrench.

Align and fasten glass holder to top frame using flat head screw and tighten with screw driver.

**STEP 6**

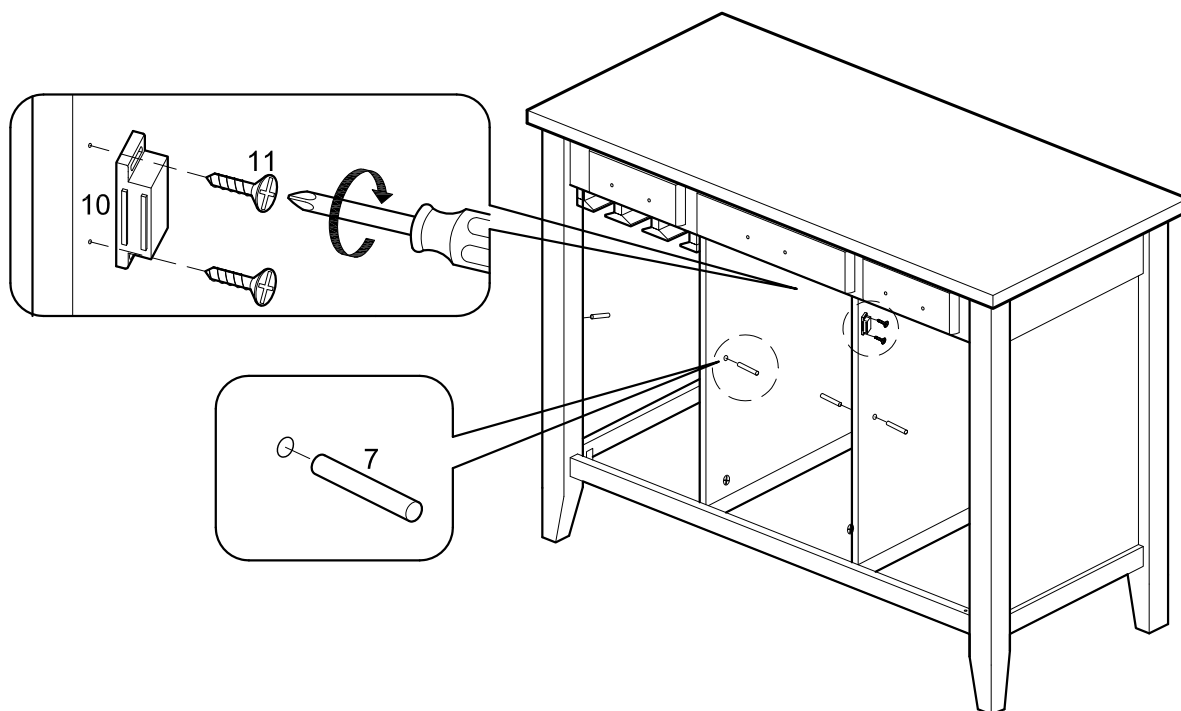

Align and fasten magnetic catch to right divider using flat head screw. Insert shelf support to left and right divider and left legs.

**STEP 7**

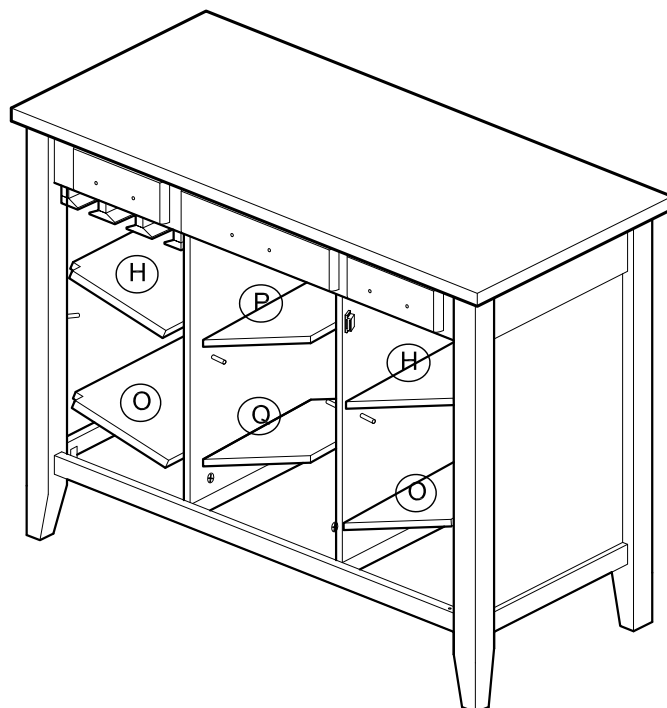

Place all the shelves onto shelf support as shown in the diagram.

**STEP 8**

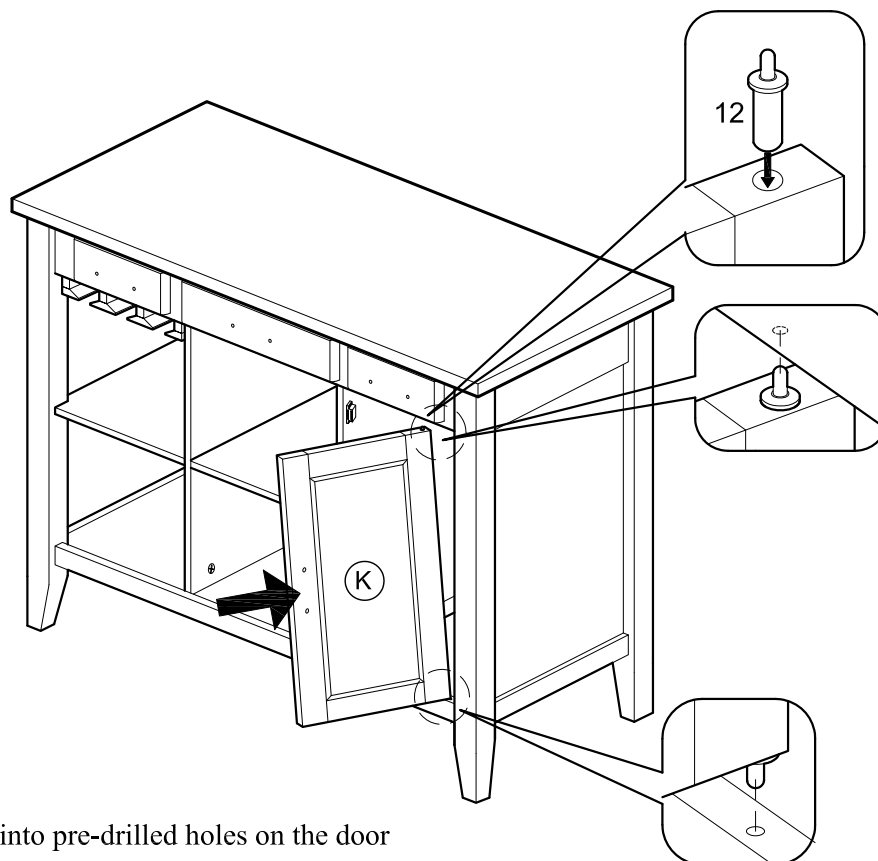

Insert plastic door spring into pre-drilled holes on the door then into the pre-drilled holes on top and bottom frame.

**STEP 9**

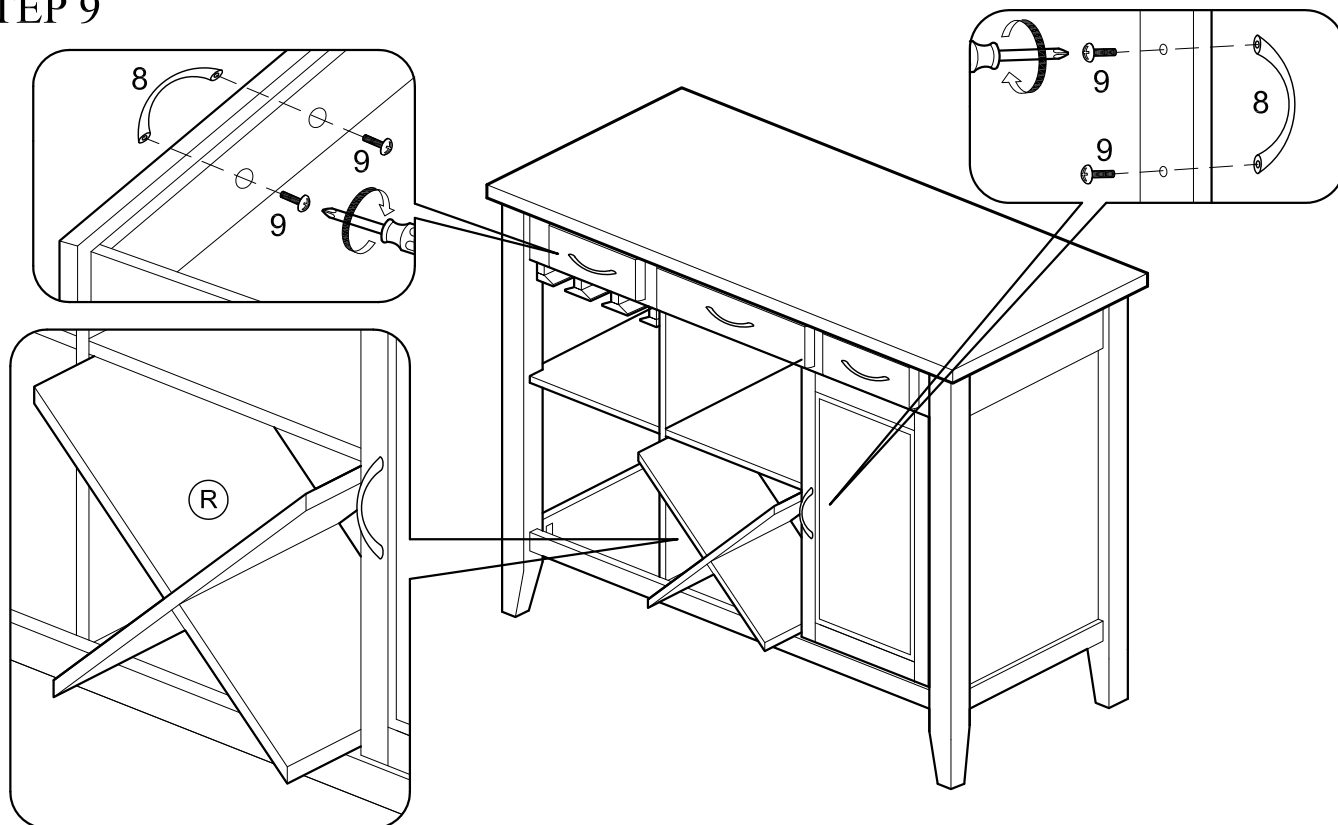

Align and fasten pull to drawer and door using pull screw.  
Assemble the wine rack panels together then place into the server as shown.