

# ASSEMBLY GUIDE

Model : 5351-24BH

**PART**

- 01 CUSHION SEAT
- 02 LEG
- 03 LONG STRETCHER
- 04 SHORT STRETCHER

We suggest that you spend a short time reading through this leaflet and the follow the simple step by step instructions.

Do not throw away any of the packaging until you have checked that you have all the component parts and fittings.

Please dispose of the packaging carefully once you have finished.

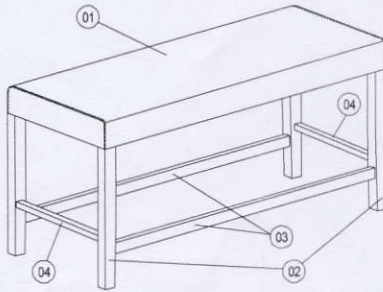

**\* NOTE \***

DO NOT TIGHTEN ALL THE SCREWS UNTIL THE CHAIR HAS BEEN PUT ON A FLAT SURFACE TO ADJUST & LEVEL ALL THE LEGS SO THAN THEY DO NOT WOBBLE ONCE ADJUSTER THEN TIGHTEN ALL THE SCREWS.

**HARDWARE LIST**

NO	DESCRIPTION		QTY
A	JCBC SCREW 55mm		8
B	FLAT WASHER		8
C	SPRING WASHER		8
D	SCREW M4 X 38mm		8
E	SHORT ALLEN KEY M4		1

**STEP -1**

Remove the Black woven on bottom of the box seat.

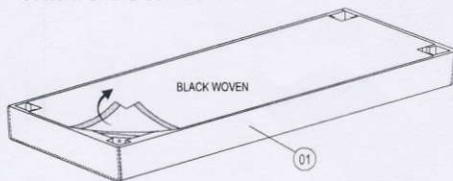

**STEP -2**

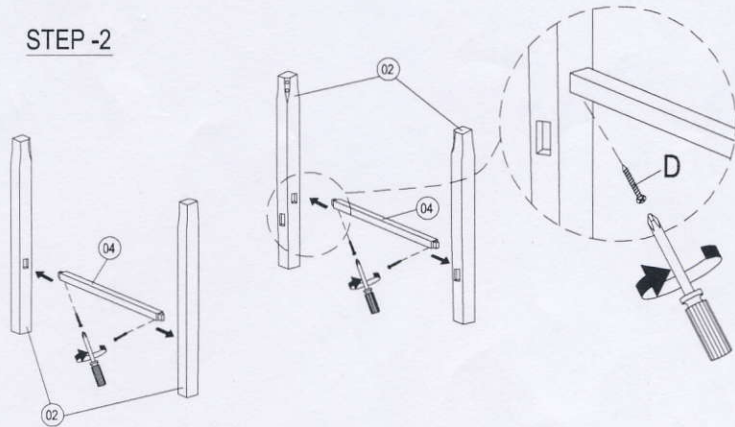

**STEP -3**

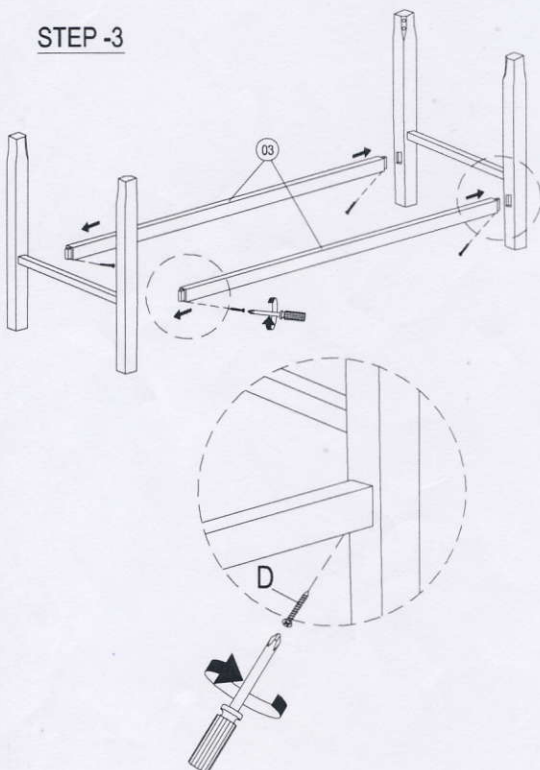

**STEP -4**

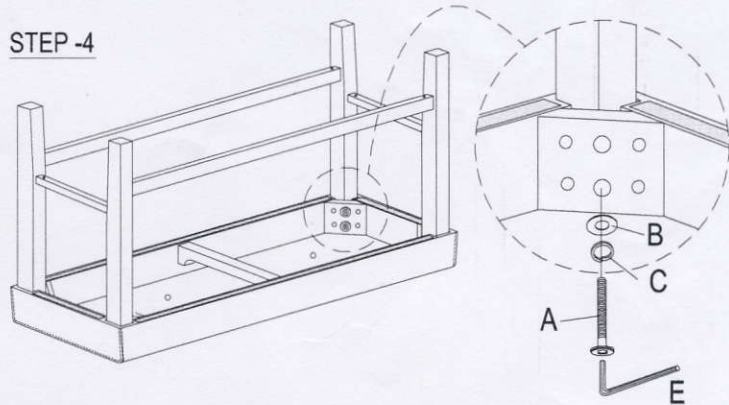

**STEP -5**

Lastly, cover back the black woven to the bottom of the box seat.

