

Zido brings all of the easy configurability you've come to expect from Anthro wrapped up in a sleek and compact design. Its weighted base balances loads mounted as high as 66". Shelves are wrapped in contoured laminate which can withstand a wide range of chemicals. It's perfect for Healthcare, Labs and General Office.

PRODUCT SPECIFICATIONS

Shelves: 1" thick medium-density fiberboard shelves are wrapped in a highly durable thermoplastic laminate to resist cracking and stand up to a wide range of chemicals.

Column & Base: Column is a 2.5" diameter steel tube with a baked-on, powder coat finish. Heavy cast metal base provides stability on a compact footprint.

Casters: Soft rubber, black, twin-wheel 4" casters; front 2 locking.

Warranty: The carts are covered by a Lifetime Warranty against manufacturing defects. The gas cylinder on the Adjustable-Height and Phlebotomy Cart is covered by a Five Year Warranty.

Colors: Available in two color combinations: Cool Grey (CG) metal with Cool Grey (CG) laminate; Slate Blue (SB) metal with Cool Grey (CG) laminate.



As a mobile workstation, Kim's Zido Adjustable-height puts her in control of where she works and how she works, standing or sitting.

ZIDO WORKSTATIONS

ZIDO ADJUSTABLE-HEIGHT



- Work comfortably sitting or standing, with a height range of 30"-40".
- Comes with wood cap shelf, cap shelf bracket, 2.5" diameter adjustable-height column with holes in 1" increments for accessory installation, rubber column cover, heavy cast metal base, and 4 casters (4" size, 2 locking).
- Choose from 2 widths (22" and 25") and 2 lift capacities (Standard or Super). Standard carts lift 16-30 lbs.; the Super cart lifts 27-41 lb. These capacities are based on the weight of the items on the cap shelf. Include the weight of accessories when calculating the load on the column. Lighter loads will be harder to push down; heavier loads will be harder to pull up. These weight ranges are estimates only.
- Overall weight capacity of 150 lbs. The cap shelf has a weight capacity of 50 lbs., though the column lifts less (see above).
- Available in two color combinations: Cool Grey metal and laminate (CG/CG) or Slate Blue metal with Cool Grey laminate (SB/CG).

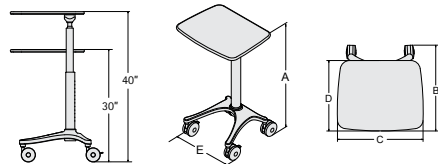

PRODUCT	Height (A)	Overall Depth (B)	Overall Width (C)	Shelf Depth (D)	Base Width (E)	Weight	Part #	Price
Standard 22"	30-40"	22.25"	22"	17"	17"	50 lbs.	ZAL22zz/xx4	\$599
Standard 25"	30-40"	25.75"	25"	20.5"	21"	63 lbs.	ZAL25zz/xx4	\$669
Super 25"	30-40"	25.75"	25"	20.5"	21"	63 lbs.	ZAH25zz/xx4	\$729

 QuickShip available for Standard 22" Zido Adjustable-Height workstations only.

ZIDO ADJUSTABLE-HEIGHT WITH LIP SHELF



- It's the exact same cart as the Zido Adjustable-height above, but with a 1/2" wide lip around the perimeter of the cap shelf to keep items from rolling off!
- Choose from 2 widths (22" and 25") and 2 lift capacities (Standard or Super). Standard carts lift 16-30 lbs.; the Super cart lifts 27-41 lb. These capacities are based on the weight of the items on the cap shelf. Include the weight of accessories when calculating the load on the column. Lighter loads will be harder to push down; heavier loads will be harder to pull up. These weight ranges are estimates only.
- Overall weight capacity of 150 lbs. The cap shelf has a weight capacity of 50 lbs., though the column lifts less (see above).
- Available in two color combinations: Cool Grey metal and laminate (CG/CG) or Slate Blue metal with Cool Grey laminate (SB/CG).

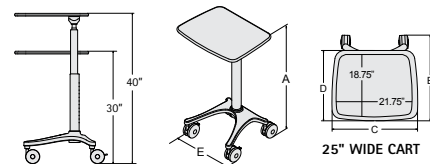

PRODUCT	Height (A)	Overall Depth (B)	Overall Width (C)	Shelf Depth (D)	Base Width (E)	Weight	Part #	Price
Standard 22"	30-40"	22.25"	22"	17"	17"	50 lbs.	ZLL22zz/xx4	\$629
Standard 25"	30-40"	25.75"	25"	20.5"	21"	63 lbs.	ZLL25zz/xx4	\$699
Super 25"	30-40"	25.75"	25"	20.5"	21"	63 lbs.	ZLH25zz/xx4	\$739

That's the expression used most often by customers when they comment on Anthro. Our products undergo ANSI-BIFMA torture tests, so they will absolutely stand up to the rigors of hard use.

ZIDO FIXED-HEIGHT

- Comes with wood cap shelf, cap shelf bracket, 2.5" diameter column with holes in 1" increments for accessory installation, heavy cast metal base, and 4 casters (4" size, 2 locking).
- Choose from 2 widths (22" and 25") and 3 heights (31", 35", and 40").
- Overall weight capacity of 150 lbs. The cap shelf has a weight capacity of 50 lbs.
- Available in two color combinations: Cool Grey metal and laminate (CG/CG) or Slate Blue metal with Cool Grey laminate (SB/CG).

PRODUCT	Height (A)	Overall Depth (B)	Overall Width (C)	Shelf Depth (D)	Base Width (E)	Weight	Part #	Price
22"w, 31"h	31"	22.25"	22"	17"	17"	44 lbs.	ZD2231zz/xx4	\$449
22"w, 35"h	35"	22.25"	22"	17"	17"	45 lbs.	ZD2235zz/xx4	\$469
22"w, 40"h	40"	22.25"	22"	17"	17"	46 lbs.	ZD2240zz/xx4	\$489
25"w, 31"h	31"	25.75"	25"	20.5"	21"	57 lbs.	ZD2531zz/xx4	\$499
25"w, 35"h	35"	25.75"	25"	20.5"	21"	58 lbs.	ZD2535zz/xx4	\$529
25"w, 40"h	40"	25.75"	25"	20.5"	21"	59 lbs.	ZD2540zz/xx4	\$549

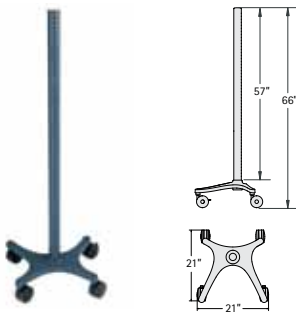

QuickShip available for 25"w, 35"h Zido Fixed-Height workstations only.

ZIDO POLE CART

- The 66" high all-metal Pole Cart provides a strong, tall, single column to support all the accessories you need. The heavy cast metal base provides added stability for all your equipment.
- Comes with 2.5" diameter column with holes in 1" increments for accessory installation, heavy metal cast base, and 4 casters (4" size, 2 locking).
- Overall weight capacity of 150 lbs.
- Available in Slate Blue (SB) or Cool Grey (CG).

PRODUCT	Weight	Part #	Price
Zido Pole Cart	44 lbs.	ZD2166zz4	\$379

ZIDO PACKAGES

To make ordering Zido carts a little easier, we've configured popular combinations of Zido carts and accessories that are targeted to specific healthcare applications. But feel free to think outside the box and use these packages wherever they fit your needs! (After all, sometimes a cart with a handle is just a cart with a handle.) Available in SB/CG and SB/PW color combinations.

ZIDO EHR CART PACKAGE

- Comes with a 22" wide Adjustable-height Zido cart with Lipped Shelf (part ZLL224) and Handle (part ZH).
- Ships in two boxes.

PRODUCT	Weight	Part #	Price
Zido EHR Cart Package	56 lbs.	BZD01zz/xx4	\$669

ZIDO ULTRASOUND CART PACKAGE

- Comes with a 22" wide Adjustable-height Zido cart with Lipped Shelf (part ZLL22zz/xx4), Handle (part ZH), Large Probe Holder (part ZGCL), and Metal Bin (part ZMB).
- Ships in four boxes.

PRODUCT	Weight	Part #	Price
Zido Ultrasound Cart Package	67 lbs.	BZD02zz/xx4	\$799

COLOR CHOICES

Select your product colors from the following swatches. Replace "zz" with a 2-letter Metal Code and "xx" with a 2-letter Laminate Code.

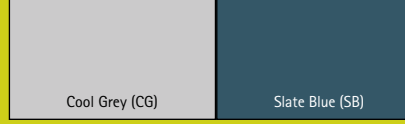

Metal Colors (zz)

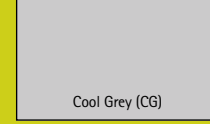

Laminate Color (xx)

ZIDO EKG CART PACKAGE



- Comes with a 22" wide Adjustable-height Zido cart with Lipped Shelf (part ZLL22), Handle (part ZH), Side Bin (part ZSB), and Metal Bin (part ZMB).
- Ships in four boxes.

PRODUCT	Weight	Part #	Price
Zido EKG Cart Package	72 lbs.	BZD03zz/xx4	\$809

ZIDO PHLEBOTOMY CART I PACKAGE



- Comes with a 22" wide Adjustable-height Zido cart with Lipped Shelf (part ZLL224), Handle (part ZH), Deep Drawer (part ZDD), Glove Box Holder (part ZGB), and Medium Equipment Shelf (part ZESM).
- Ships in two boxes.
- Available in SB/CG only.

PRODUCT	Weight	Part #	Price
Zido Phlebotomy Cart I Package	83 lbs.	ZPHLEBzz/xx4	\$1029

ZIDO PHLEBOTOMY CART II PACKAGE



- Comes with a 22" wide Adjustable-height Zido cart with Lipped Shelf (part ZLL22SB/CG4), Handle (part ZHSB), Deep Drawer (part ZDD), Glove Box Holder (part ZGB), and Metal Bin (part ZMB).
- Ships in two boxes.

PRODUCT	Weight	Part #	Price
Zido Phlebotomy Cart II Package	85 lbs.	BZD04zz/xx4	\$999

ZIDO SMALL FORM-FACTOR COMPUTER CART PACKAGE



- Comes with a 22" wide Adjustable-height Zido cart with Standard Shelf (part ZAL22), Handle (part ZH), Extension Tube (ZET26) and Single Monitor Mount (ZPMS) to hold the monitor, Keyboard Drawer (ZKD20), Mouse Holder (ZMH), CPU SideRack for Small Form-factor (ZSF), and Equipment Shelf Medium (ZESM).
- Ships in eight boxes.

PRODUCT	Weight	Part #	Price
Zido Small Form-factor Computer Cart Package	92 lbs.	BZD05zz/xx4	\$1289

ZIDO COMPUTER CART PACKAGE



- Comes with 25" wide 40" high Zido Cart with standard shelf (part ZD2540), Handle (part ZH), Extension Tube (ZET26) and Single Monitor Mount (ZPMS) to hold monitor, Cable Bin (ZCB), and Equipment Shelf Medium (ZESM).
- Ships in six boxes.

PRODUCT	Weight	Part #	Price
Zido Computer Cart Package	91 lbs.	BZD06zz/xx4	\$1049



ZIDO ACCESSORIES

BINS

Cable Bin

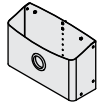

- Attaches to the back of the column with 3 fasteners.
- Comes with 2 grommets pass-throughs (2.25" diameter), 1 on the front and 1 on the bottom. Comes with four 8" long cable ties. Install the Surge Protector (see Zido: Accessories) for added convenience.
- Available in Cool Grey (CG) or Slate Blue (SB).

PRODUCT	Width	Depth	Height	Weight	Part #	Price
Cable Bin	14.5"	5.25"	9.5"	9 lbs.	ZCBzz	\$94.95

Metal Bin

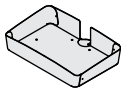

- Attaches to the front of the column with 3 screws.
- Available in Slate Blue bracket with Cool Grey body (SB/CG).

PRODUCT	Width	Depth	Height	Weight	Part #	Price
Metal Bin	18"	11"	3"	10 lbs.	ZMBzz/xx	\$99.95

Side Bin

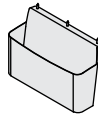

- Installs on any wood shelf and extends 8" below the shelf. Measures 12" w x 5.75" h. Tapers from 3.25" top depth to 2.25" bottom depth.
- Available in Cool Grey (CG) or Slate Blue (SB).
- Drill required for installation. **F**

PRODUCT	Width	Depth	Height	Weight	Part #	Price
Side Bin	12"	2.25"	5.75"	6 lbs.	ZSBzz	\$69.95

CPU SIDERACKS

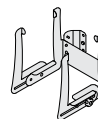

CPU SIDERACK

CPU SideRack

- Attach your CPU to the column of your Zido with these strong, convenient SideRacks.
- Holds CPUs 3"-7.5" wide; arms extend 9" up the side of your CPU.
- Installs on your Zido where the column meets the base, for extra stability and security in even the most mobile applications.
- When installed on a Zido Adjustable-height cart, the maximum CPU height is 16" if installed on the same side as the lever; 18" if installed on the opposite side. On a Zido 31" Fixed-height cart, the maximum CPU height is 20".
- Holds up to 40 lbs.
- Available in Cool Grey (CG) or Slate Blue (SB).

CPU SIDERACK -
SMALL FORM FACTOR

CPU SideRack - Small Form Factor

- Adjusts 2.75"-4.25" wide, this smallest CPU holder attaches to the back of your Zido at the base.
- Holds up to 25 lbs.
- Available in Cool Grey (CG) or Slate Blue (SB).

PRODUCT	Depth	Height	Weight	Part #	Price
CPU SideRack, Standard	11.25"	11"	12 lbs.	ZSRzz	\$189.95
CPU SideRack, Small Form Factor	7"	6.75"	5 lbs.	ZSFzz	\$79.95

CABLE MANAGEMENT HOOKS



- Manage cords and cables with this pair of strong plastic hooks. Install at any height along the back of the column.
- Available in Cool Grey (CG).

PRODUCT	Weight	Part #	Price
Cable Management Hooks (set of 2)	1 lb.	ZHKCG	\$14.95

COLOR CHOICES

Select your product colors from the following swatches. Replace "zz" with a 2-letter Metal Code and "xx" with a 2-letter Laminate Code.

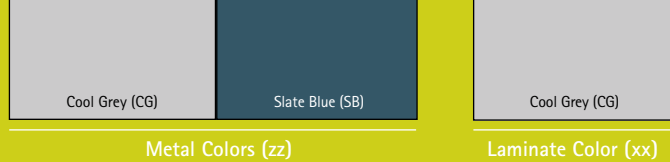

Metal Colors (zz)

Laminate Color (xx)

DRAWER SOLUTIONS

Drawers

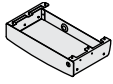

STANDARD

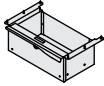

DEEP

- Add secure storage to your Zido cart with these locking drawers. They attach under a cap shelf or a large additional shelf with 6 screws. Choose from Standard (4.5" high) or Deep (6" high).
- The Standard Drawer's interior measurements are 19"w x 10"d x 3"h. The back features a grommeted cord pass-through for power and network cables.
- The Deep Drawer's interior measurements are 14.75"w x 8.75"d x 5.75"h.
- Available in two color options: Cool Grey (CG) drawer body with Slate Blue (SB) frame, or Cool Grey (CG) frame.

PRODUCT	Weight Capacity	Locking	Width	Depth	Height	Weight	Part #	Price
Drawer - Standard	15 lbs.	Yes	20.5"	11.25"	4.5"	13 lbs.	ZDRxx	\$169.95
Drawer - Deep	15 lbs.	Yes	16"	10"	6.5"	16 lbs.	ZDDzz/xx	\$199.95

⚠ Drawers do not work with Small or Medium Additional Shelves.

Drawer Enclosure

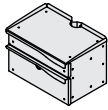

- This enclosure's locking drawers store equipment, supplies, and documents safely and securely.
- Attaches to the front of the column with two large wraparound brackets.
- The 2-drawer Enclosure features a small upper drawer (interior measurements 14.75"w x 8.75"d x 2.75"h) and large lower drawer (interior measurements 14.75"w x 8.75"d x 5.75"h). The top surface measures 16.5"w x 11.25"d. The unit holds up to 50 lbs. overall: 10 lbs. in the small drawer, 15 lbs. in the large drawer and 25 lbs. on the top.
- It's available in a Cool Grey (CG) drawer body with a Slate Blue (SB) frame, or Cool Grey (CG) frame.

PRODUCT	Width	Depth	Height	Weight	Part #	Price
2-drawer Enclosure	16.5"	11.25"	11"	35 lbs.	ZDE02zz/xx	\$389.95

EXTENSION TUBE

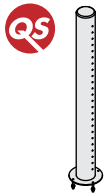

- The 2.5" diameter tube adds an extra 26" in height above the cap shelf.
- Comes with holes in 1" increments for adding a Flat Panel Mount (sold separately, below) and other accessories.
- Available in Cool Grey (CG), Silver Satin (SS), or Slate Blue (SB).
- Install by drilling through the shelf and securing to the cap shelf bracket with four bolts. Drill required for installation. 🔩

PRODUCT	Weight	Part #	Price
Extension Tube	5 lbs.	ZET26zz	\$89.95

⚠ Does not work with Zido Pole Cart.

FLAT PANEL MONITOR SOLUTIONS

Lots of choices for your flat panel monitor! Pick the features you need. **Note: all mounting options conform to VESA 75mm and 100mm mounting standards.** If you need a different standard or would like to discuss additional monitor solutions that we have available, give us a call.

Flat Panel Mounts (Single or Dual)



SINGLE MOUNT

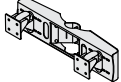

DUAL MOUNT

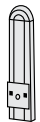

FLAT PANEL HEIGHT ADJUSTER

- Install on the Extension Tube or Zido Pole Cart putting monitors at your desired viewing height.
- Swivel heads adjust the monitor angle.
- Dual Mount includes concealed cable management and variable monitor installation points; holds 2 monitors up to 20" wide.
- Weight capacity of the Single Mount is 22 lbs. Weight capacity of the Dual Mount is 44 lbs. (22 lbs. per mount).
- Add an extra 9" of height adjustment with the Flat Panel Height Adjuster. Works with Single Flat Panel Mount only. Holds up to 22 lbs.
- Flat Panel Height Adjuster comes with 15-year warranty against manufacturing defects.
- Available in Slate Blue (SB) or Cool Grey (CG).

Product	Weight	Part #	Price
Single Flat Panel Mount	5 lbs.	ZPMSzz	\$159.95
Dual Flat Panel Mount	17 lbs.	ZPMDzz	\$319.95
Flat Panel Height Adjuster - Universal	4 lbs.	765SM	\$129.95

⚡ QuickShip available for Single Flat Panel Mount only.



Flat Panel Monitor Mount

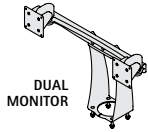

- Available in Cool Grey (CG).
- Secure your monitor to your cart with this metal swivel-head mount on 13" h stand. Mount base is 4.5"w x 4.5"d.
- Choose single or dual-monitor versions. The single-monitor version supports up to 22 lbs. The dual version supports a total of 22 lbs. and two monitors up to 17" across.
- Install by drilling through the shelf and securing with four bolts. Drill required for installation.

PRODUCT	Weight	Part #	Price
Single Monitor	7 lbs.	615CG	\$219.95
Dual Monitor	12 lbs.	617CG	\$319.95

QuickShip available for Single Monitor only.

GLOVE BOX HOLDER

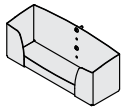

- Attaches to the back of the column at any height using 2 screws.
- Available in Cool Grey (CG) or Slate Blue (SB).

PRODUCT	Width	Depth	Height	Weight	Part #	Price
Glove Box Holder	11.5"	3.5"	4.5"	3 lbs.	ZGBzz	\$45.95

HANDLES



- Cast aluminum handles help you easily steer your Zido right where it's needed!
- Standard version (17" wide) attaches to the cap shelf with 4 screws. Pole Cart version attaches to the column or extension tube with 4 screws. The 8" wide version attaches to the pole cart column or extension tube with a 2-piece bracket.
- Available in Slate Blue (SB).

PRODUCT	Weight	Part #	Price
Standard Handle (for Zido Fixed-height and Adjustable-height)	4 lbs.	ZHzz	\$59.95
Handle for Zido Pole Cart	7 lbs.	ZPHzz	\$129.95
8" wide Handle	4 lbs.	ZHHSB	\$64.95

QuickShip available for Standard Handle only.

KEYBOARD SOLUTIONS

Whether you're looking for ergonomics or just convenience, finding the right Keyboard Solution can make a world of difference in your workstation. And we offer lots of choices. Sometimes the differences between the caddies are subtle, so feel free to call us to find the right solution for you.

Keyboard Drawer

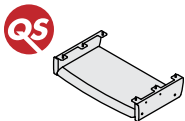

- Wood surface slides in and out on full-extension glides and extends 3.5" below the shelf.
- Installs underneath a cap shelf or large additional shelf with 6 screws.
- Available in Cool Grey metal and laminate (CG/CG) or Slate Blue metal with Cool Grey laminate (SB/CG).
- Drill required for installation.

PRODUCT	Width	Depth	Weight	Part #	Price
Keyboard Drawer	19"	11"	12 lbs.	ZKD20zz	\$159.95

Does not work with Small or Medium Additional Shelves.

COLOR CHOICES

Select your product colors from the following swatches. Replace "zz" with a 2-letter Metal Code and "xx" with a 2-letter Laminate Code.



Metal Colors (zz)

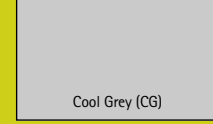

Laminate Color (xx)

Keyboard and Mouse Caddy, Style D – Compact

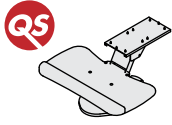

- Caddy moves in and out, up and down, tilts 10° positive and 20° negative, and swivels 360°. Movement ranges from even with your work surface to 6" below.
- Swing-out mouse surface pivots out when it's needed and hides away when it's not.
- Made of steel and phenolic with an integrated foam wrist rest.
- Surfaces are neutral granite color.
- Attaches with 10 screws and requires 11" mounting depth. When retracted the caddy will extend 4" from the front of the shelf. Drill required for installation.

PRODUCT	Width	Weight	Part #	Price
Keyboard and Mouse Caddy, Style D	19.5"	11 lb.	169BK	\$229.95

Only works with 25" wide Zido carts and Large Additional Shelves.

MOUSE SOLUTIONS

Mouse Holder

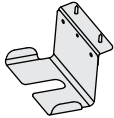

- Available in Cool Grey (CG), or Slate Blue (SB).
- Attaches to the side of the Keyboard Drawer or underneath the cap shelf with 2 screws. Drill required for installation.
- Mounting bracket is 5" wide and 1" deep and attaches to any wood surface with two wood screws. Extends 5" below the wood surface.

PRODUCT	Weight	Part #	Price
Mouse Holder	2 lbs.	ZMHzz	\$39.95

Mouse Shelf – Swing-out



- Made of heavy-duty phenolic in neutral granite finish.
- Attaches to wood surfaces with 4 screws. Drill required for installation.

PRODUCT	Width	Depth	Weight	Part #	Price
Mouse Shelf – Swing-out	8"	9"	2 lbs.	687BK	\$69.95

PROBE HOLDERS

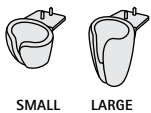

- Cups come in grey with light green accent. Brackets available in Cool Grey (CG).
- Brackets measure 1.5" wide x 2.5" deep and attach to the bottom of any wood surface with 2 screws. Cushioned cups snap into place. Drill required for installation.

PRODUCT	Width	Depth	Height	Weight	Part #	Price
Probe Holder, Small	2.5"	3.5"	2.5"	1 lb.	ZGCSzz	\$44.95
Probe Holder, Large	2.5"	3.5"	4.5"	1 lb.	ZGCLzz	\$49.95

QuickShip available for Large Probe Holder only.

SCANNER BRACKET



- Keep your barcode scanner right at hand with this metal bracket. Inside opening on bracket is 1.5"w x 2"d.
- Available in Slate Blue (SB).
- Installs on any wood surface with two screws. Drill required for installation.

PRODUCT	Weight	Part #	Price
Scanner Bracket	1 lb.	886zz	\$34.95

SECURITY CABLE, 36"



- Protect laptops and hard drives from theft. Using an adapter, the lock attaches to the back of your laptop or hard drive and the cable loops around the column or brackets.
- Comes with the cable, lock, and two keys.

PRODUCT	Length	Weight	Part #	Price
Security Cable, 36"	36"	2 lbs.	960SM	\$99.99*

That's the expression used most often by customers when they comment on Anthro. Our products undergo ANSI-BIFMA torture tests, so they will absolutely stand up to the rigors of hard use.

SHELVES

Additional Shelf

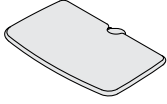

- Wood shelves attach to the column with 3 screws and hold 50 lbs.
- Available in Slate Blue bracket with Cool Grey laminate (SB/CG).

PRODUCT	Width	Depth	Weight	Part #	Price
Small Additional Shelf	17"	10"	7 lbs.	ZADSzz/xx	\$119.95
Medium Additional Shelf	22"	13"	10 lbs.	ZADMzz/xx	\$149.95
Large Additional Shelf	25"	16.5"	13 lbs.	ZADLzz/xx	\$199.95

Base Storage Shelf

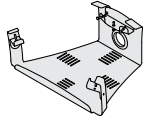

- Clamps onto the base of only the 25" wide Zido carts and Pole Cart, comes with a Strap & Buckle Kit, and has a weight capacity of 50 lbs.
- Available in Cool Grey (CG), Silver Satin (SS), or Slate Blue (SB) with textured finish.

PRODUCT	Width	Depth	Height	Weight	Part #	Price
Base Storage Shelf (interior dims)	9.5"	12.5"	4.5"	14 lbs.	ZBSSzz	\$179.95

Does not work with 22" wide Zido Carts.

Equipment Shelf

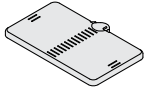

- Attaches to the vertical tube with 3 screws, comes with a Strap & Buckle Kit, and has a weight capacity of 50 lbs.
- Available in Slate Blue bracket with Cool Grey shelf (SB/CG).

PRODUCT	Width	Depth	Weight	Part #	Price
Small Equipment Shelf	16"	9"	7 lbs.	ZESSzz/xx	\$109.95
Medium Equipment Shelf	19"	11"	9 lbs.	ZESMzz/xx	\$149.95
Large Equipment Shelf	22"	13"	14 lbs.	ZESLzz/xx	\$179.95

QuickShip available for Small Equipment Shelf only.

STRAP & BUCKLE KIT

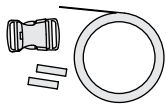

- Secure your equipment in place on any Equipment Shelf or Base Storage Shelf with this handy kit. Those shelves come standard with one kit; if you want more, buy this kit!
- Buckle and 6' strap are Black (BK). Ships unassembled.

PRODUCT	Weight	Part #	Price
Strap & Buckle Kit	1 lb.	ZSTRBK	\$29.95

SURGE PROTECTORS



STANDARD

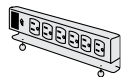

CLAMP-ON

- These UL-listed surge suppressors are 12" long, have 6 outlets and are rated at 15 amps, 120 Volts. Come with on/off switch, on/off indicator light, and circuit breaker reset button. Covered by one year warranty against manufacturing defects.
- Surge Protector - Standard comes in Black (BK) and mounts to the column, to a cable bin, or underneath a shelf with integrated mounting hardware. Drill required if attaching underneath a shelf.
- Surge Protector - Clamp-on comes in Black (BK) or Silver Metallic (SM) and mounts onto the edge of any shelf with two threaded knobs.

PRODUCT	Cord Length	Depth	Weight	Part #	Price
Surge Protector - Standard	15'	2.5"	2 lbs.	520BK	\$84.95
Surge Protector - Clamp-on	15'	2.5"	5 lbs.	BPSzz/BK	\$129.95