

## End Power Feed with LED Transformer

700MOPEND\_-LED

1.1



## GENERAL PRODUCT INFORMATION:



This product is suitable for dry locations only.

This product can be dimmed with a low-voltage electronic dimmer.

Minimum volume of the electrical box must be 6 cubic inches (98 cubic centimeter).

This product must be used with Tech Lighting MonoRail systems only.

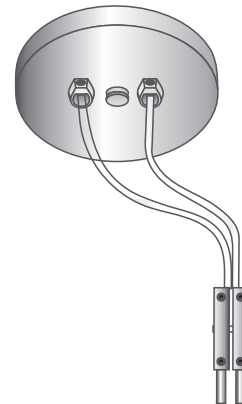

**WARNING:** Use only with low-voltage LED heads and pendants!

## Install the Transformer

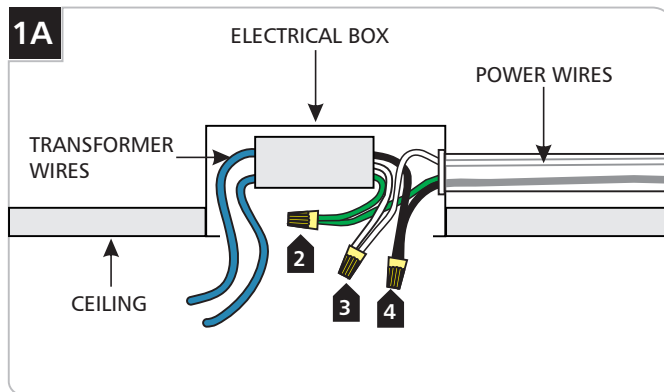

- 1 Turn the power to the electrical box off.
- 2 Connect the green transformer wire to a suitable ground in accordance with local electrical codes.
- 3 Connect the white transformer wire to the neutral power line wire with a wire nut.
- 4 Connect the black transformer wire to the hot power line wire with a wire nut.
- 5 Place the transformer and all the wires inside the electrical box. Use the adhesive pad to secure the transformer in the electrical box.

## Install the End Power Feed

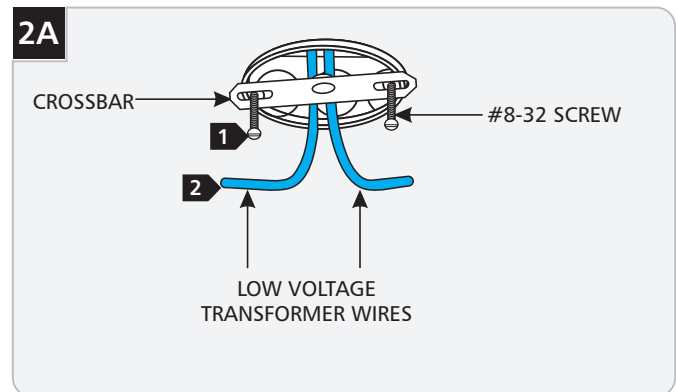

- 1 Mount the crossbar to the electrical box with the provided two #8-32 screws.
- 2 Pull the low voltage wires out of the electrical box.

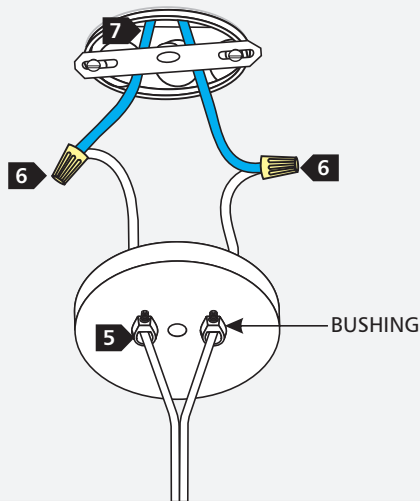
**2B**

- 3** Cut the end power feed wires to the desired length.
- 4** With a sharp knife cut 1" from the end of the wire web and separate the wires 8" from each other.
- 5** Push the power feed wires through the canopy bushings and slide the canopy down the wires.
- 6** Strip 1/2" off the wire ends and connect them to the electrical box low voltage wires with the provided wire nuts.
- 7** Place the wire nut connections into the electrical box.

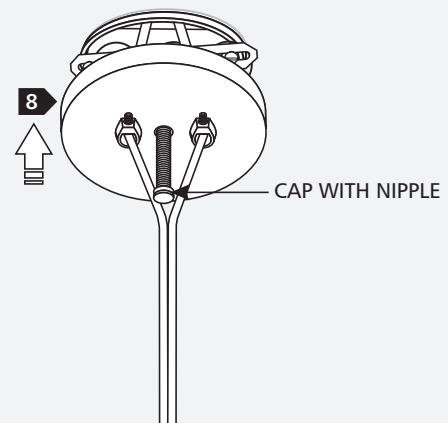
**2C**

- 8** Secure the canopy to the electrical box by screwing the cap with nipple to the crossbar.

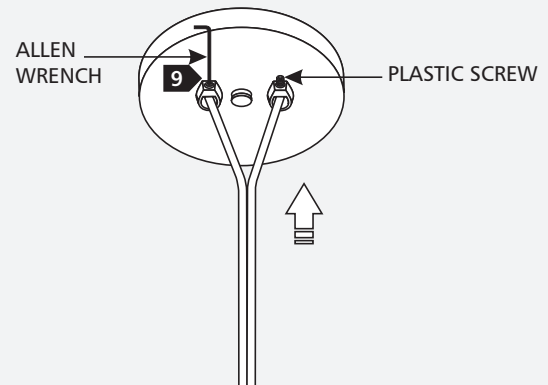
**2D**

- 9** Push the excess power feed wires into the canopy and tighten the plastic screw with the provided Allen wrench.

## Connecting the End Power Feed Connectors to the MonoRail

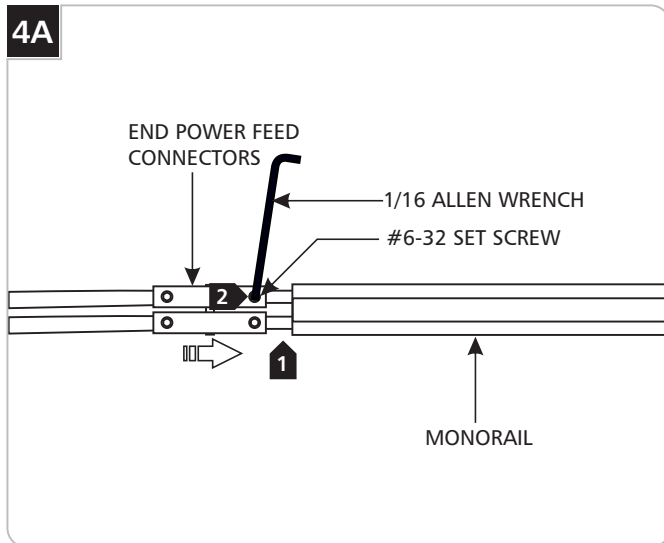

- 1** Insert the end power feed connectors completely into the MonoRail end.
- 2** Tighten the #6-32 set screws with the 1/16 Allen wrench.

## Important Safety Information

To reduce the risk of fire and burns, do not install this lighting system where the uninsulated open bus bar conductors can be shorted or contact any conductive materials.

To reduce the risk of the system overheating and possibly causing a fire, make sure all the connections are tight.

Do not install fixture assemblies closer than six inches to curtains or similarly combustible materials.

Turn the electrical power off before modifying the lighting system in any way.

The fixtures used with the system must be identified to be used with the corresponding system.

Load the circuit of the remote transformers to no more than the maximum rated capacity as specified.

To reset the electronic surface transformer, turn the power off then on (main power, breaker panel, or wall switch).

**SAVE THESE INSTRUCTIONS!**



7400 Linder Ave, Skokie, IL 60077  
847.410.4400

**[www.techlighting.com](http://www.techlighting.com)**

© 2008 Tech Lighting, L.L.C. All rights reserved. The "Tech Lighting" graphic is a registered trademark of Tech Lighting, L.L.C. Tech Lighting reserves the right to change specifications for product improvements without notification.  
A Generation Brands Company