

Surface Transformer

SINGLE-FEED, 12 VOLTS 300 WATTS

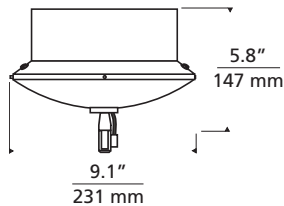

Shown approx. 20% actual size.



mo2_srt30d_spec.pdf

DESCRIPTION

This single-feed surface transformer converts standard 120 line voltage to 12 volts to provide the necessary voltage for powering a Two-Circuit MonoRail low-voltage lighting system. It can power lamps totaling up to 300 watts with 150 watts maximum on each circuit. The transformer is concealed inside a decorative housing with a fast acting secondary circuit breaker that will safely turn the system off should a short occur. Once the short has been removed the breaker can be reset.

INSTALLATION

This product can mount to either a 4" square electrical box with round plaster ring or an octagon electrical box (not included). Rail is installed through the power feed on the canopy to bring power to the run.

DIMMING

This transformer is equipped with two 120 volt input lines and is dimmable with up to two 600 watt low-voltage magnetic dimmers. Each dimmer can control up to 150 watts and is placed on the line side of the transformer. (Consult dimmer manufacturer for specifics). Preinstalled debuzzing dimming coils are included to reduce audible noise when using a low-voltage dimmer.

FINISH

Antique bronze, chrome, satin nickel, black, white. Black and white finish have satin nickel feeds.

COMPATIBLE RIGID STANDOFFS

The shortest rigid standoff that can be used with this surface transformer is the 6" rigid standoff (sold separately). If dropping the rail more than 6" below the ceiling, order the desired rigid standoff length and one compatible power extender (sold separately).

OPTIONS

This surface transformer may be plugged in with the addition of two Plug Options, a 16 foot cord with inline switch two feet from the plug (sold separately).

REQUIRED USAGE

12 volt transformers require the use of 12 volt lamps.

WEIGHT

20.40 lb./9.25 kg. ±

ORDERING INFORMATION

700MO2SRT30D

FINISH

- Z ANTIQUE BRONZE
- C CHROME
- S SATIN NICKEL
- B BLACK
- W WHITE

700MO2SRT30D _____

FIXTURE TYPE: _____

JOB NAME: _____



7400 Linder Avenue T 847.410.4400
Skokie, Illinois 60077 F 847.410.4500

www.techlighting.com

