

Port Alone

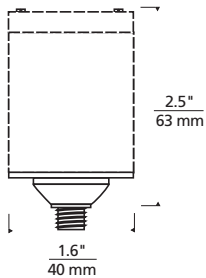

Shown approx. 25% actual size.



fj_port_alone_spec.pdf

DESCRIPTION

Port Alone allows a series of FreeJack elements to be powered from a single-feed remote transformer (sold separately). The low-voltage leads from the remote transformer are connected to the canopy leads inside the junction box. Each FreeJack element can be used up to its specified wattage (see element and accessory for details).

INSTALLATION

Mounts to Tech Lighting's special cylindrical 1-1/2" diameter, 2-1/2" deep junction box (included). Access to back of ceiling is not needed. If wall mounting, head should be no longer than 6".

FINISH

Antique bronze, chrome, satin nickel.

REQUIRED USAGE

Remote transformer and any FreeJack pendant or head (sold separately).

WEIGHT

0.60 lb./0.27 kg. ±

ORDERING INFORMATION

700FJFCP

FINISH

- Z ANTIQUE BRONZE
- C CHROME
- S SATIN NICKEL



7400 Linder Avenue T 847.410.4400
 Skokie, Illinois 60077 F 847.410.4500

www.techlighting.com

700FJFCP _____

FIXTURE TYPE: _____

JOB NAME: _____

