

# Zhane Trio Suspension (LED)

700ZHNT\_-LED

1.0



## GENERAL PRODUCT INFORMATION:



This product can mount to either a 4" square electrical box with a round plaster ring or an octagon electrical box.

This product is suitable for damp locations.

This instruction shows a typical installation.

**CAUTION:** To reduce the risk of a burn or electric shock during relamping, disconnect the power to the fixture.



## Shorten the Power Cord

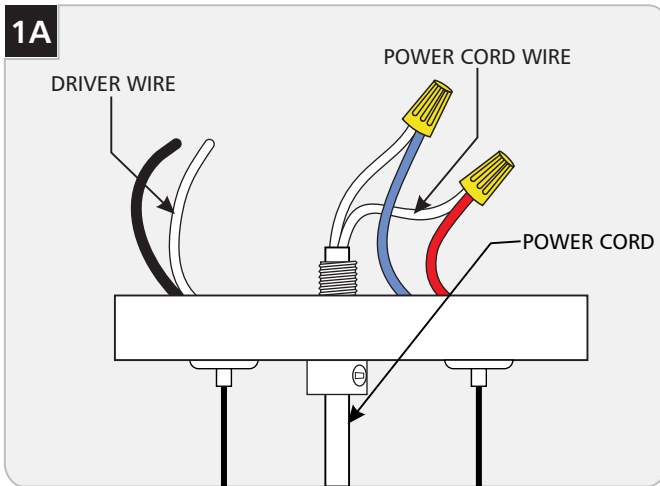

- 1 Take note of the wire connections and remove the wire nuts to disconnect the power cord wires from the driver wires.

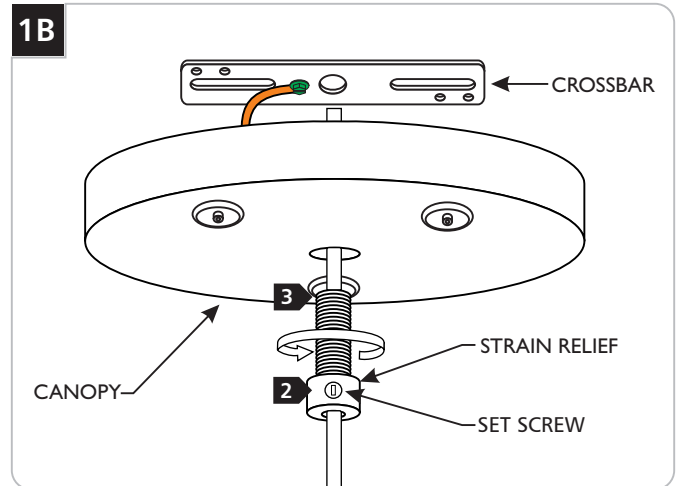

- 2 Loosen (Do Not Remove) the set screw on the strain relief.
- 3 Remove the crossbar from the canopy by completely unscrewing the strain relief.

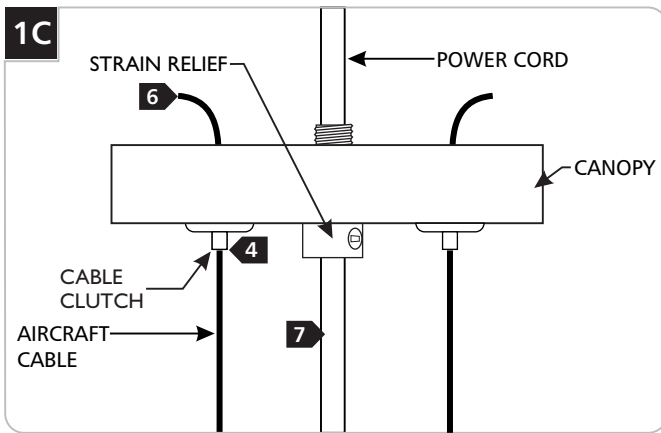

- 4 Feed the aircraft cable through the cable clutch in the canopy.
- 5 Pull the aircraft cable up through the canopy to determine the fixture height.
- 6 Cut off the excess aircraft cable leaving enough for fine leveling later.
- 7 Pull the power cord through the canopy to the desired length.

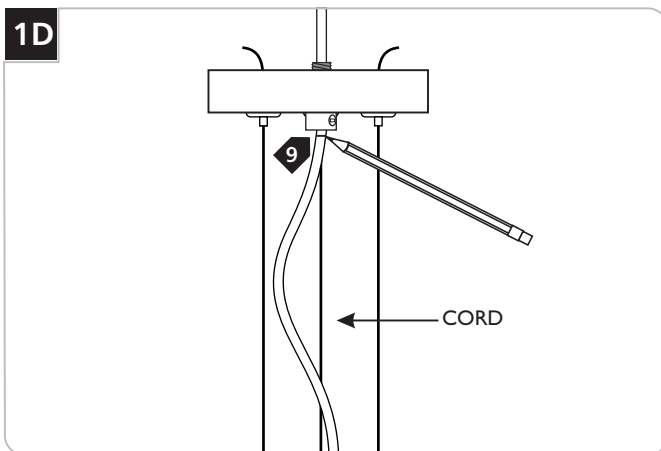

**NOTE:** The power cord does not support the fixture. For a casual "lazy cord" look, cut the power cord several inches longer than the drop height of the fixture.

- 8 Once the desired look is determined, tighten the set screw on the strain relief.
- 9 Mark the cord underneath the strain relief.

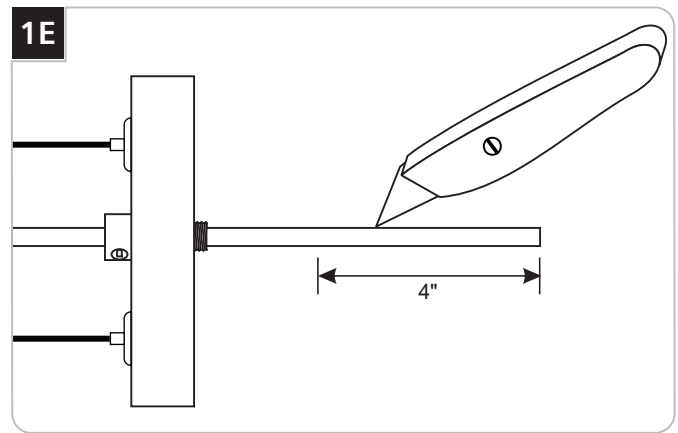

- 10 Leave 6" of the cord behind the canopy for power connections. Cut the excess cord.
- 11 From the end of the cord, strip the insulation 4" using a sharp knife. **Make sure not to nick the inner wires.**
- 12 Strip the end of the wires.
- 13 Reconnect the power cord wires to their original connections (reversal of 1A).

## Mount the Fixture

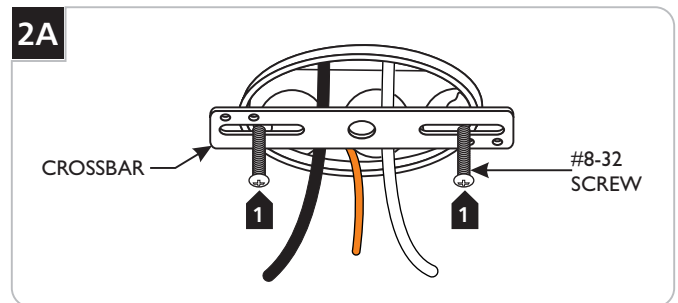

- 1 Mount the crossbar to the electrical box with the two provided #8-32 screws.

**NOTE:** It is recommended that one person hold the fixture while the electrician connects the power and installs the canopy.

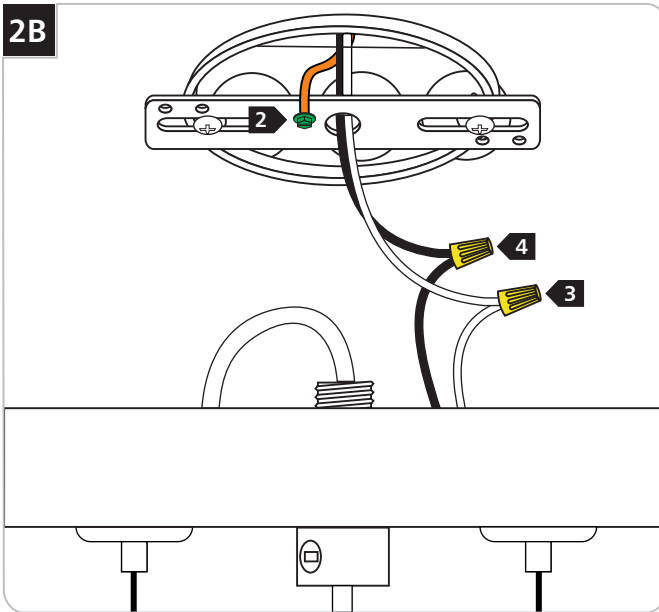
**2B**

- 2 Ground the fixture to a suitable ground in accordance with local electrical codes.
- 3 Connect the white driver wire to the neutral power line wire.
- 4 Connect the black driver wire to the hot power line wire.

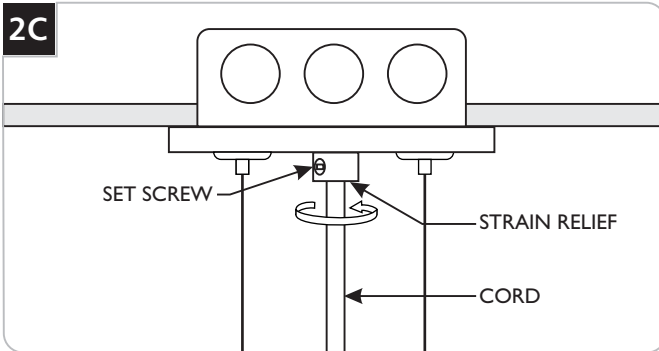
**2C**

- 5 Place all wires and wire nut connections properly inside the electrical box.
- 6 Loosen the set screw on the strain relief.
- 7 Align the canopy center hole with the crossbar center hole.
- 8 Place the canopy up against the ceiling and secure it in place by tightening the strain relief into the crossbar. **Do not turn the cord.**
- 9 Push the cord into the canopy and line up the marked point on the cord with the bottom of the strain relief.
- 10 Tighten the plastic set screw to secure the cord.

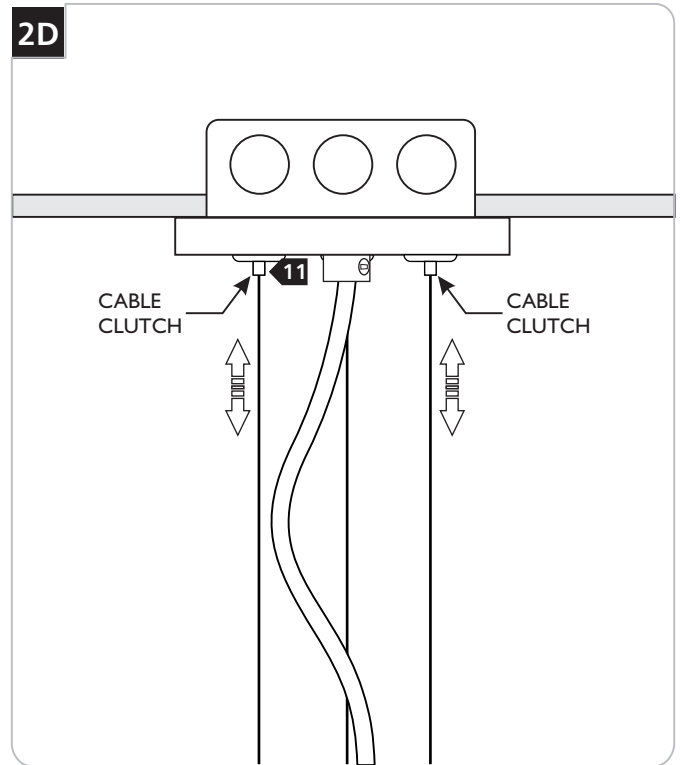
**2D**

- 11 Adjust the aircraft cables until the fixture is level; feed the cable into the cable clutch to raise the fixture and push in on the cable clutch nipple to release the cable and lower the fixture.

**SAVE THESE INSTRUCTIONS!**



7400 Linder Ave, Skokie, IL 60077  
847.410.4400

[www.techlighting.com](http://www.techlighting.com)

© 2013 Tech Lighting, L.L.C. All rights reserved. The "Tech Lighting" graphic is a registered trademark of Tech Lighting, L.L.C. Tech Lighting reserves the right to change specifications for product improvements without notification.  
A Generation Brands Company