

Wrightwood Pendant (Compact Fluorescent)

600WRIP_CF

1.0



GENERAL PRODUCT INFORMATION:



This product can mount to either a 4" square electrical box with round plaster ring or an octagon electrical box.

This product is suitable for indoor damp locations.

This instruction shows a typical installation.

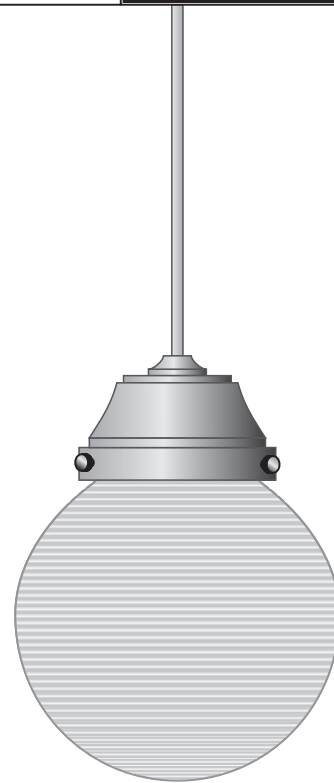

CAUTION - RISK OF FIRE
 This product requires installation by a qualified electrician. Before installing be sure to read all instructions and **TURN THE POWER TO THE ELECTRICAL BOX OFF.**

Install the Fixture

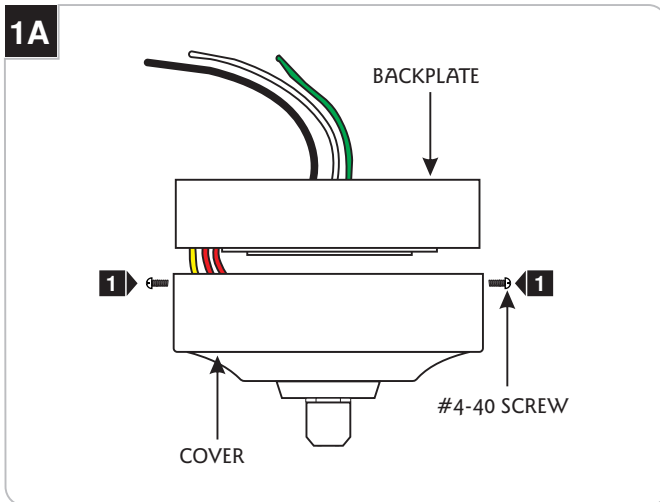

1 Remove the #4-40 screws on canopy sides to remove the cover from the backplate.

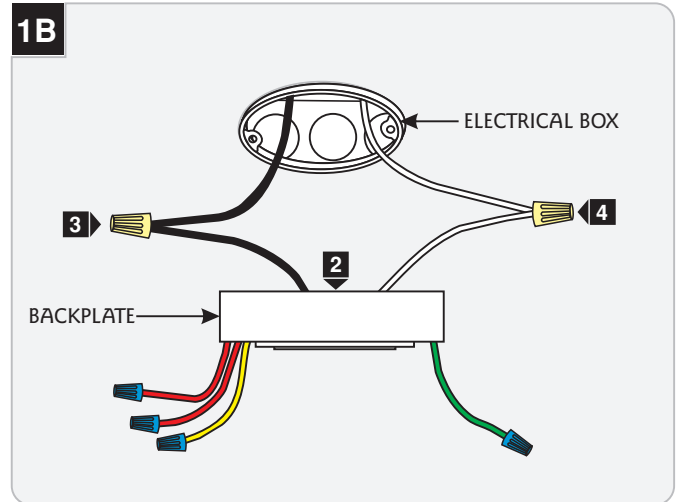

- 2** Make sure that the backplate is grounded in accordance with local electrical codes.
- 3** Connect the black ballast wire to the hot power line wire with a wire nut.
- 4** Connect the white ballast wire to the neutral power line wire with a wire nut.

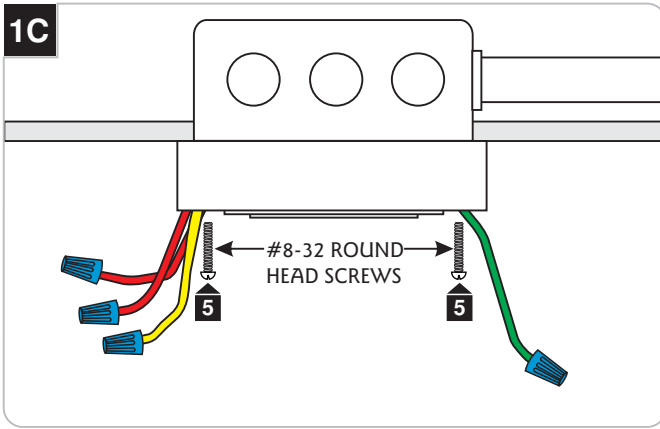

- 5** Place all power line wires and wire nut connections properly into the electrical box and mount backplate to the electrical box with the provided two #8-32 round head screws.

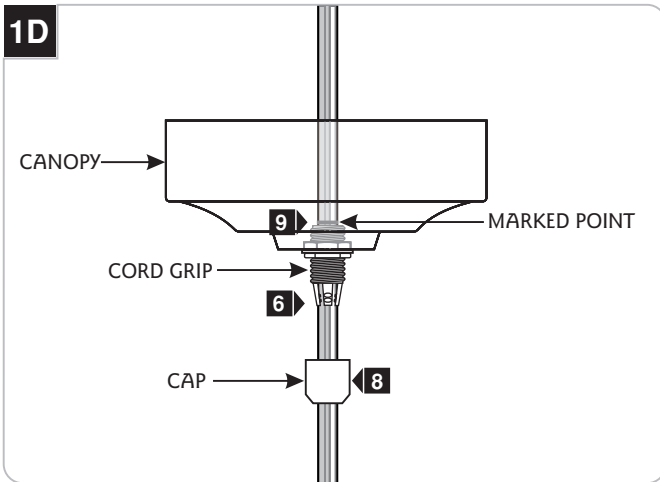

- 6** Feed end of the fixture cord through the cap, and cord grip into the canopy.
- 7** Adjust the fixture height (from bottom of the fixture shade to top of the canopy) by moving the cord up or down.
- 8** When desired height is achieved, slightly tighten the cap.
- 9** From inside mark the cord right behind the cord grip for strain relief location.

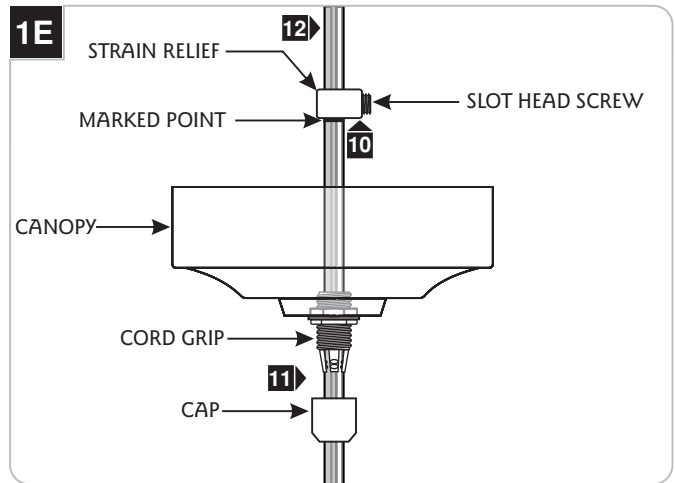

- 10** Loosen the cap and slot head screw, and feed the cord through the strain relief. Place the strain relief right above the marked point and tighten the slot head screw.
- 11** Slide the canopy up against the strain relief and tighten the cap to cord grip.
- 12** For power connection, leave at least 6" of the cord exposed in the back of the canopy.
- 13** Cut off the excess cord with a sharp cutter.

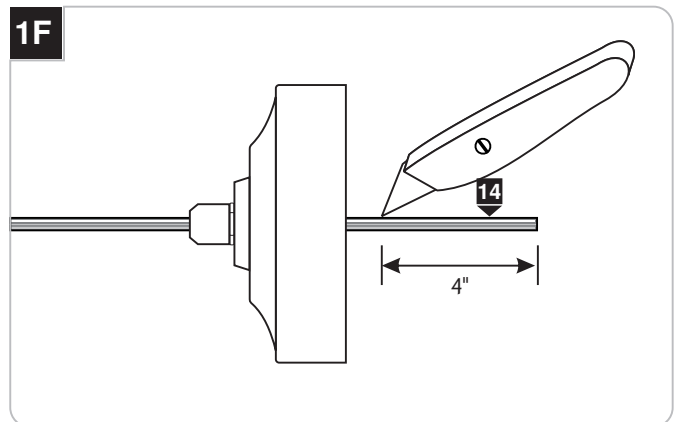

- 14** From the end of the cord, strip the outer insulation 4" using a sharp knife and needlenose pliers. ***Make sure not to cut inner wires.***
- 15** Strip 1/4" of insulation from the inner insulated wires. The bare inner wire is the ground wire.

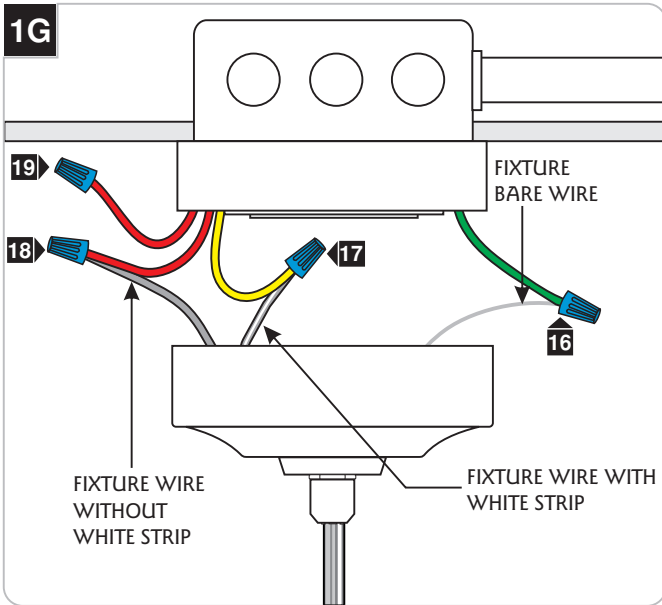

- 16** Connect the fixture bare uninsulated wire to the backplate ground wire (green wire) with a wire nut.
- 17** Connect the fixture wire with the white strip to the yellow ballast wire with a wire nut.
- 18** Connect the other fixture wire to one of the red ballast wires (either one) with a wire nut.
- 19** Leave the other red ballast wire capped with a wire nut.

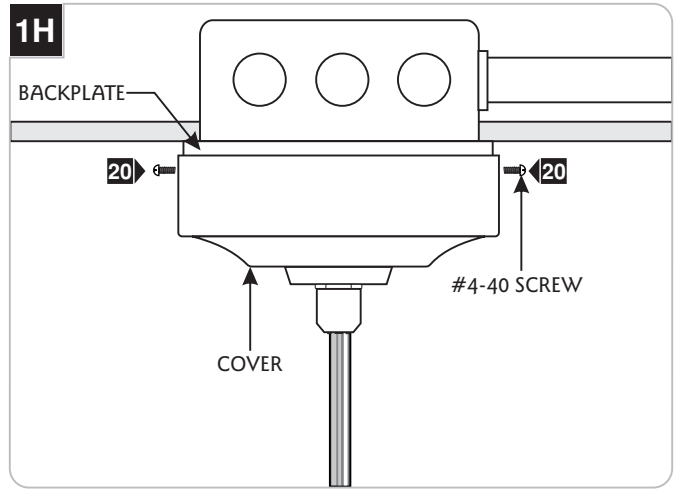

- 20** Line up the cover holes with the backplate holes. Replace and tighten the two #4-40 screws.

Install the Lamp and Glass Shade

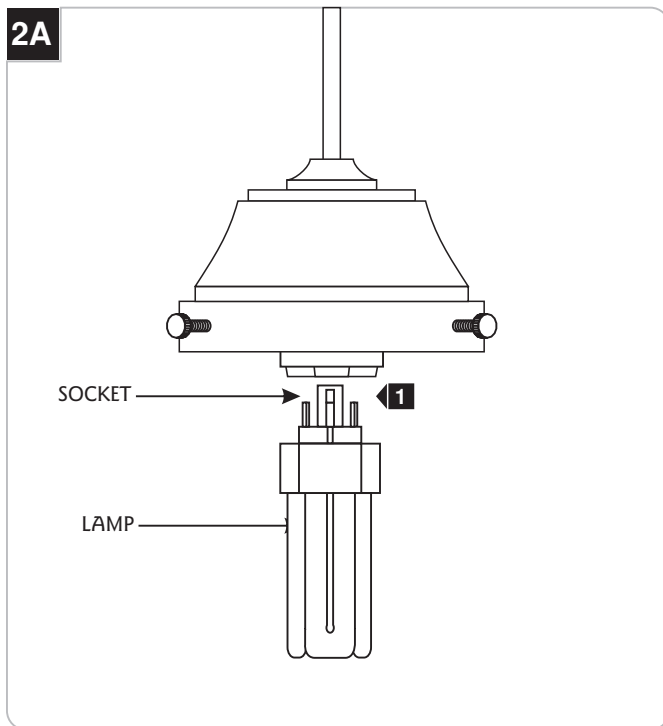

CAUTION: To reduce the risk of a burn or electric shock during relamping, disconnect the power to the fixture.

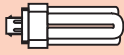
Use **MAX 18** Watt GX24Q-2 Triple Tube Compact Fluorescent Lamp. 

- 1 Push the lamp pins completely into the socket holes.

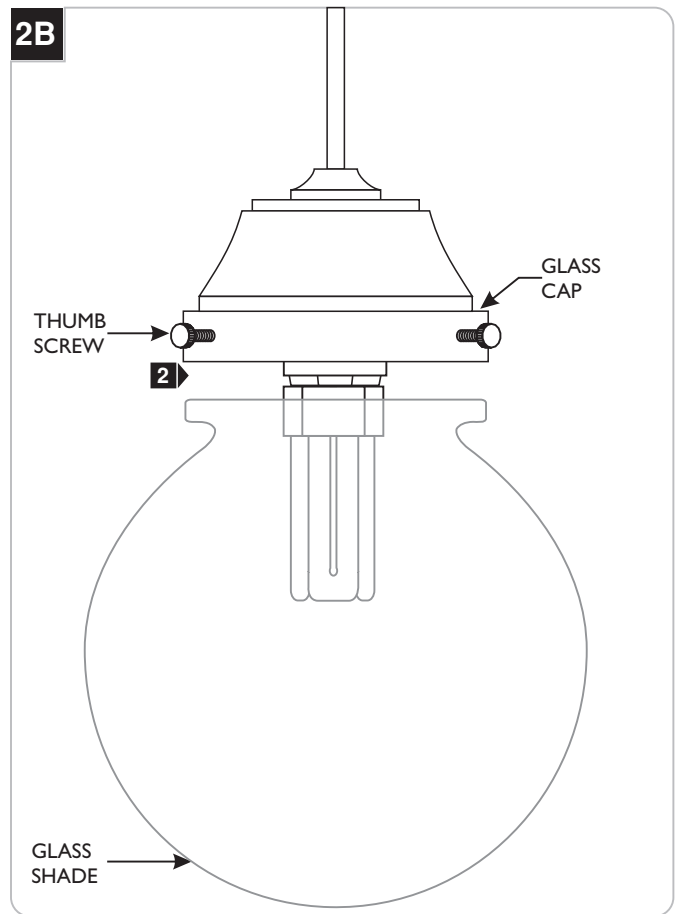

- 2 Place the glass shade completely into the glass cap and tighten the three thumb screws to secure the glass shade in place.

NOTE: Do not over tighten the thumb screw which may cause the glass shade to break.

SAVE THESE INSTRUCTIONS!

WILMETTE LIGHTING
COMPANY 

7400 Linder Ave, Skokie, IL 60077
847.410.4400

www.wilmettelighting.com

© 2008 Wilmette Lighting Company. All rights reserved. The "Wilmette Lighting Company" graphic is a registered trademark of Wilmette Lighting Company. Wilmette Lighting Company reserves the right to change specifications for product improvements without notification.

A Generation Brands Company