

# Union Large (Fluorescent Version)

600UNLS -CF

1.6



## GENERAL PRODUCT INFORMATION:



This product can mount to either a 4" square electrical box with round plaster ring or an octagon electrical box.

This product is suitable for damp locations.

This instruction shows a typical installation.

### CAUTION - RISK OF FIRE

This product requires installation by a qualified electrician. Before installing be sure to read all instructions and **TURN THE POWER TO THE ELECTRICAL BOX OFF.**

**NOTE:** When the "Industrial Hang Straight" is used with the suspension fixture, refer to the instructions provided with the "Industrial Hang Straight" before continuing the following steps.

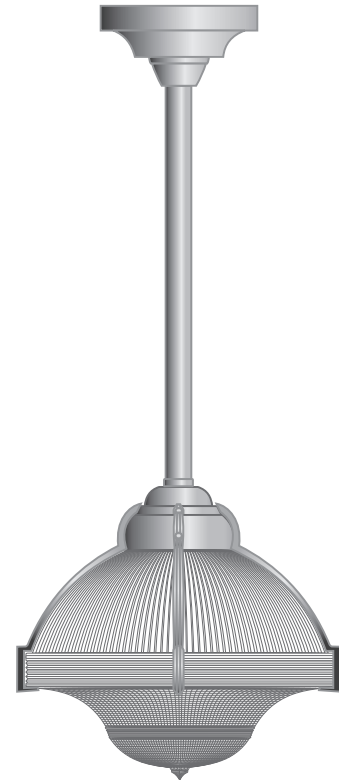

## Install the Fixture

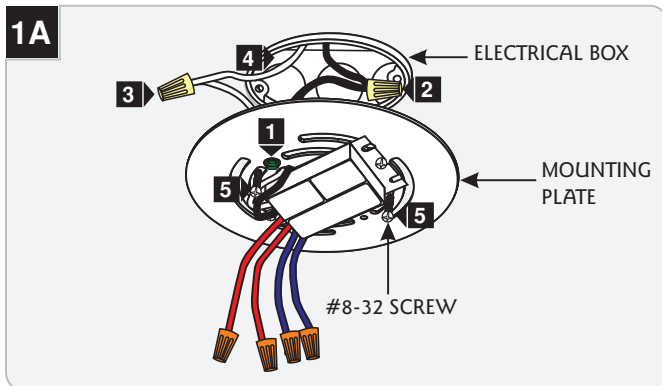

- 1 Make sure that the mounting plate is grounded in accordance with local electrical codes.
- 2 Connect the black ballast wire to the hot power line wire with a wire nut.
- 3 Connect the white ballast wire to the neutral power line wire with a wire nut.
- 4 Place all wire nut connections inside the electrical box.
- 5 Install the mounting plate to the electrical box with the two #8-32 screws provided.

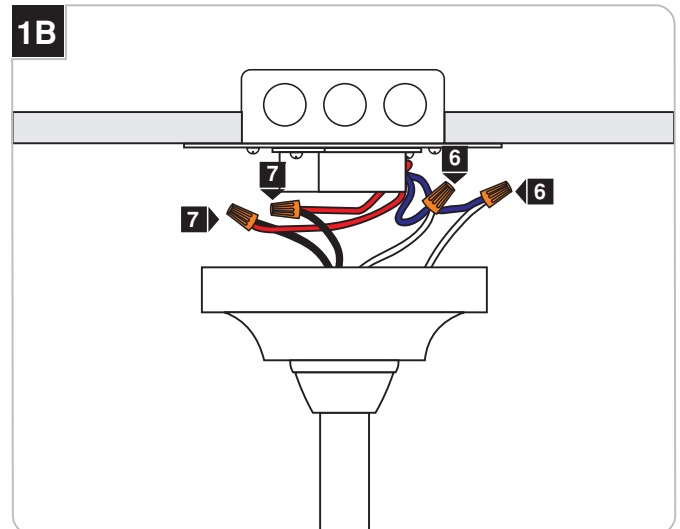

- 6 Connect one fixture white wire to one ballast blue wire with the wire nut. Repeat this step for the other fixture white wire and ballast blue wire.
- 7 Connect one fixture black wire to one ballast red wire with the wire nut. Repeat this step for the other fixture black wire and the ballast red wire.

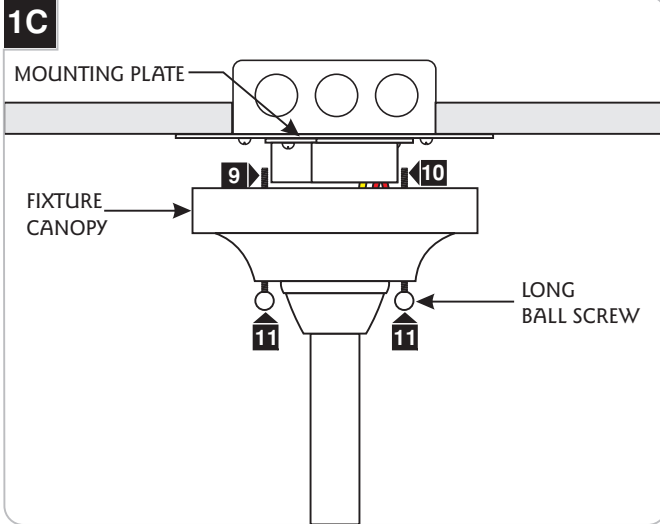

- 8) Locate two screw holes on the mounting plate that are 2-3/4" apart. These screw holes will be used to install the fixture canopy to the mounting plate.
- 9) Thread (**not completely**) a long ball screw through the canopy hole into one screw hole on the mounting plate.
- 10) Align and thread the second long ball screw through the other canopy hole into the other screw hole on the mounting plate.
- 11) Tighten the two long ball screws to secure the fixture in place.

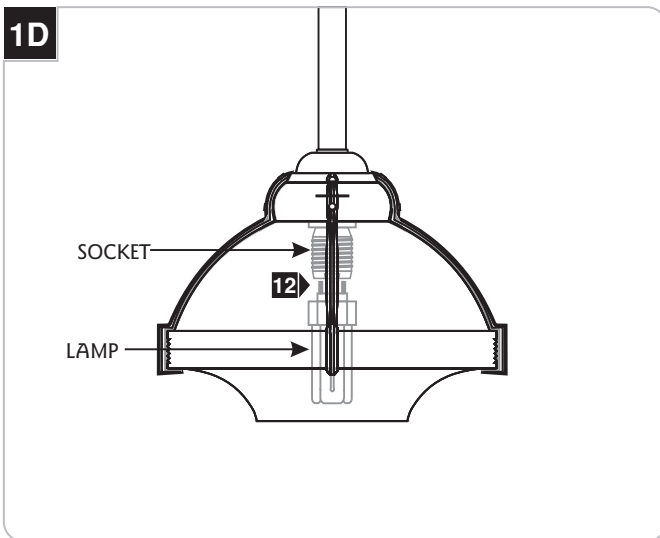

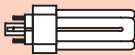
Use **MAX 32 Watt** GX24Q-3 Base Triple Tube Compact Fluorescent Lamp. 

- 12) Push the lamp pins completely into the socket holes.

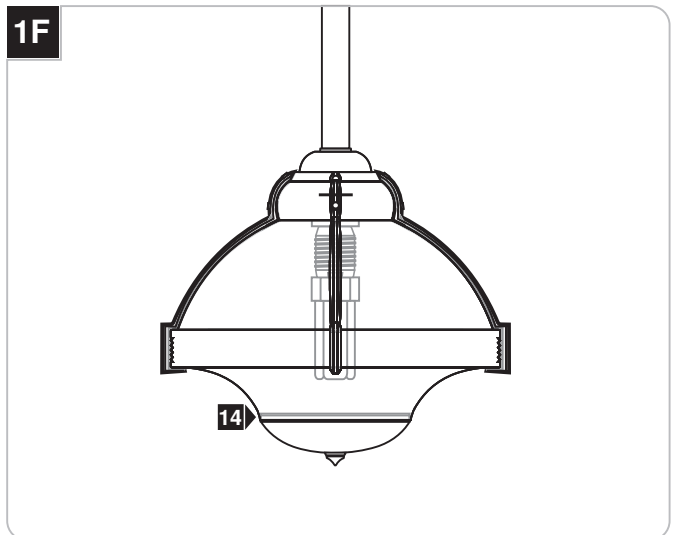
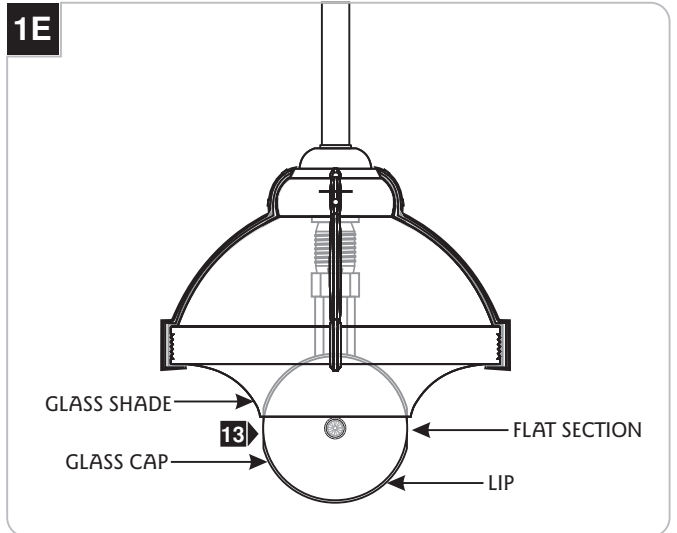

- 13) Align the flat section of the glass cap with the glass shade and feed it through the glass shade opening.
- 14) Carefully rotate and rest the glass cap lip onto the glass shade.

**NOTE:** To replace the lamp, remove the glass cap by following figures 1F and 1E. Remove the old lamp and follow steps 14 through 16.

**SAVE THESE INSTRUCTIONS!**

WILMETTE LIGHTING COMPANY 

7400 Linder Ave, Skokie, IL 60077  
847.410.4400

[www.wilmettelighting.com](http://www.wilmettelighting.com)

© 2008 Wilmette Lighting Company. All rights reserved. The "Wilmette Lighting Company" graphic is a registered trademark of Wilmette Lighting Company. Wilmette Lighting Company reserves the right to change specifications for product improvements without notification.

A Generation Brands Company