



CEILING

GENERAL PRODUCT INFORMATION:



This product is suitable for damp locations.

This product can mount to either a 4" square electrical box with round plaster ring or an octagon electrical box.

CAUTION - RISK OF FIRE

This product must be installed in accordance with the applicable installation code by a person familiar with the construction and operation of the product and the hazards involved.

Use minimum 90°C supply conductors.

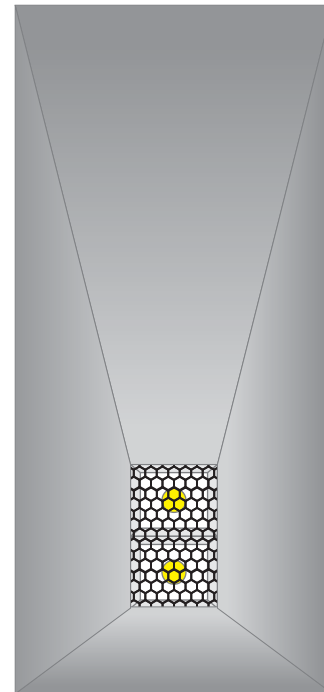

Install the Fixture

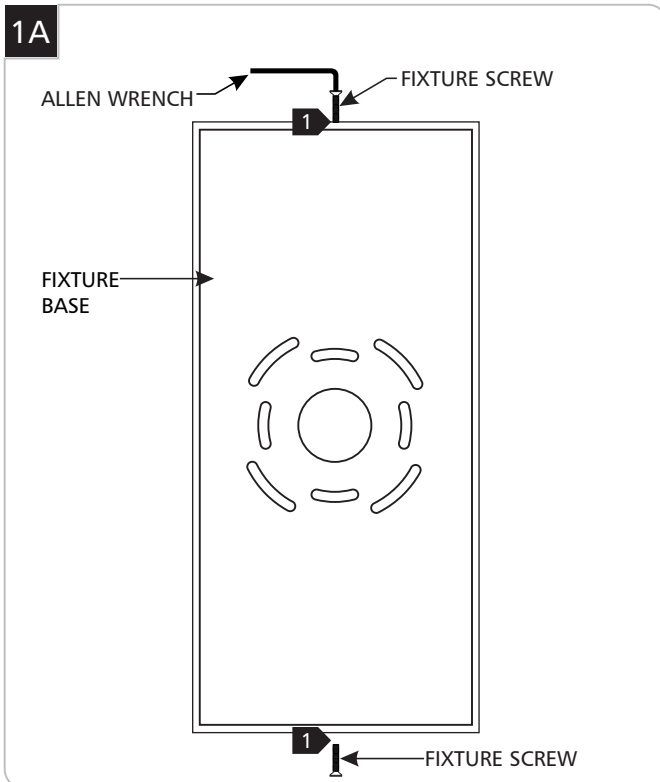

1 With the Allen wrench provided, remove the two fixture screws from the top and base of the fixture.

2 Separate the fixture base from the fixture cover.

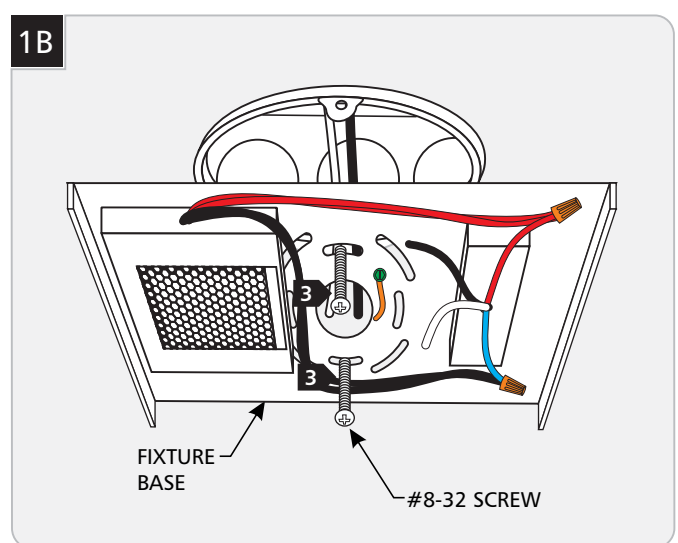

3 Secure the fixture base to the electrical box with the two #8-32 screws provided.

1C

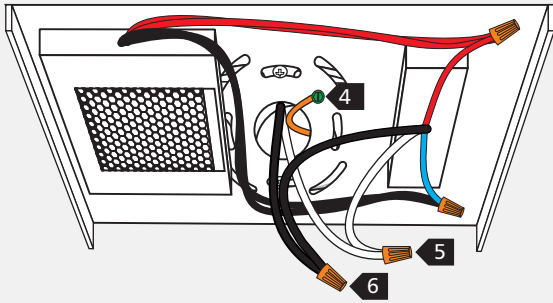

- 4 Connect the fixture to a suitable ground in accordance with local electrical codes.
- 5 Connect the white driver wire to the neutral power line wire with a wire nut.
- 6 Connect the black driver wire to the hot power line wire with a wire nut.

1D

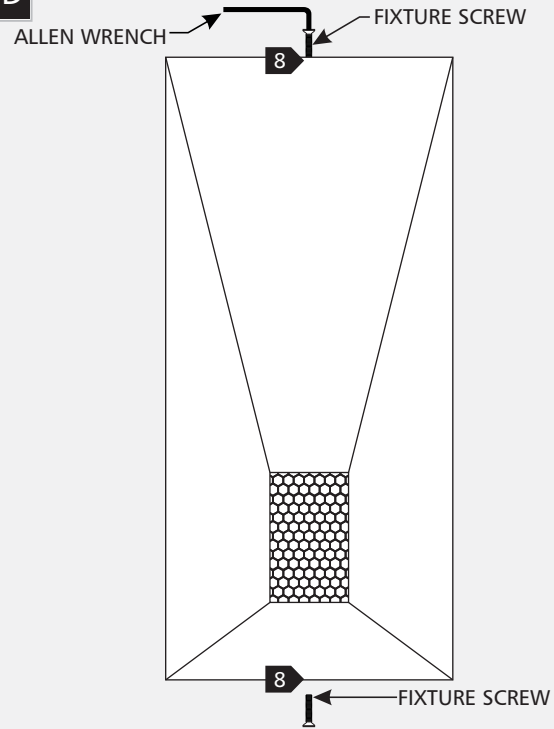

- 7 Properly place the wires and wire nut connections into the fixture.
- 8 Mount the fixture by sliding it back onto the mounting plate and reinstalling the two fixture screws (reversal of figure 1A).

SAVE THESE INSTRUCTIONS!



TECH LIGHTING®

7400 Linder Ave, Skokie, IL 60077

847.410.4400

www.techlighting.com

© 2014 Tech Lighting, L.L.C. All rights reserved. The "Tech Lighting" graphic is a registered trademark of Tech Lighting, L.L.C. Tech Lighting reserves the right to change specifications for product improvements without notification.

A Generation Brands Company