

2

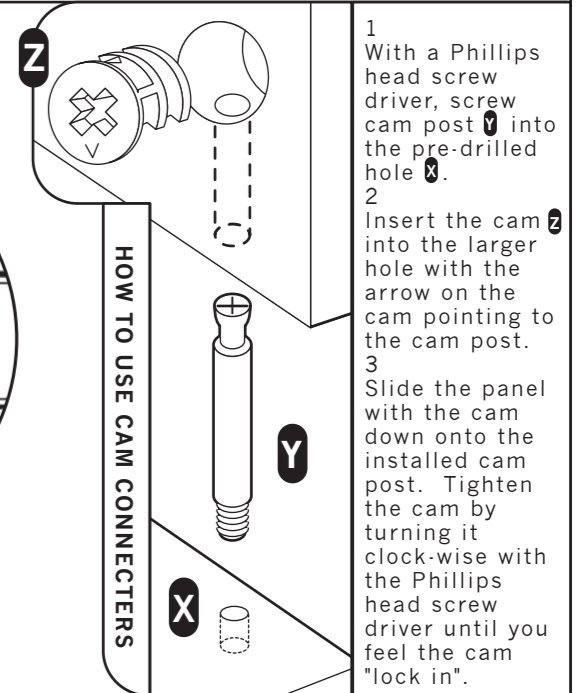

- 1 With a Phillips head screw driver, screw cam post **Z** into the pre-drilled hole **X**.
- 2 Insert the cam **Z** into the larger hole with the arrow on the cam pointing to the cam post.
- 3 Slide the panel with the cam down onto the installed cam post. Tighten the cam by turning it clockwise with the Phillips head screw driver until you feel the cam "lock in".

3

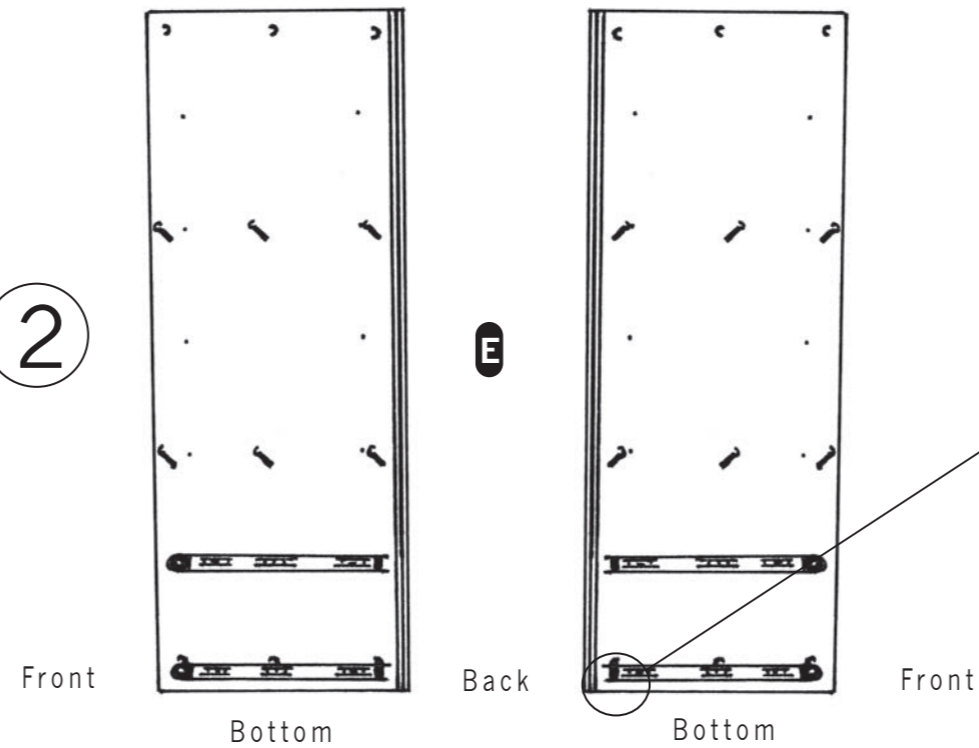
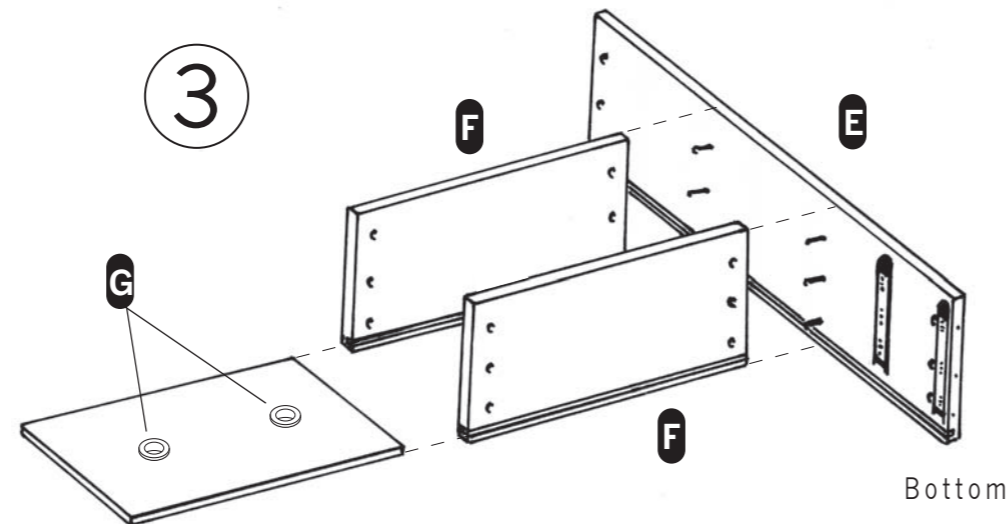

4

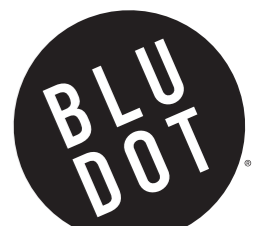
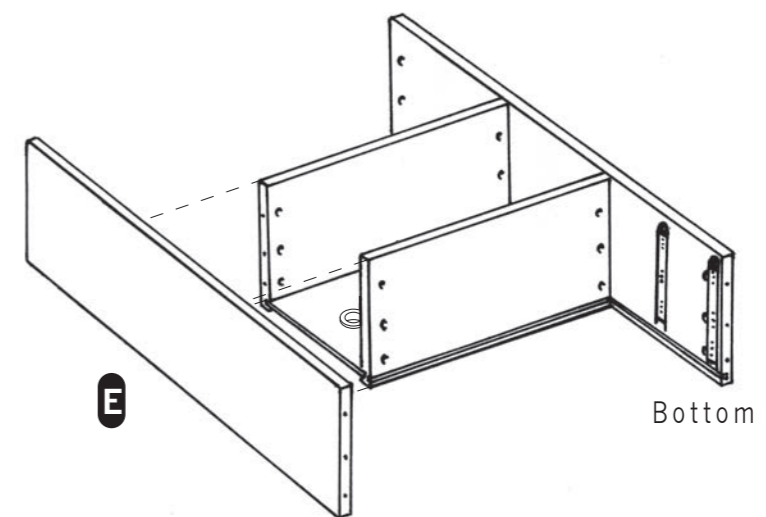

Assemble on carpet or protective mat.
Before beginning, familiarize yourself with using cam connectors. (see insert right corner)

- 1 First screw a cam post into the small hole on the side of each foot **A**. Place two cams in the stretcher **B** so that the arrow points towards the end of the stretcher and turn the cams to the right until snug. Now, you know how cams work (a valuable skill). Now locate the bottom panel **D**. This panel has holes drilled on both faces (the top panel has holes on only one side). Find the side with the groove. Place this side face down. Now with the other side facing up, screw cam posts into all four holes. Place cams into the four holes on the feet **A**. Attach feet/stretcher assembly to bottom panel by turning cams until snug. Push foot tacks into bottom side of the feet **C**. Turn this whole assembly over so it faces right side up, install six cam posts in the grooved side of the bottom panel **D** and set aside.
- 2 Locate the side panels **E** (the sides have grooves on the back edge). Lay them on the floor with the holes and

- grooves facing up. Screw six cam posts into the holes in the middle of each side panel. Attach the drawer slides using 2 slide screws in each. Refer to sketch 2.
- 3 Locate the shelves **F** (these have grooves on both sides). Insert six cams into the large holes of each shelf with the arrow pointing toward the hole on the edge. Tip side panel up on its side with the groove near the floor and slide the end of the shelf onto the cam posts. Do the same for the second shelf and tighten all cams (NOTE: Be sure the cams face downward towards the bottom). Install two black rubber grommets **G** in the holes in a white back panel by squeezing them into place. Kinky, No?
- 4 Take the back panel and slide it between the two shelves. Attach the other side panel and tighten cams. You should now have an "H" shaped assembly.

REV 1 05.14.2007

HARDWARE INVENTORY



BLU DOT DESIGN AND MANUFACTURING, INC. copyright 2007.
www.bludot.com / t. 612.782.1844 / f. 612.782.1845

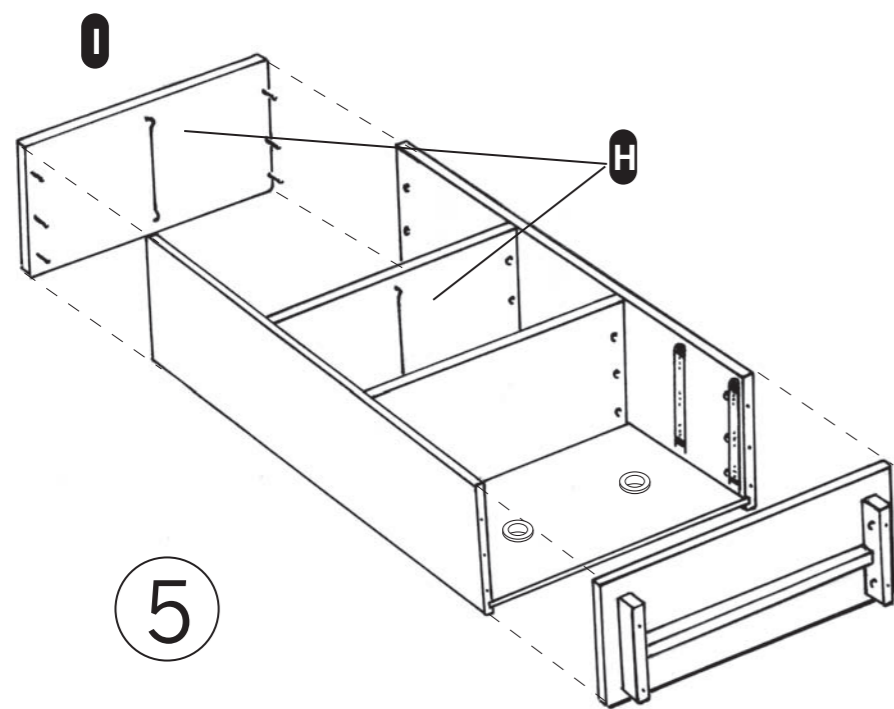
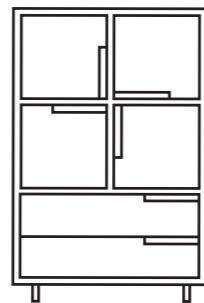

Metal faces out

x4

K

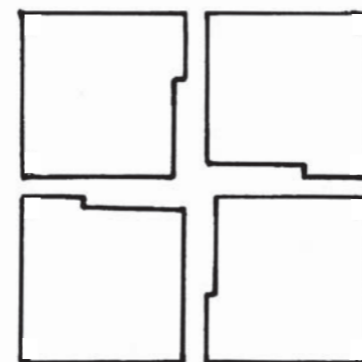
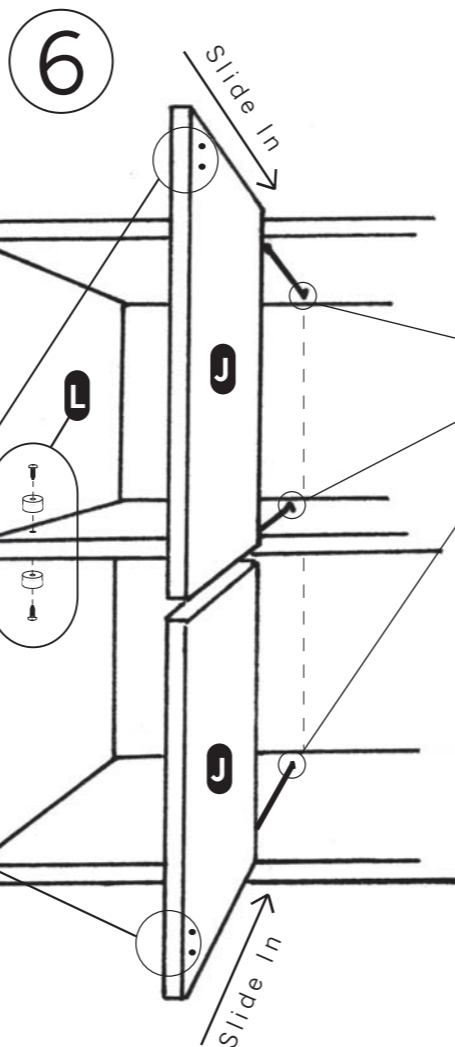

Swedish Brackets

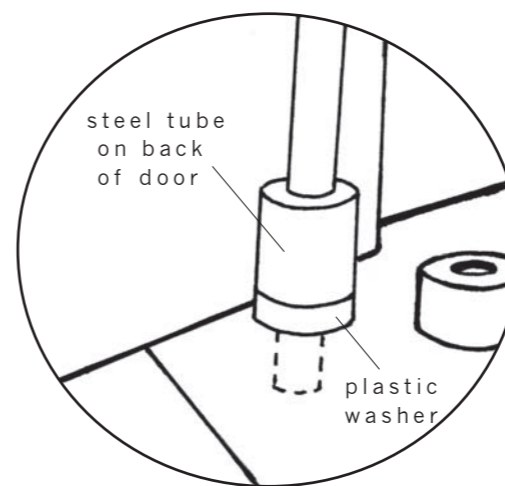

steel tube
on back
of door

plastic
washer

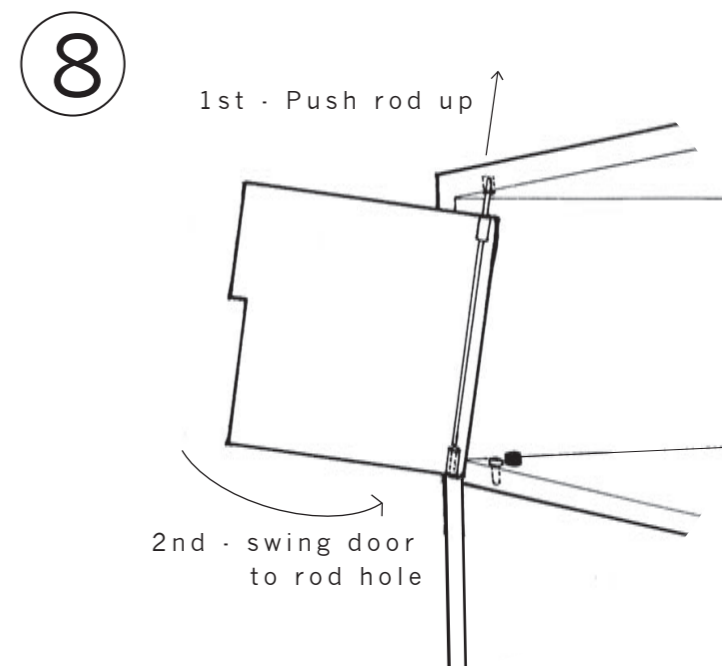

1st - Push rod up

2nd - swing door
to rod hole

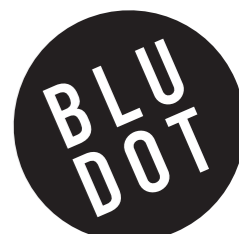
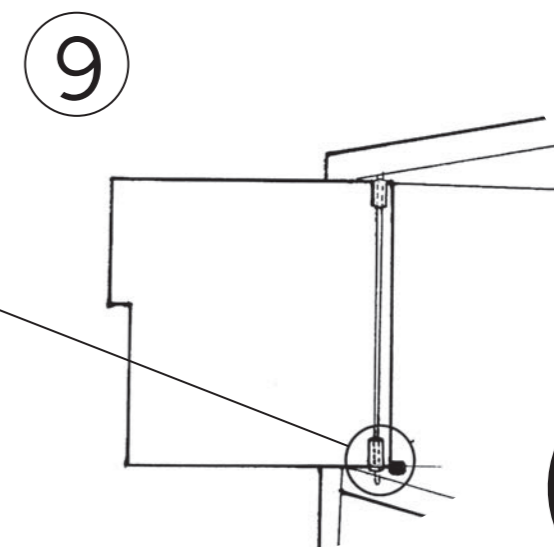

5 With a hammer, tap the swedish brackets **H** into the holes on top of the lower shelf, bottom of the top panel, and both sides of the upper shelf. Find the top panel **I** (it is the only panel with holes on only one side). Screw six cam posts into the top panel and attach it to the assembly. Take the base assembly and attach it to the bottom of the unit and tighten all cams. Tip the unit upright. Now comes the fun part.

6 It is now time to put in the vertical dividers **J**. The Swedish brackets slide into the grooves on the edges of the small dividers. Slide the divider in until the front edge is flush with the rest of the cabinet. Confused? See sketch 6. After the dividers are installed, fasten mag catches **K** with the eight short screws to both sides of the vertical dividers. Now, with the long screws, screw the black rubber bumpers **L** into the small pre-drilled holes on the shelves.

7 Lay out your steel doors on the floor face up to form the pattern shown in sketch 7. Now install each door into its corresponding opening in the cabinet. Start with the upper left door.

8 Take the door and slide the rod through both tubes on the back side. Hold the rod flush to the bottom of the door with your index finger. Place the top of the rod in the hole on the under-side of the upper left opening in the cabinet as shown in sketch 8). Swing the bottom of the door into the cabinet.

9 Slide a white plastic washer under the bottom tube on the door as shown in sketch 9. Align the rod and washer and slide the rod into the bottom hole. Repeat for remaining doors. Each door must have a white plastic washer on the bottom for proper door operation.

10 To install each drawer, pull the ball bearing cartridges on the cabinet slides to the front. Align drawer mounted slides with the cabinet slides and slide drawer in.

REV 1 05.14.2007

WOOD COLOR OVER TIME: Air and daylight will naturally change the color of the wood. For most woods, this change is gradual and very slight. During the first several months, while the patina is developing, items placed on the wood should be rotated to different locations to prevent uneven coloration. Over time an even patina will develop.

BLU DOT DESIGN AND MANUFACTURING, INC. copyright 2007.
www.bludot.com / t. 612.782.1844 / f. 612.782.1845