

Product Dimensions

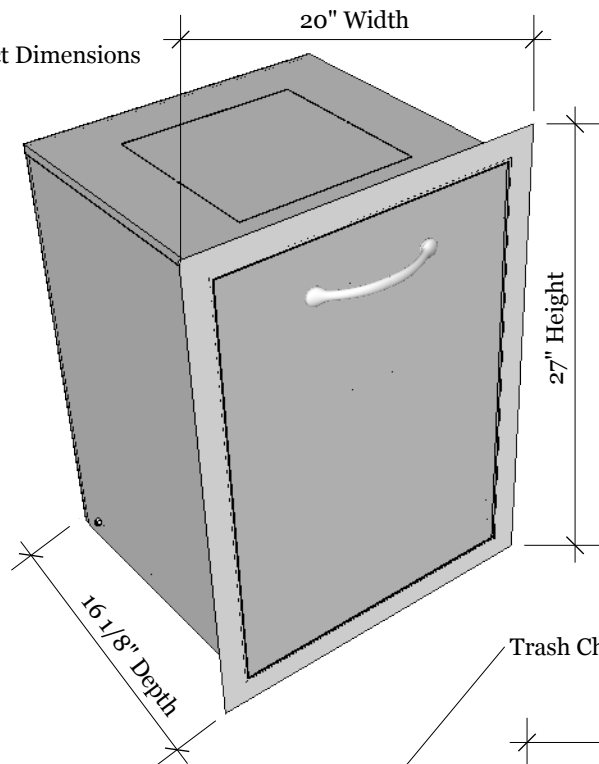

Cut-out Dimensions

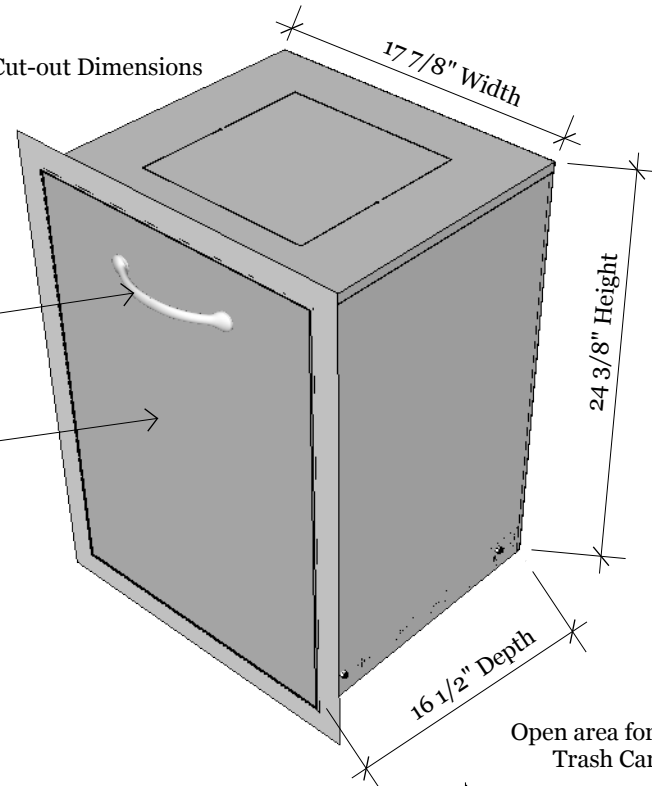

Texas BBQ Wholesalers
13802 Dragline Dr.
Austin, TX. 78728
Tel: 888.934.9449
Bus: 512.487.5116
Fax: 512.487.7016

PRODUCT
SUN TRASH DRAWER
Item No. A-TRHD

DESCRIPTION
SUN TRASH DRAWER
W/ ADJUSTABLE BAG
RING & TRASH-CHUTE
TOP PUNCH-OUT

Trash Drawer with optional top Punch-out
20" W x 16 1/8"D x 27"H (Product Size)
17 7/8"W x 16 1/2"D x 24 3/8"H(Cut-out)
39.6 LBS (Weight)

Material Specifications:
304 stainless steel Trash Drawer
16 gauge 304 SS for Frame and Panel.
20 gauge 201 SS for Box.
Handles are made of zinc alloy,
chrome plated.

Handles are made of
Zinc Alloy, Chrome
Plated

16 Gauge 304 SS
for Door & Frame

Trash Chute Punch-Out

Drawer Dimensions

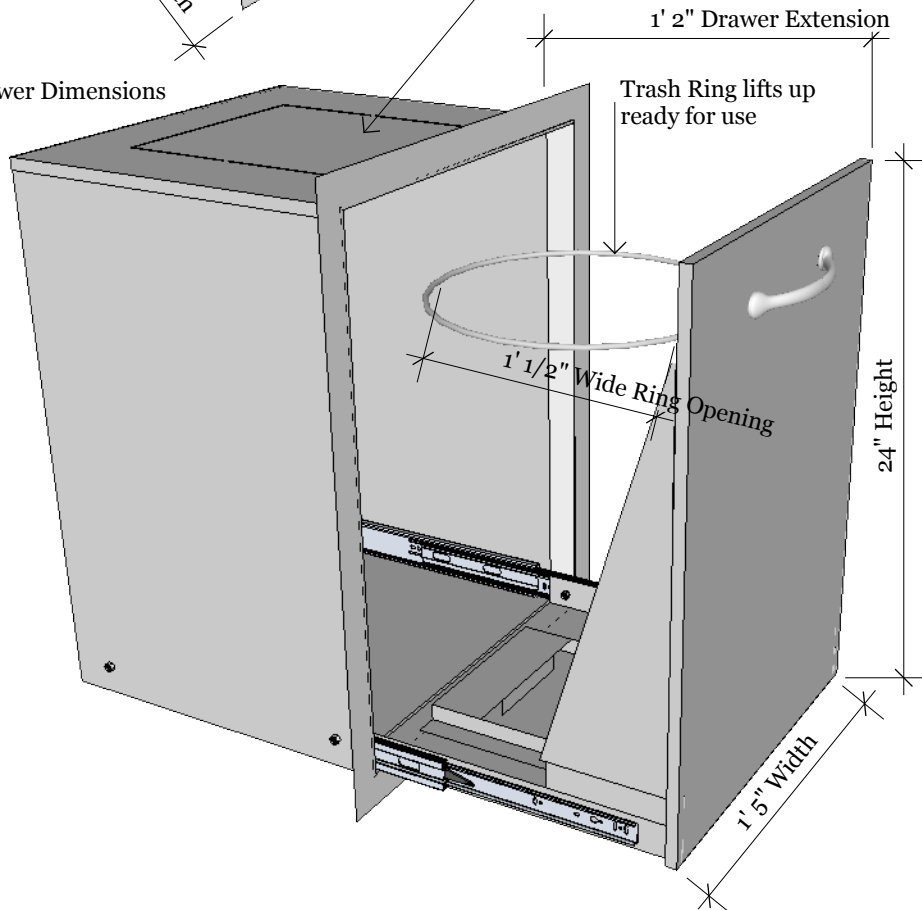

Trash Ring lifts up
ready for use

Trash Chute Dimensions

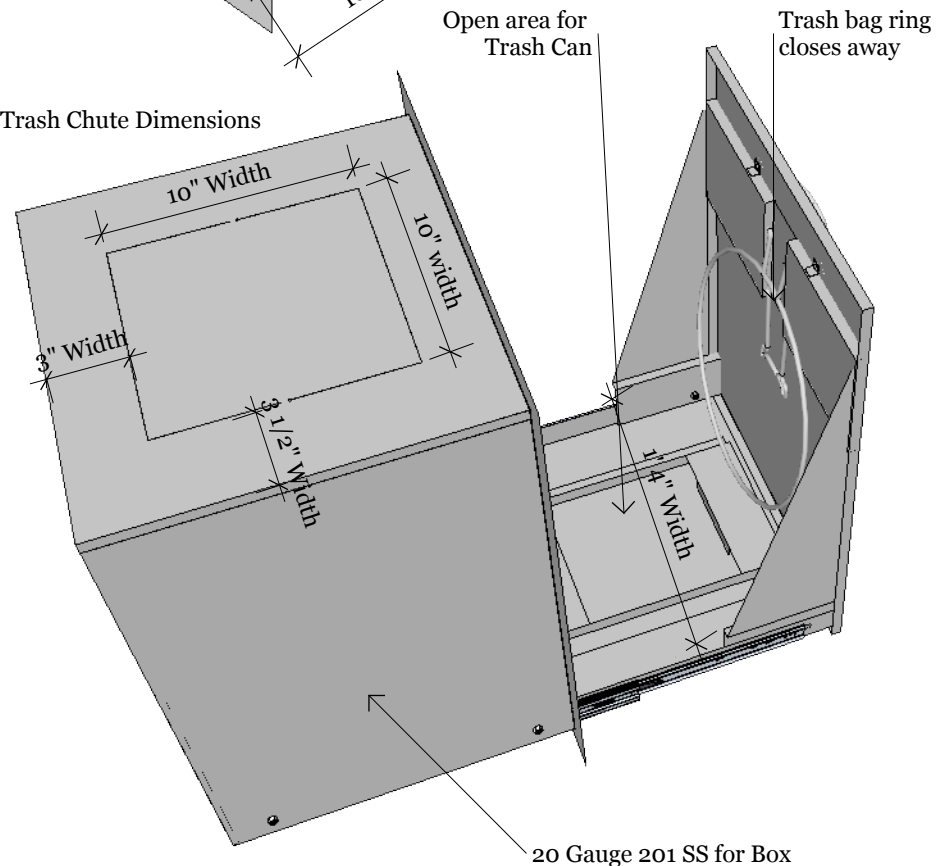

Open area for
Trash Can

Trash bag ring
closes away

20 Gauge 201 SS for Box