

# Enclume



## Premier Gourmet Rack PR35

Enclume racks are the ultimate in  
Quality, design, strength and function.  
Congratulations for owning one of the finest  
Storage racks made.

**WARNING:**  
**READ ALL OF THE INSTRUCTIONS**  
**BEFORE ASSEMBLING AND USING**  
**YOUR RACK.**

All of our hammered steel racks are finished with an industrial wax designed to give years of protection to the rack. Cleaning is easily done with a damp cloth. Dry thoroughly after cleaning. If a touch-up is ever needed we recommend a "Pledge" like wax product.

Enclosed you will find everything needed for the assembly and use of your storage rack. Two people make assembly and installation easier. The parts and hardware included are:

### Hardware included:

- 4 – 3/8" x 1/2" Button Head Screws
- 2 – 3/8" x 3/4" Button Head Screws
- 2 – 3/8 X 1 Button Head Screw
- 2 – 3/8" Nuts
- 2 – Ceiling Screw Hooks (Large)
- 2 – 5" Extension Hooks
- 1 – 7/32" Allen Wrench
- 12 – EPR Hooks
- 12 – WSPHA Hooks
- 6 – WSGB HS Grid Brackets
- Toggle Kit

### Components included:

- 2 – Rectangle Sides
- 1 – Utensil Bar
- 1 – Grid
- 4 – Arms
- 1 – Upper Bar

**See reverse side for ASSEMBLY AND INSTALLATION INSTRUCTIONS**



**Limited Warranty:** This product is warranted to be free of material defects for a period of five years from the date of purchase. Customer's exclusive remedy shall be the repair or replacement of the defective product and shall be subject to the following conditions: (1) notice of any defect is received by Enclume within the warranty period and (2) customer returns the defective product to Enclume Design Products, Inc., 24 Colwell St., Port Hadlock, WA 98339, *postage prepaid* within 20 days following a return authorization number (which may be obtained by telephoning the number at the bottom of this instructions) being provided to the customer by Enclume. There are no other warranties, expressed or implied. **THERE ARE NO WARRANTIES OF MERCHANTABILITY OR FITNESS FOR A PARTICULAR PURPOSE. ENCLUME SPECIFICALLY DISCLAIMS ANY AND ALL INCIDENTAL OR CONSEQUENTIAL DAMAGES ARISING OUT OF THE PURCHASE OR USE OF ENCLUME'S PRODUCTS.**



If you need help, please call 1-877-ENCLUME

**Enclume Design Products, Inc.**  
24 Colwell Street, Port Hadlock, WA. 98339  
Phone 360-385-6100 • Fax 360-385-6156

[www.enclume.com](http://www.enclume.com)

# ASSEMBLY AND INSTALLATION INSTRUCTIONS for PR35

## Hardware included:

- 4 – 3/8" x 1/2" Button Head Screws
- 2 – 3/8" x 3/4" Button Head Screws
- 2 – 3/8" X 1" Button Head Screw
- 2 – 3/8" Nuts
- 2 – Ceiling Screw Hooks (Large)
- 2 – 5" Extension Hooks
- 1 – 7/32" Allen Wrench
- 12 – EPR Hooks
- 12 – WSPHA Hooks
- 6 – WSGB Grid Brackets
- Toggle Kit

## Components included:

- 2 – Rectangle Sides
- 1 – Utensil Bar
- 1 – Grid
- 4 – Arms
- 1 – Upper Bar

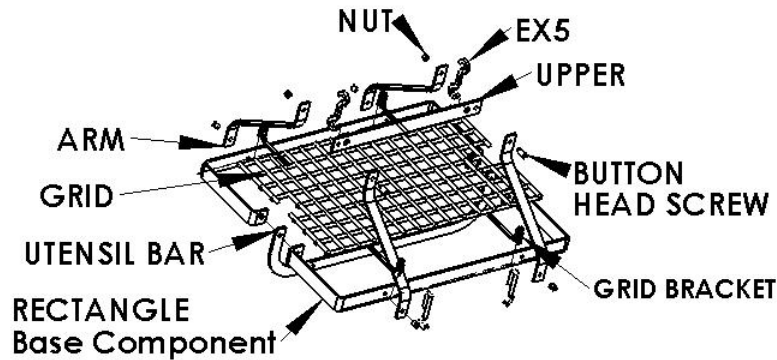

## Rack Assembly

- 1) This assembly is much easier with two people.
- 2) Place the two rectangle sides on a flat surface with the open, but inward ends facing each other.
- 3) Attach the utensil bar between the rectangle sides with the two 3/8" x 3/4" button head screws. The utensil bar is below the rack.
- 4) Attach the four arms to the OUTSIDE of the oval using the shorter 3/8" x 1/2" button head screws. Make sure the arm orientation is correct. The 45 degree bend is facing towards the center of the rack and is approximately even with the bottom of the rack body. Leave the four button head screws slightly loose.
- 5) Attach the upper bar to the four arms using the two 3/8" x 1" screws, and two nuts.
- 6) Square up the arms and tighten all the screws with the Allen wrench. The assembly is now complete.
- 7) Attach grid brackets and carefully slide the grid (from one end) onto the grid brackets.
- 8) We recommend that you anchor your rack into the solid wood of ceiling joists or beams. Carefully measure the area where the rack is to be hung and install the ceiling screw hooks directly into the wood joists. If it is not convenient to hang your rack directly into wood joists you may use the new-technology DRYWALL anchors enclosed with your rack. The steel anchors are very strong and when installed in drywall will hold 200 lbs. each. Two anchors hold about 400 lbs. Follow the instructions in the Toggler kit.
- 9) Hang the extension hooks from the ceiling screw hooks, then carefully hang the rack on the extension hooks
- 10) Hang your heavier items on the straight portion of the rack between the hanging arms or from the upper bar between the extension hooks. Hang your utensils from the utensil bar.
- 11) All of our hammered steel racks are finished with an industrial wax designed to give years of protection to the rack. Cleaning is easily done with a damp cloth. Dry thoroughly after cleaning. If a touch-up is ever needed we recommend a "Pledge" like wax product.
- 12) The grid has been treated with a finish which will resist corrosion and tarnish. It can be cleaned with a damp cloth and dried thoroughly. Please do not use abrasive cleaners.
- 13) Enjoy!



It is important that your rack is assembled correctly. If the unit is assembled or used incorrectly, it could become unstable and collapse, possibly causing injury.

If you need help, please call 1-877-ENCLUME



**Enclume Design Products, Inc.**  
24 Colwell Street, Port Hadlock, WA. 98339  
Phone 360-385-6100 • Fax 360-385-6156

[www.enclume.com](http://www.enclume.com)