

CONTACT US

**QUESTIONS? NEED PARTS?
WE ARE HERE TO HELP!**

TRINITY Customer Service

TEL: 800.985.5506

FAX: 310.347.4134

EMAIL: customerservice@TRINITYii.com

Monday - Friday

8:00 a.m. - 5:00 p.m. (Pacific Standard Time)

Thank you for purchasing a TRINITY EcoStorage™ 2-Tier Commercial-Grade Utility Cart. In order to register your product to receive streamlined customer service, please fill out the following Product Registration Form and (1) fax the form to 310.347.4134 or (2) complete the Product Registration Form at www.TRINITYii.com or (3) scan and email the form to customerservice@TRINITYii.com. Include a copy of your original receipt with your submission.

First Name: _____ Last Name: _____

Address: _____

City: _____ State: _____ Zip Code: _____

Email Address: _____ Phone: _____

Product Model #: _____ Purchase Date: ____ / ____ / ____

Location of Purchase: _____

Please rate the importance of each feature (1 - least important, 10 - most important)

Quality ____ Price ____ Size/Capacity ____ Appearance ____ Other ____

Comments/Suggestions:



ECOSTORAGE™ 2-TIER COMMERCIAL-GRADE UTILITY CART USER'S MANUAL

Please inspect box contents to ensure you have received all components.

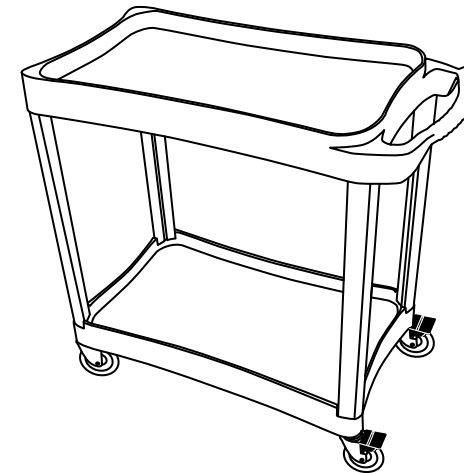

A Aluminum Legs - x4

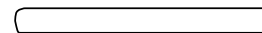

C Bottom Shelf - x1

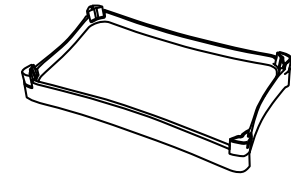

B Top Shelf w/Handle - x1

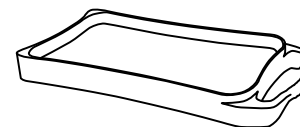

D Casters - x4
(2 locking, 2 non-locking)

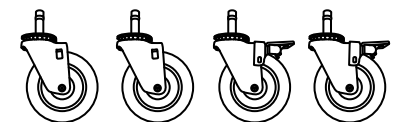

CAUTION: Failure to follow these guidelines may result in property damage or personal injury. Each shelf holds up to 125 lbs. with equal weight distribution on locked casters.



LIMITED WARRANTY

ECOSTORAGE™ 2-TIER COMMERCIAL-GRADE UTILITY CART Model TYZ-1801

We warrant to the original consumer purchaser ("Purchaser") of the TRINITY EcoStorage™ 2-Tier Commercial-Grade Utility Cart ("Product") that each Product shall be free from defects in workmanship and materials for a period of 1 year from the date of original purchase. Trinity's obligation under this warranty shall be limited to repair or replacement of, or adequate compensation for the Product which shall not be greater than the amount of the purchase price of the Product, at the option of Trinity, during the warranty period. All replaced parts and Products become the property of Trinity and must be returned to Trinity.

This warranty excludes normal wear and tear of the Product and its parts or components, and damage arising from any of the following: negligent use or misuse of the Product, use contrary to this User's Manual, or alteration by any one other than Trinity. The warranty period of 1 year shall not be extended or renewed by the repair or replacement of, or compensation for, the Product.

Except as set forth herein, there are no warranties on this Product either express or implied, and Trinity disclaims all warranties including, but not limited to, any implied warranties of merchantability, infringement or fitness for a particular purpose. No warranty or guarantee given by any person, firm, or corporation with respect to this product shall be binding on Trinity.

If your Product is defective or otherwise requires service or parts, please call TRINITY Customer Service toll-free at (800) 985-5506, between 8:00 a.m. and 5:00 p.m., PST. Please tell us which model you purchased, the date of the purchase, and the problem with your Product. A copy of your original purchase receipt must accompany your service request.

LIMITATION OF REMEDIES AND LIABILITY

Trinity shall not be liable for any incidental, consequential, special, or punitive damages for breach of any express or implied warranty on its Product. Except to the extent prohibited by applicable law, any implied warranty of merchantability or fitness for a particular purpose on this Product shall be limited to the duration of the above warranty. Neither Trinity nor anyone else who has been involved in the creation, production, delivery or sale of the Product shall be liable for any damages of any type, including but not limited to any lost profits, lost savings, loss of anticipated benefits, or any other incidental, consequential, special, or punitive damages which arise out of the purchase, use, or inability to use the Product, whether arising out of contract, negligence, strict tort, or any other legal theory on which a claim is based. Recovery of any kind against Trinity shall not be greater in amount than the purchase price of the Product. Without limiting the foregoing, Purchaser assumes all risk and liability for loss, damage or injury to Purchaser and Purchaser's property and to others and their property arising out of the use, misuse, or inability to use this Product. This limited warranty shall not extend to anyone other than the original purchaser of this product, is nontransferable and states your exclusive remedy.

Some states do not allow the exclusion or limitation of incidental, consequential, special, or punitive damages, so the above limitation or exclusion may not apply to you. The above warranty gives you specific legal rights, and you may have other rights which vary from state to state.

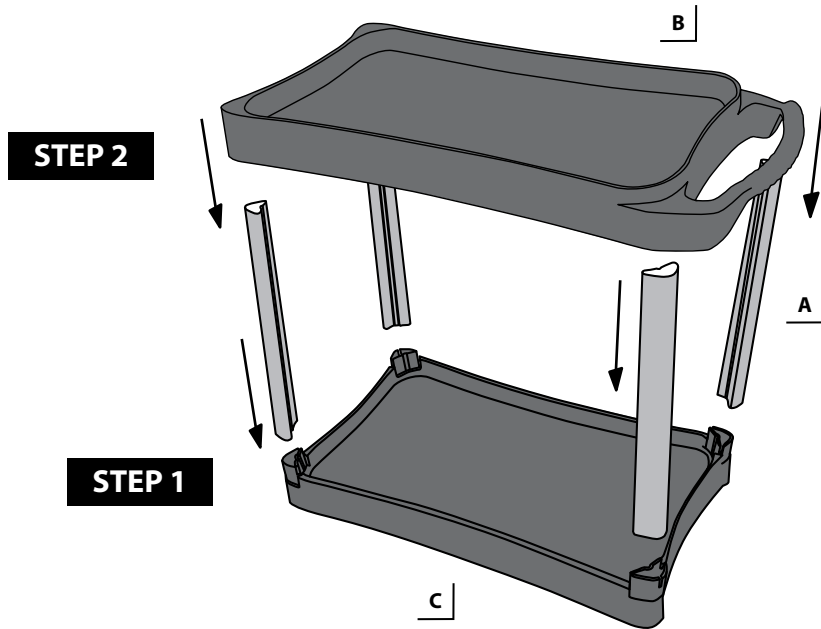

Step 1

Place the Bottom Shelf (C) right-side up on the ground. Secure all 4 Aluminum Legs (A) into the 4 corners of the shelf. Push down onto them all the way.

Step 2

Align the Top Shelf (B) with the 4 Aluminum Legs (A), and push down on the Top Shelf until secured. Please make sure that the Shelves and Legs are securely in place.

Step 3

Flip the entire cart upside down on the cart. Insert the caster stems into each corner. Please place the LOCKING CASTERS on the same side as the Handle on the Top Shelf. Push the Casters (D) in until you get a click. (This may require some additional force).

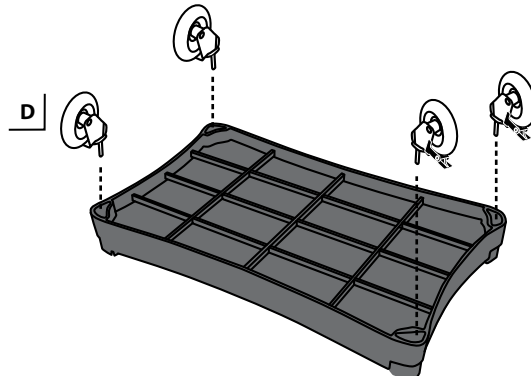

STEP 3