

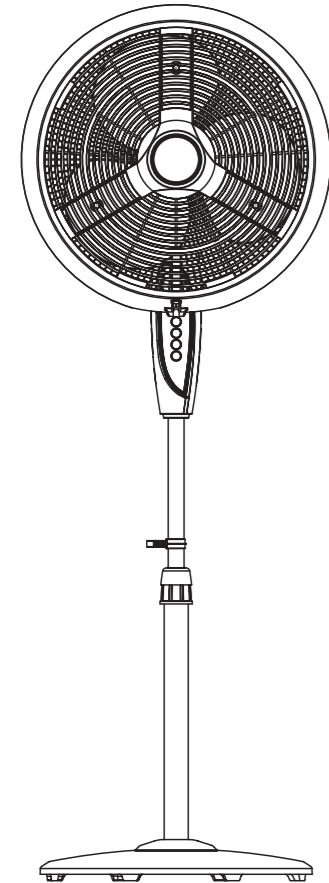

READ AND SAVE THESE INSTRUCTIONS

18" OUTDOOR MISTING FAN

MODEL AF-520



If the supply cord is damaged, it must be replaced by the manufacturer, its service agent or similarly qualified persons in order to avoid a hazard.

OUTDOOR MISTING FAN INSTRUCTIONS MANUAL

READ AND SAVE THESE INSTRUCTIONS
MODEL : AF-520

CAUTION:

Read Rules for Safe Operation and Instructions Carefully.

SAFETY INFORMATION

WARNING

- To reduce the risk of fire or electric shock, do not use this fan with any solid state speed control device.
- This product must be grounded. If it should malfunction or break down, grounding provides a path of least resistance for electric current to reduce the risk of electric shock. This product is equipped with a cord having an equipment-grounding conductor and a grounding plug. Plug into an appropriate outlet that is properly installed and grounded in accordance with all local codes and ordinances.
- This fan is provided with a ground fault circuit interrupter (GFCI) built into the plug of the power supply cord. This device provides additional protection from the risk of electric shock. Should replacement of the plug or cord become necessary, use only identical replacement parts that include GFCI protection.

CAUTION

- Do not leave the fan running unattended.
- Do not use fan in a window. Rain may create an electrical hazard.
- Do not stick any object or body parts in the grill of the fan while the blades are moving or the fan is plugged in.

RULES FOR SAFETY OPERATION

- Fan should be used under rated voltage.
- Connect power after the fan is fully assembled.
- Never insert fingers, pencils, or any other object through the guard when fan is running.
- Unplug from outlet when: not in use, when moving fan from one location to another, before putting on or taking off parts, and before cleaning.
- Disconnect fan when removing grilles for cleaning.
- Be sure fan is on a stable surface when operating to avoid overturning.
- DO NOT use fan in a window. Rain water may create an electrical hazard.

PARTS NAME

- A. Front grill
- B. Blade cap
- C. Fan blade
- D. Plastic sleeve
- E. Plastic nut
- F. Rear grill
- G. Motor shaft
- H. Clutch Knob
- I. Motor housing
- J. Push button
- K. Thumb screw
- L. Power cord
- M. Waterproof cover
- N. Misting line holder
- O. Internal pole
- P. Height adjustment knob
- Q. External pole
- R. Misting line
- S. Filter washer
- T. Valve
- U. Screws (pre-assembled)
- V. Stand ornament
- W. Base

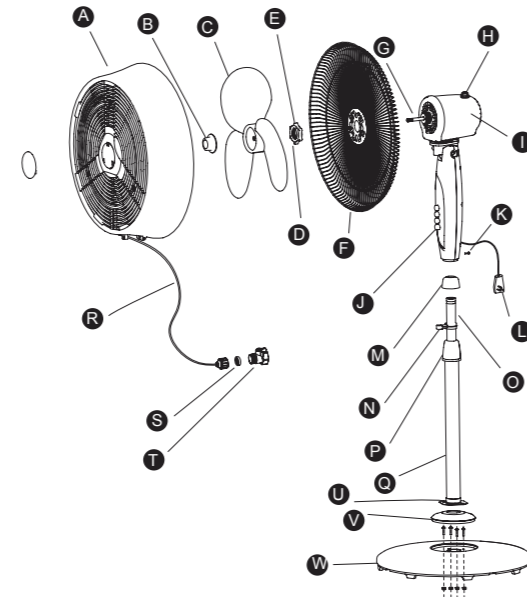

PREPARATION

Before beginning assembly of product, make sure all parts are present. Compare parts with package contents list and diagram above. If any part is missing or damaged, do not attempt to assemble the product. Contact customer service for replacement parts.

Estimated Assembly Time: 15 minutes

Tools Required for Assembly: Phillips Screwdriver (NOT INCLUDED)

ASSEMBLY INSTRUCTIONS

Step 1: Fan Base Assembly (Fig. 1)

- Unscrew the four screws (U) on the base (W), and then attach the external pole (Q) to (W) by tightening the four (U).
- Remove the height adjustment ring (P) by unscrewing it counterclockwise, and slide the stand ornament (V) down (Q) and over (W).
- Use your finger to pull out the internal pole (O). Slide (P) over (O). Fasten it to (Q) by turning the ring clockwise while holding the pole. Make sure (P) is tightly fastened before final assembly.

Step 2.: Fan Head Assembly (Fig. 2)

- Remove the blade cap (B) by turning clockwise. Remove the plastic nut (E) by turning counterclockwise. Discard plastic sleeve (D).
- Position the rear grill (F) over the motor shaft (G), make certain the handle is at the top and the one notch in the rear of (F) cover fit over the three prong on the motor housing (H).
- Secure (F) by turning the plastic nut (E) clockwise and tightening firmly.
- Slide the fan blade (C), with the hollow interior of the blade facing towards (F), onto (G).
- Secure (C) onto (G) by turning (B) counterclockwise until it is firmly in place.
- Mount the front grill (A) with the logo in the proper direction and secure (A) and (F) together by fastening eight grill clips. Secure the screw. (Fig. 3)

Step 3: Final Assembly (Fig. 4)

- Loosen the thumb screw (K) by turning it counterclockwise.
- Always keep the water proof cover (M) even with the height adjustable knob (P) when adjusting the internal pole (O).
- Insert (O) into the neck joint and tighten by turning (K) clockwise. Make sure it is tight enough to support the fan head.

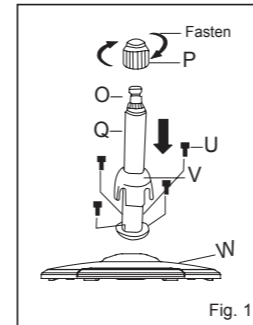

Fig. 1

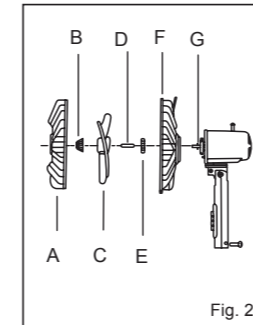

Fig. 2

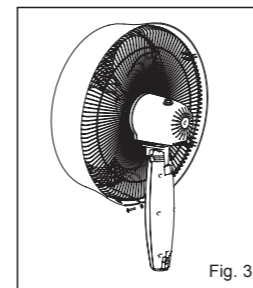

Fig. 3

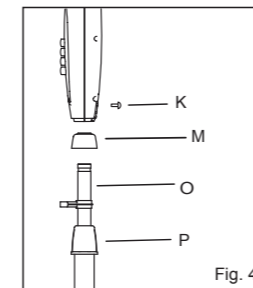

Fig. 4

OPERATING INSTRUCTIONS

- Place the fan on a level surface. Plug the GFCI plug into a standard 120V~ 3-Prong wall outlet.
- To start/stop fan oscillation, push down/pull up the clutch knob (I).
- To adjust the air flow upward or downward, simply tilt the fan head by hand and move to desired angle.
- Control speed by pushing the desired button :
0 - (stop), 1 - low (40W), 2 - medium (45W), 3 - high (54W)
- The height of the fan can be adjusted by loosening the height adjustment ring (P) and carefully raising or lowering the fan and retightening (P).

MAINTENANCE INSTRUCTIONS

The fan requires little maintenance. Do not try to fix it by yourself. Refer it to qualified service personnel if service is needed.

- Do not plug into an electric socket during cleaning or assembly.
- To ensure adequate air circulation to the motor, keep the vents at the rear of the motor housing clear of dust, fluff, etc. Unplug the fan before using a vacuum cleaner to clean the vents. It should not be necessary to disassemble the fan to clean it.
- Wipe the exterior with a soft cloth soaked in a mild detergent.
Do not use any abrasive detergents or solvents to avoid damaging the surface.
Do not use of the following as a cleaner: gasoline, thinner, bending.
- Do not allow water or any other liquid into the motor housing or interior parts.

TROUBLESHOOTING

Problem	Possible Cause	Corrective Action
The fan will not operate.	The fan isn't plugged in and/or the electrical outlet isn't working properly.	Make sure the fan is plugged in and/or the electrical outlet is working properly.
The fan will not operate.	Obstructions are keeping the fan from working.	Check for obstructions. If you find an obstruction, turn the fan off. Unplug the fan and carefully remove the obstruction. Plug the fan in and turn it on again by referring to the operating instructions.

CLEANING

- Be sure to unplug the power cord from the outlet before cleaning.
- Plastic parts should be cleaned with mild soap and damp cloth or sponge. Thoroughly remove soap film with clean water.
- Be sure not to get water or other liquid inside of the motor.

- Water pressure must not exceed 555 153 kPa (5.62 kgf/cm²)
- The hose must be in good condition

LIMITED MANUFACTURER'S WARRANTY

This appliance is covered by a limited manufacturer's warranty. For one year from the original date of purchase, the manufacturer will repair or replace any parts of this appliance that prove to be defective in materials and workmanship, provided the appliance has been used under normal operating conditions as intended by the manufacturer.

Warranty Terms:

During the first year, any components of this appliance found to be defective due to materials or workmanship will be repaired or replaced, at the manufacturer's discretion, at no charge to the original purchaser. The purchaser will be responsible for any removal or transportation costs.

Warranty Exclusions:

The warranty will not apply if damage is caused by any of the following:

- Power failure
- Damage in transit or when moving the appliance
- Improper power supply such as low voltage, defective household wiring or inadequate fuses
- Accident, alteration, misuse or abuse of the appliance such as using non-approved accessories, inadequate air circulation in the room or abnormal operating conditions (extreme temperatures)
- Use in commercial or industrial applications
- Fire, water damage, theft, war, riot, hostility or acts of God such as hurricanes, floods, etc.
- Use of force or damage caused by external influences
- Partially or completely dismantled appliances

Obtaining Service:

When making a warranty claim, please have the original bill of purchase with purchase date available. Once confirmed that your appliance is eligible for warranty service, all repairs will be performed by a NewAir™ authorized repair facility. The purchaser will be responsible for any removal or transportation costs. Replacement parts and/or units will be new, re-manufactured or refurbished and is subject to the manufacturer's discretion.

For technical support and warranty service, please call 1-855-9Newair or email support@newair.com.