



**features & benefits**

*Superb quality at an affordable price makes the Pacific retractable banner stand a great choice. Finished in stylish Anodized Silver with heavy duty molded end plates and a swivel out foot for increased stability. Padded carry bag included.*

*Pacific Silver: PAC-800-S  
Pacific Grande silver: PAC-1000-S*

| hardware specifications                              | graphic specifications   | additional info   |
|--|--|---|
| Pacific: 84" x 31.5"<br>Pacific Grande: 84" x 39.25" | Pacific: Graphic size: 31.5"W x 83.375"H (+ 6" bleed at bottom)<br>Pacific Grande: Graphic size: 39.25"W x 83.375"H (+ 6" bleed at bottom) | Weight 800: 9 Lbs.<br>Weight 1000: 10 Lbs.<br>Shipping dim 800: 36"x7"x5"<br>Shipping dim 1000: 43"x7"x5" |

We are continually improving and modifying our product range and reserve the right to vary the specifications without prior notice. All dimensions and weights quoted are approximate and we accept no responsibility for variance. E&OE.

# Assembly Instructions

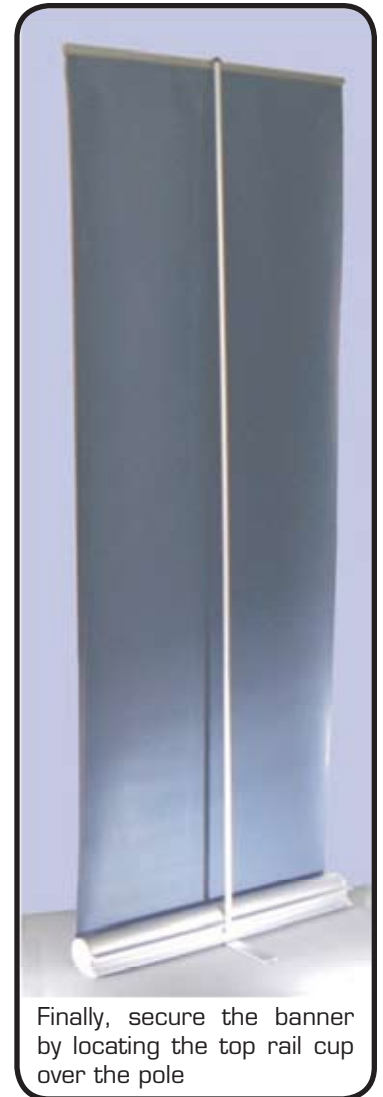
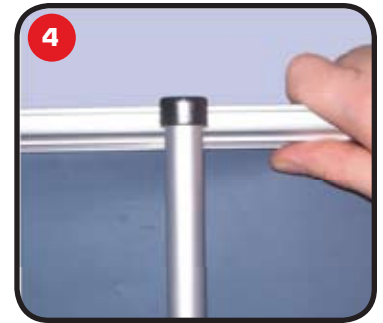
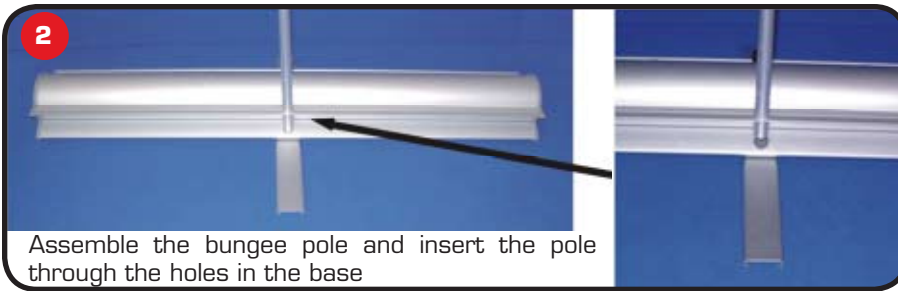
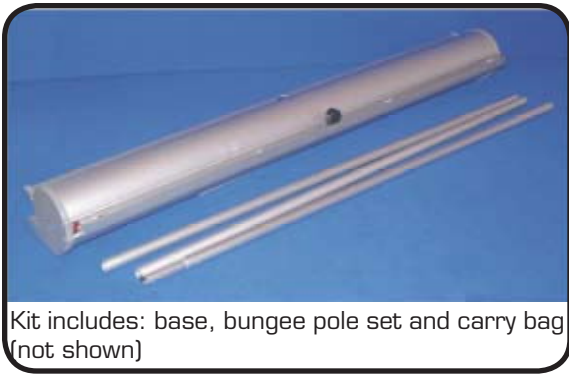

## Guidelines for Graphic Substrates

1. Material thickness must be between 0.0089" and 0.0118" in total
2. The substrate must be pliable and suitable for roller banner stands
3. After fitting, the graphic should be left for 24 hours before use to ensure the adhesive bonds sufficiently

## Notes

1. For loading graphics into the cartridge refer to separate instruction sheet UI095
2. Take care when lowering the banner (do not drop) to prevent damage to the graphic.