



ENDURANCE® P2601
— BUILT TO LAST! —
TILT TOP OVERBED TRAY



It's ESSENTIAL for Good Health!

PARTS

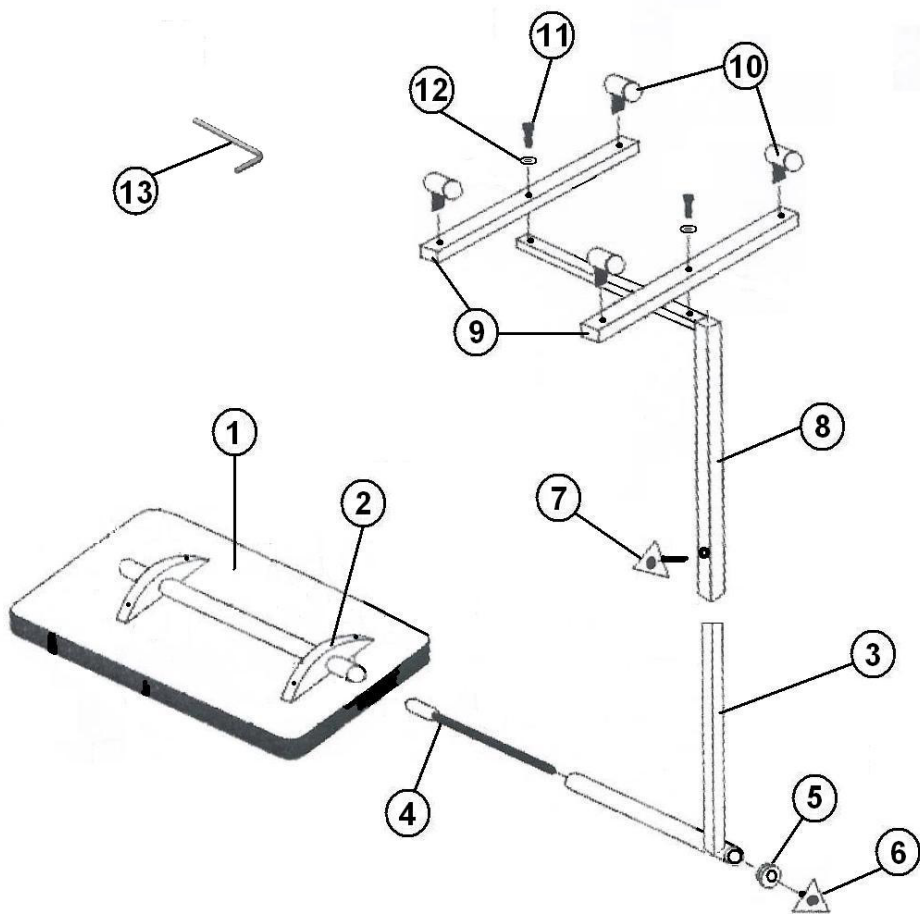

PARTS LIST

- | | | | |
|--------------------------------|----|-----------------------------------|----|
| 1. Table Top | x1 | 8. Table Support..... | x1 |
| 2. Table Mount Bracket | x1 | 9. Castor Support Arms | x2 |
| 3. Table Mounting Arm | x1 | 10. Castor with Lock | x4 |
| 4. Angle Adjusting Screw | x1 | 11. M8 x 1 1/4 x 34mm Socket | |
| 5. Centering Bushing..... | x1 | Head Cap Screw | x2 |
| 6. Angle Adjusting Knob..... | x1 | 12. 8 1/2 x 16 x 1mm Washer | x2 |
| 7. Height Adjusting Knob | x1 | 13. #6 Allen Wrench | x1 |

P2601 OVERBED TABLE

ASSEMBLY INSTRUCTIONS

1. Invert Table Top (1). Slip the Angle Adjusting Screw Assembling (4, 5, 6) of the Table Mounting Arm (3) into the Table Mount Bracket (2) as shown and tighten the Angle Adjusting Knob (6) slightly.
2. Slip the arm of the Table Support (8) over the arm of the Table Mounting Arm (3) and secure it slightly with the Height Adjusting Knob (7).
3. Install Caster Support Arms (9) into horizontal arm of the Table Support (8), using M8 Socket Head Cap Screws (11) and Steel Washers (12) and #6 Allen Wrench (13).
4. Install all four Casters (10) into the Caster Support Arms (9) by pressing them into each hole of the Caster Support Arm (9) until secured in position.
5. Turn the Table assembly right side up and adjust as needed.
6. To adjust the Table Top (1) to desired height, lift the table and when in position, secure it with the Height Adjusting Knob (7).
7. To adjust the angle of the Table Top (10), loosen the Angle Adjusting Knob (6) and turn the Table Top(1) to desired position. Tighten the Angle Adjusting Knob (6) when done.

CAUTION

The Casters with Locks (10) shall be in locked position before using the Table.