

- I Lay **a** on the ground, circle **w** facing up.
- II Insert **c** and **d** pieces. Insert **b** last.

**Note:**  
Every tab has a groove on one side. Every slot has an indent.  
The groove and the indent need to align to work correctly.

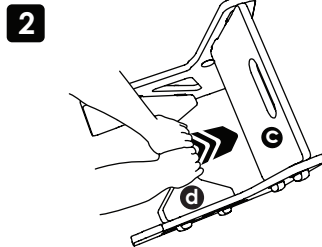
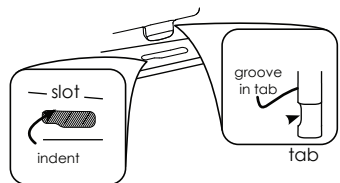

- I Press **d** down to lock Tension tabs.
- II Ensure tabs are pressed securely.
- III **DO NOT lock c yet.**

**Note:**  
Pressing tabs together creates Tension Lock. This will require effort. Stand up, and use your weight to press down.

Press tabs almost to the end, as shown below.

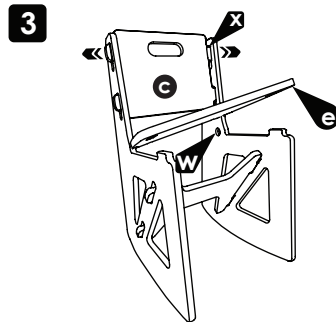
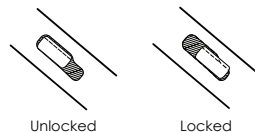

- I Carefully insert **e** at slight angle to fit in holes **w**.
- II Insert **c** tabs into slots **x**. **DO NOT lock c into final position yet.**

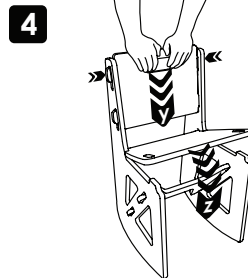

- I Press down on back piece to lock it into place **y**.
- II Press chair sides together again.
- III Securely press seat slots onto tabs **z**.

sprout

www.sprout-kids.com



sqo.so/kra

see online assembly video

& more

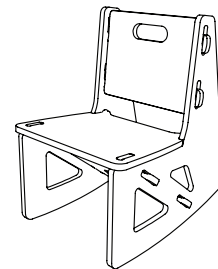

**!** Adult assembly only

**!** Assemble completely before use

For children ages 4-7

Weight capacity 150 lbs

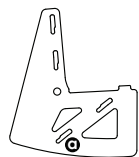

Side  
SD002RX

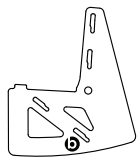

Side  
SD002LX



Back  
HZ002KX



Brace  
HZ009KX



Seat  
TP005KX

## Parts