

# EYHOV workstations

## How to Order

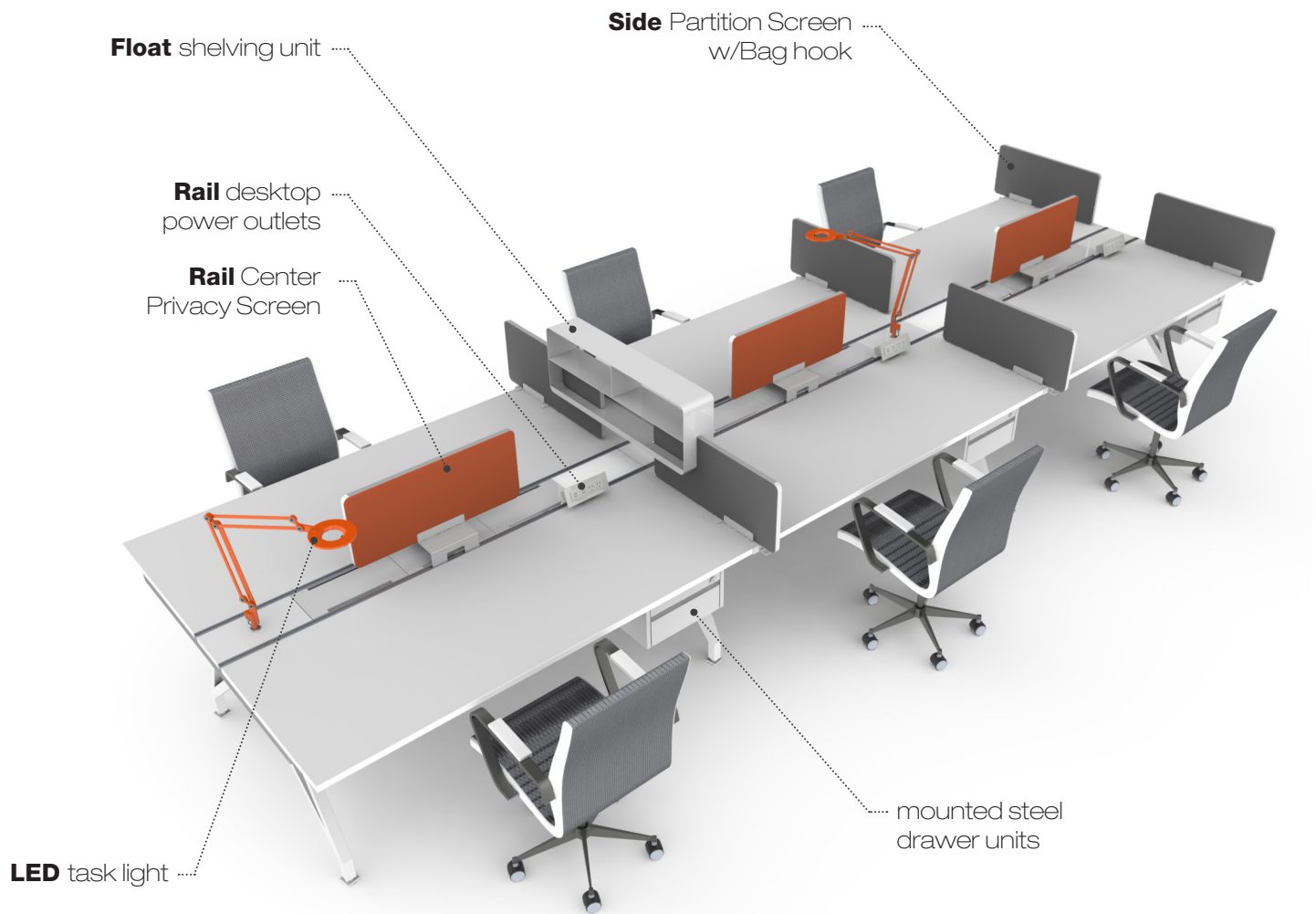

### Step 1:

Select Desk Type: Single or Double  
Select Desk Width: 60" or 72"

### Step 2: Specifying EYHOV desk Configurations

#### EYHOV Single Workstation

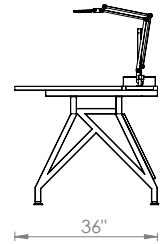
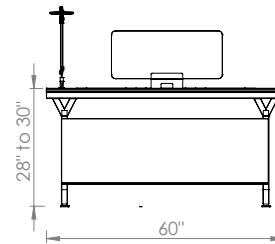
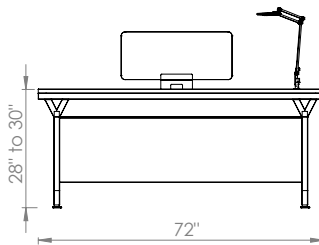
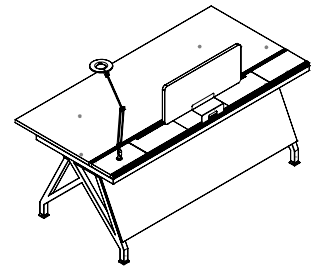

one EYHOV Single Workstation

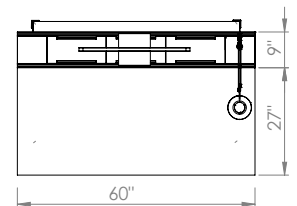
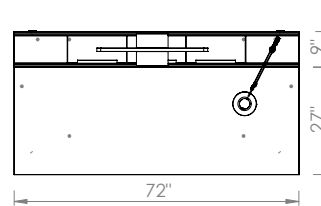

one EYHOV Single Workstation + one (1) UnoMas Single



one EYHOV Single Workstation + two (2) UnoMas Single

\* Uno Mas is an additional desk unit that must be added to an existing full desk. The UnoMas only comes with one leg set, and utilizes the leg set from an existing desk. A customer can buy one EYHOV DOUBLE (OR SINGLE) and purchase additional UnoMas units to add to it. Uno Mas should never be purchased alone.

EYHOV Double Workstation  
 standard width: 60" or 72"

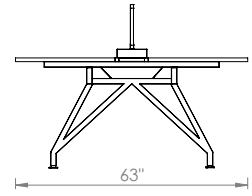
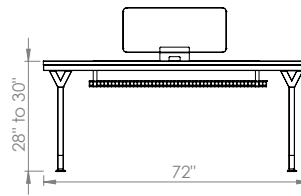
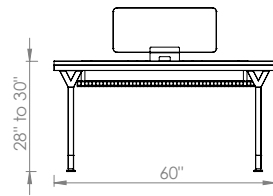
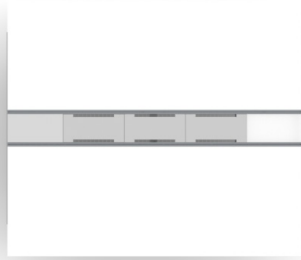
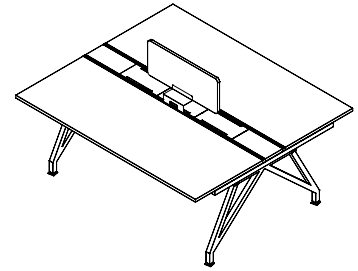

one EYHOV Double Workstation

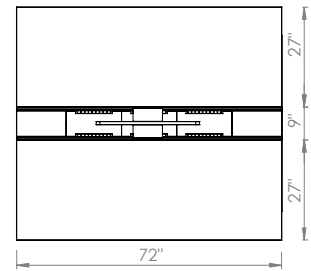
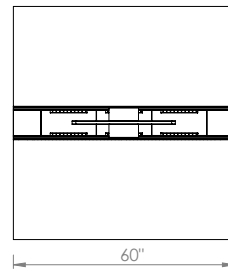
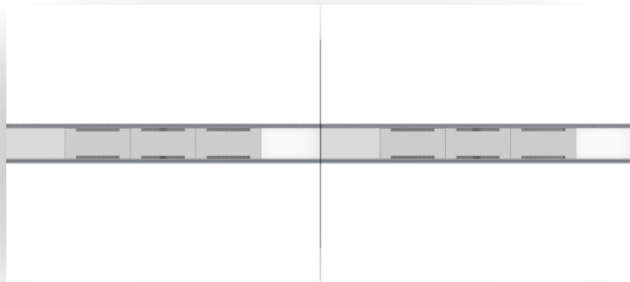

one EYHOV Double Workstation + one (1) UnoMas Double desks

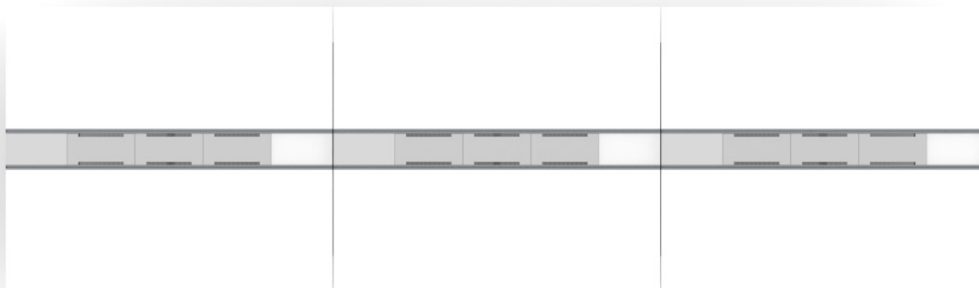

one EYHOV Double Workstation + two (2) UnoMas Double desks

\* Uno Mas is an additional desk unit that must be added to an existing full desk. The Uno Mas only comes with one leg set, and utilizes the leg set from an existing desk. A customer can buy one EYHOV DOUBLE (OR SINGLE) and purchase additional Uno Mas units to add to it. Uno Mas should never be purchased alone.

### **Step 3:** Choose Center Module Type: Rise or Rail

#### **Rail** Center Module



**Rail Features:** Flush mounted low profile unit with 3 powder coated steel access panels and dual aluminum rail system. Rail is the favorite choice of IT professionals as it allows for the ultimate access to wire management through the top of the desk. The aluminum rails enable easy mounting of accessories such as privacy partitions and desktop power outlets.

#### **Rise** Center Module



**Rise Center Module** gives users two file folder storage units that keep paperwork at arms length and while promoting a clutter free work environment. Two wire grommets per user allow for easy cable management. The rise units create a visual and physical separation between desktops .

**Step 4:** Finish Options

**Desktop** Surface Options



**Standard Finishes:** Thermally-Fused Melamine (TFM) surfaces provide an ideal durable work surface. Choose from 4 standard options. Custom finishes available on project basis. **If your design project needs a custom color to, just ask.**

**Accent** Surface Options



**Accent Colors:** Brilliant colors and Greenguard Certified laminates are used for Accent panels and partitions.



**Accent** finish .....  
**Desktop** finish .....  
**Powder** coat .....

**Green To The Core**

A dedication to responsible manufacturing

Scale 1:1 is committed to furthering the production of composite core panels using formaldehyde-free adhesives and other ultra-low emitting resin properties. As a provider of CARB, GREENGUARD and E-Gen certified overlays, Scale 1:1 continues its dedication to responsible manufacturing of 100% pre-consumer recycled wood fiber to help customers achieve LEED project points.

## Step 5: Select Add-Ons

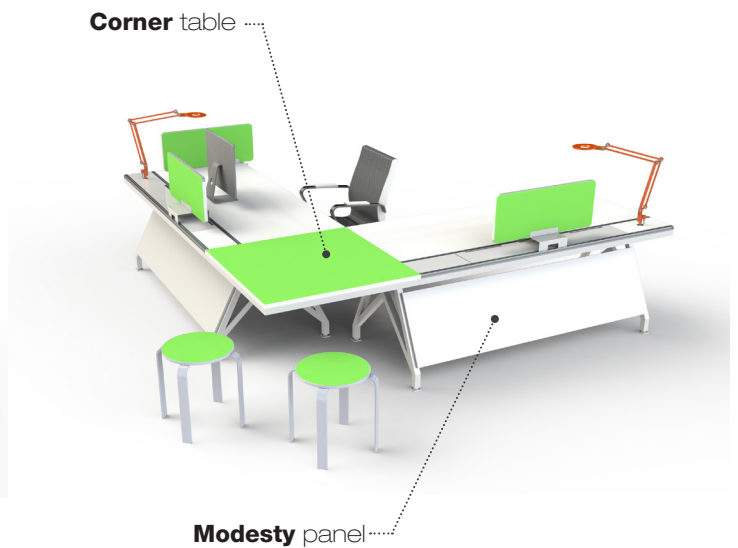
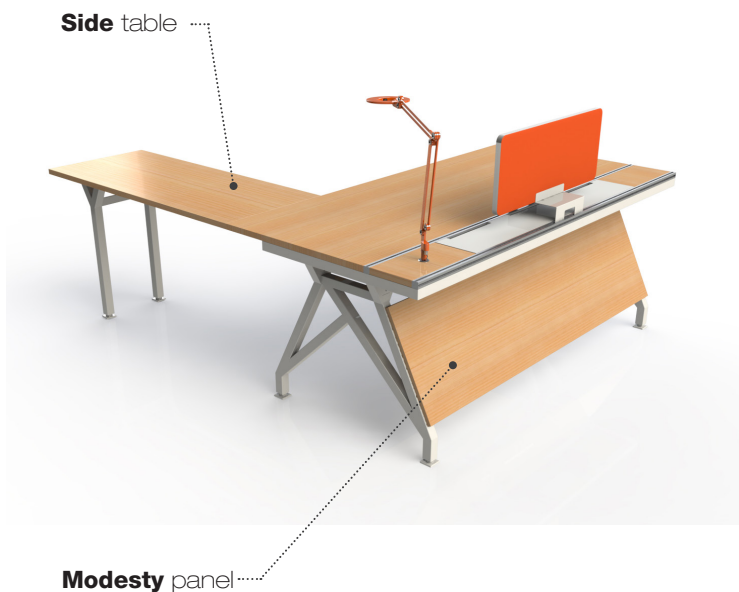
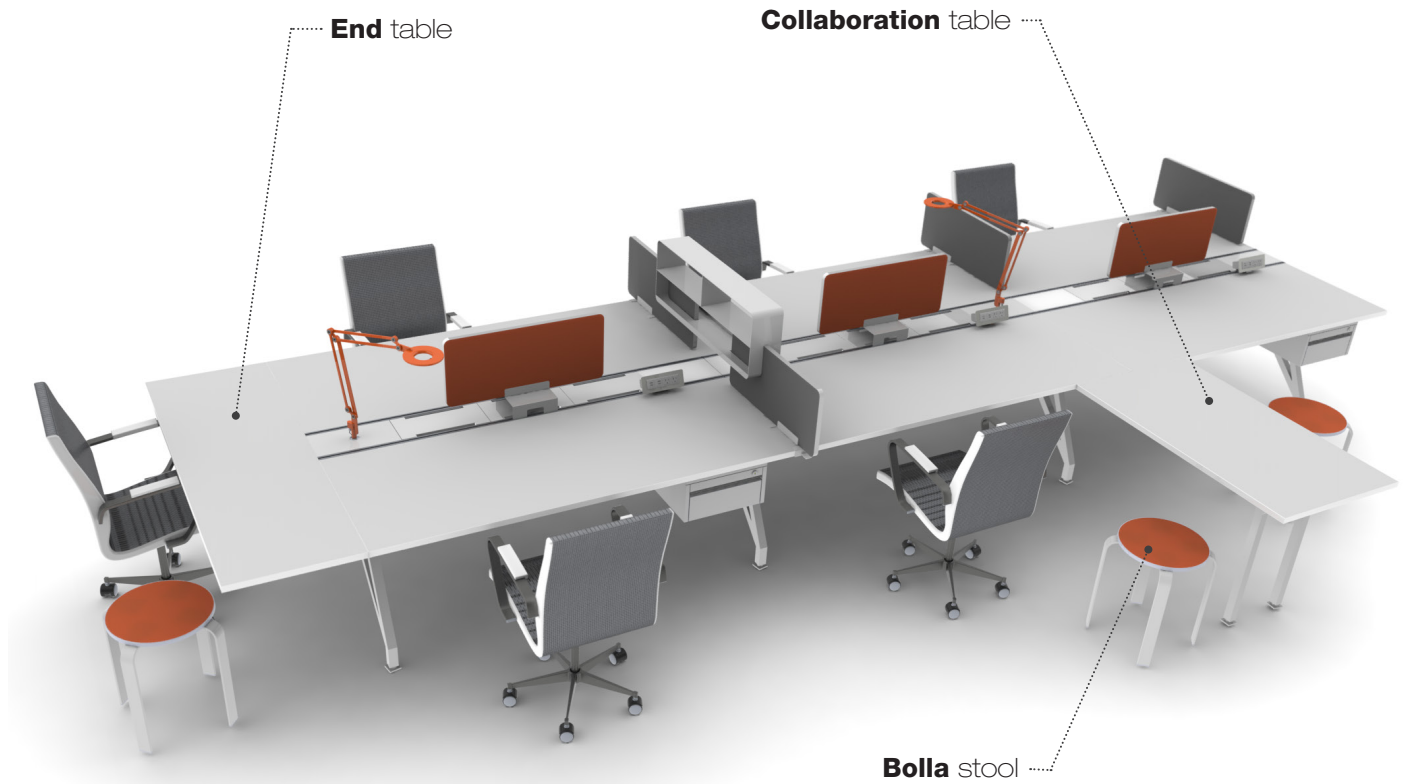

**Note:** All Add-Ons are available in various colors and or sizes. See accessory specifications for details.



## Step 6: Select Accessories

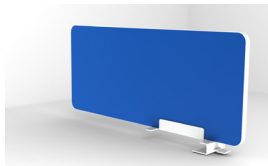
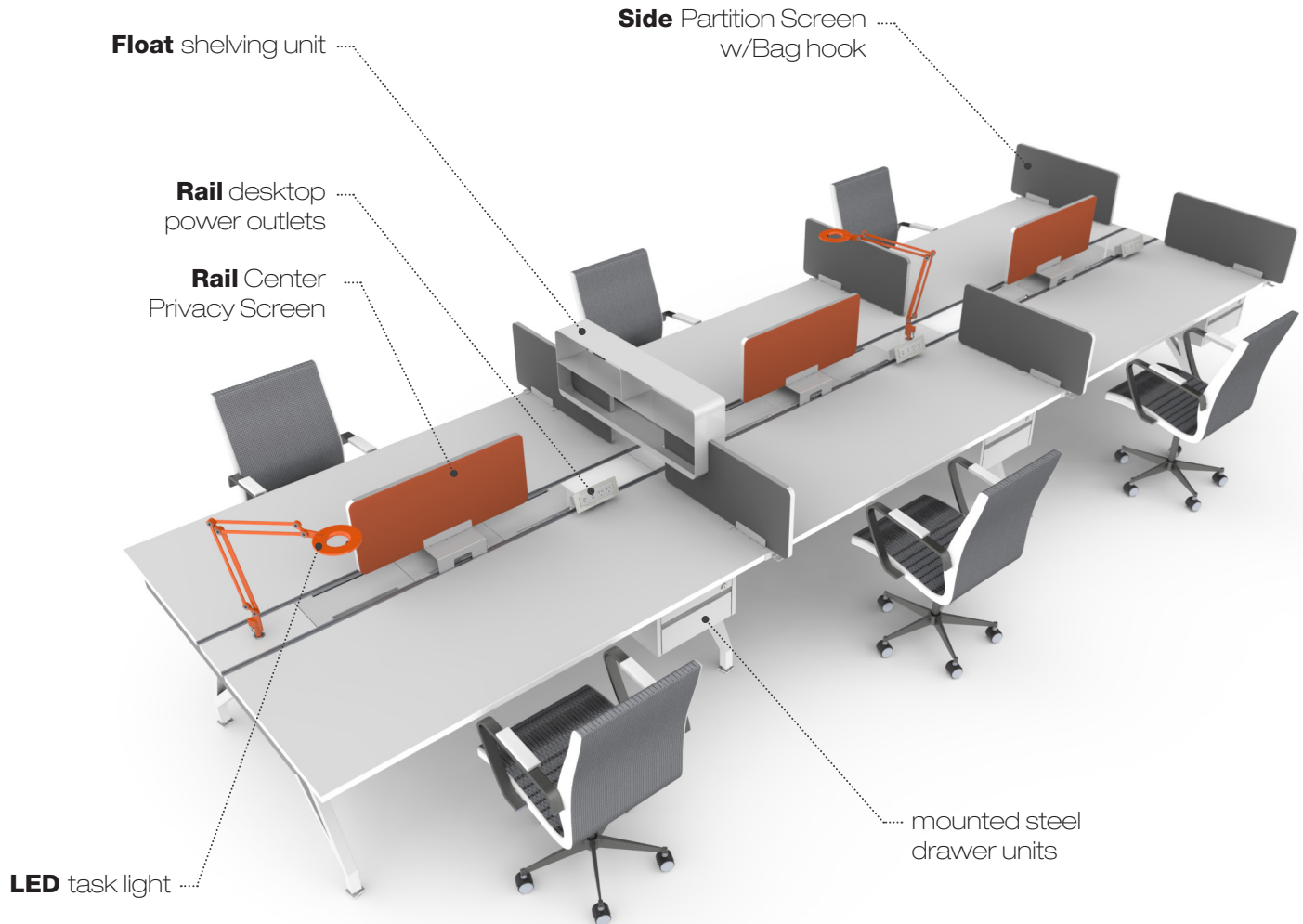

**Side** Partition Screen w/Bag hook



**Rail** Center Privacy Screen

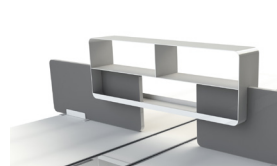

**Float** shelving unit



mounted steel drawer units



**Rail** desktop power outlets



**Rail** desktop power outlets



**Rail** desktop power outlets



**LED** task light

**Note:** All accessories are available in various colors and/or sizes. See accessories specifications for details.

### Configurations Examples

