

Model 580 Contemporary Executive Mesh Chair with Headrest

Parts Listing

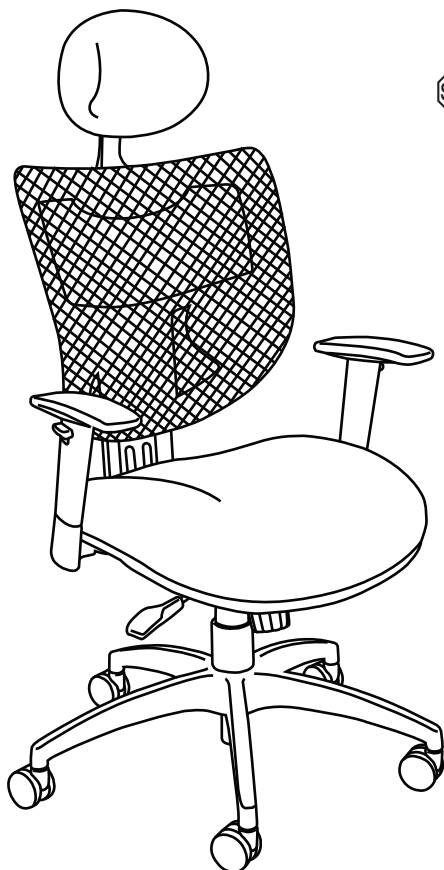

Assembly Instructions

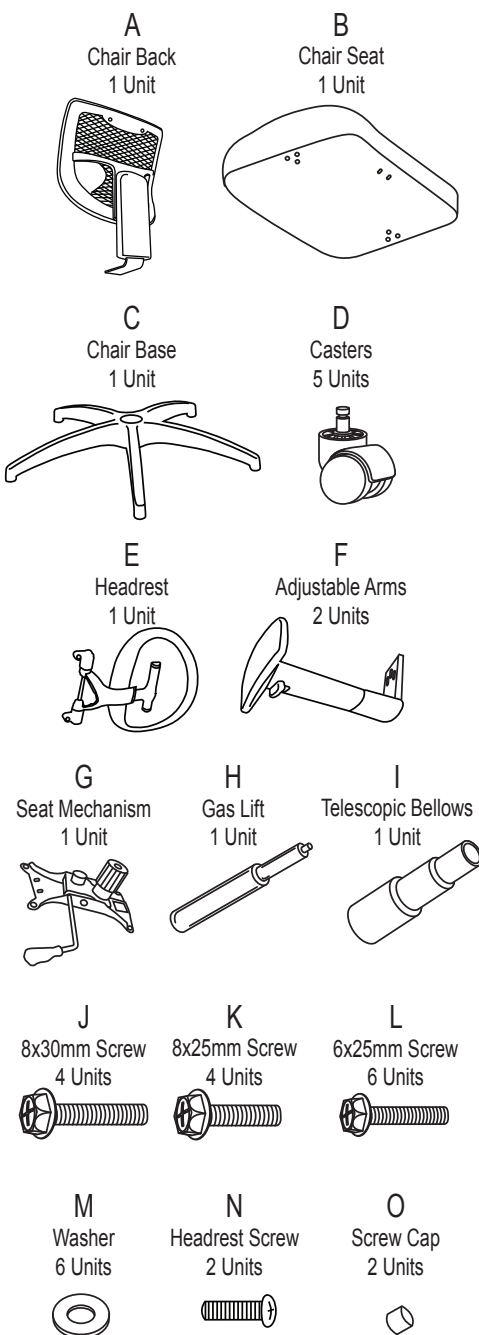

Tools Needed: Phillips Head Screwdriver
Please read all instructions before assembly.

- Step 1:** Insert Casters (D) into Base (C). Insert Gas Lift (H) into Base (C), and cover with Telescopic Bellows (I).
- Step 2:** Place Chair Seat (B) upside-down on a level, non-abrasive surface and align pre-drilled holes in Seat Mechanism (G), with holes in Chair Seat (B). Insert four 8x30mm Screws (J) through the holes in the Seat Mechanism (G) and into the Chair Seat (B).
- Step 3:** Connect Chair Back (A) to Chair Seat (B) by attaching the J-bar on the Chair back onto the bottom of the Chair Seat (B) and Seat Mechanism (G), using three 8x25mm Screws (K).
- Step 4:** Attach Adjustable Arms (F) to the bottom of the Chair Seat (B) by inserting 6x25mm Screws (L) through Washers (M) and through holes in Arms (F) into the holes in the Chair Seat (B).
- Step 5:** Carefully place Chair Seat (B) with attached Seat Mechanism (G) onto the Gas Lift (H) by aligning the hole in the Seat Mechanism (G) with the top of the Gas Lift (H). Carefully sit on chair to make sure the Gas Lift (H) is properly inserted into the Base (C). Operate the Gas Lift Lever on the Seat Mechanism (G) to be sure unit is working.
- Step 6:** Attach Headrest (E) to the Chair Back (A) using two Headrest Screws (N). Cover screw holes with Screw Caps (O).

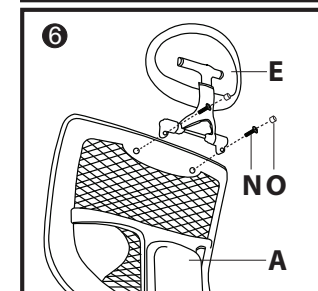
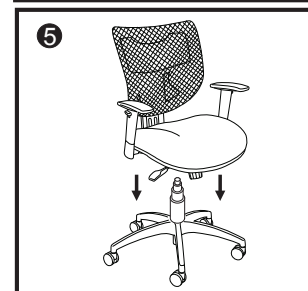
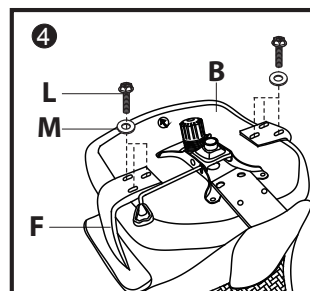
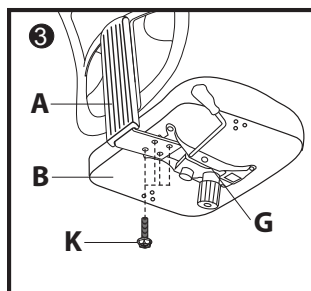
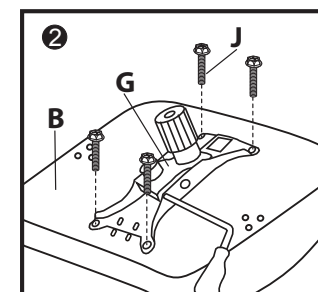
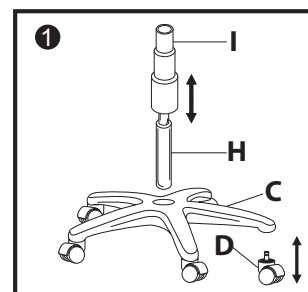

WEIGHT CAPACITY: 250 lbs.

Assembly Notes:

During assembly, hand tighten screw only when all screws are in place, you may then tighten all screws completely.

CAUTION:

1. Do not use this chair as a step ladder.
2. Check for loose screws and tighten them every 6 months.

ofm
Furniture For The Real Office™

161 Tradition Trail Holly Springs, NC, 27540
800-520-7471 (voice) 919-362-4765 (fax)
919-303-6389 (voice) www.ofminc.com
support@ofminc.com