

Model 452 / 453 Upholstered Executive Conference Chair

Parts Listing

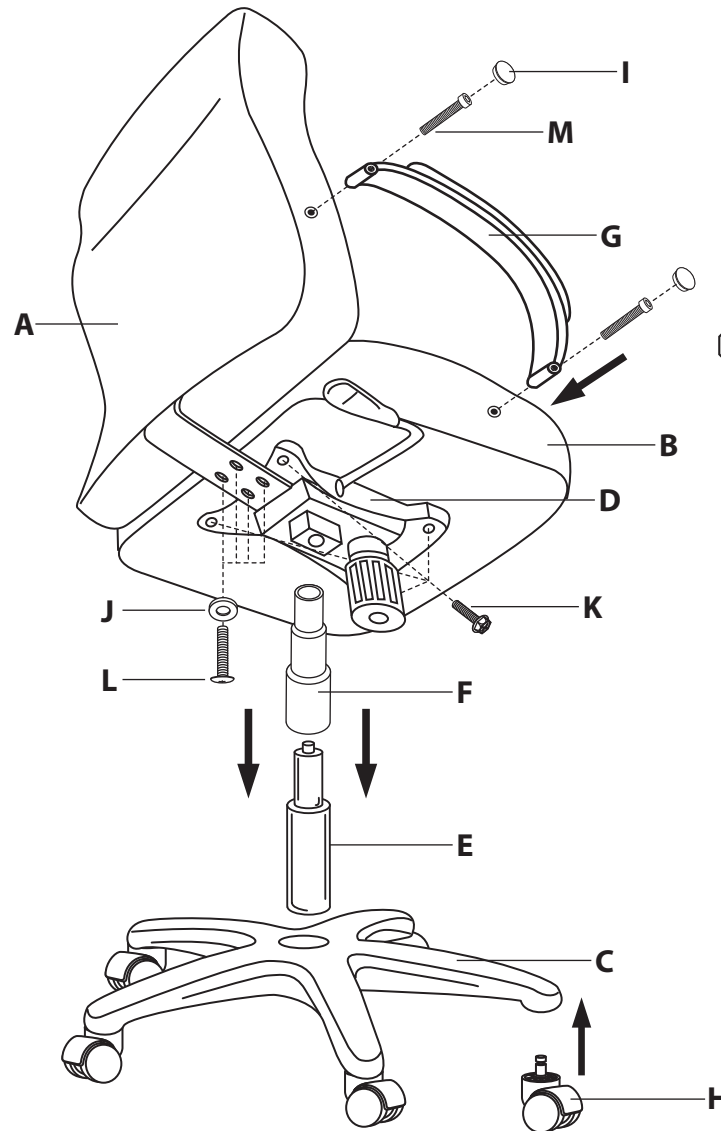
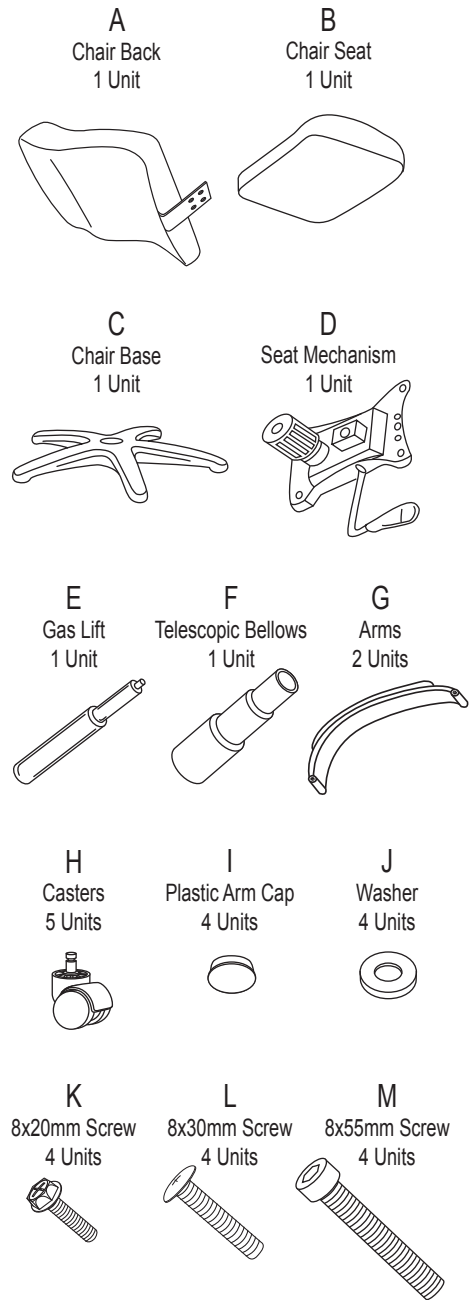

WEIGHT CAPACITY: 250 lbs.

Assembly Notes:

During assembly, hand tighten screw only when all screws are in place, you may then tighten all screws completely.

CAUTION:

1. Do not use this chair as a step ladder.
2. Check for loose screws and tighten them every 6 months.

Assembly Instructions



Tools Needed: Phillips Head Screwdriver
Please read all instructions before assembly.

- Step 1:** Insert Casters (H) into Chair Base (C).
- Step 2:** Insert Gas Lift (E) into the hole in the Chair Base (C), and cover with Telescopic Bellows (F).
- Step 3:** Attach the Seat Mechanism (D) to the underside of the Chair Seat (B) using the 8x20mm Screws (K).
- Step 4:** Place Chair Seat (B) onto the Chair Base (C) by inserting the top of the Gas Lift (E) into the hole in the center of the Seat Mechanism (D). Press down firmly on seat to secure.
- Step 5:** Attach the Chair Back (A) to the assembled seat by inserting 8x30mm Screws (L) through the Washers (J) and into the holes in the Chair Seat (B) and Seat Mechanism (D).
- Step 6:** Attach the Arms (G) to the assembled chair by inserting 8x55mm Screw (M) through the holes in the Arms (G) and into the sides of the Seat (B) and Back (A).
- Step 7:** Cover screw holes in the sides of the Arms (G) with the Plastic Arm Caps (I).

ofm^U_Z
Furniture For The Real Office™

161 Tradition Trail Holly Springs, NC, 27540
800-520-7471 (voice) 919-362-4765 (fax)
919-303-6389 (voice) www.ofminc.com
support@ofminc.com