

Model Number		Contract Number		Inspector number	
--------------	--	-----------------	--	------------------	--

	Present in parcel	Quality Checked
Top		
Left Facing Cross Rails		
Right Facing Cross Rails		
Inner Seat Support Rails		
Outer Seat Support Rails		
Seat Legs		
Upper Seat Legs		
Seats		
Cross Rail Centre Plate		
Hardware Bag		
Assembly Instructions		

Signed _____

Date _____

Trial Assembly Made	
Yes	No

FOLD 1



ALEXANDER ROSE ASSURANCE OF QUALITY

Thank you for choosing to buy Alexander Rose Garden Furniture. We are confident that you will be pleased with the quality of the product. To ensure that the highest standards are maintained, please help us by completing this short questionnaire.

Garden Centre Purchased From: _____ Purchase Date: _____

(Tick Boxes)

	Good	Average	Poor
Condition of Packaging			
Ease of assembly			
Condition of Product			

Home Address

Other Comments

For information on all our products including treatments available please visit our website: www.alexander-rose.co.uk

Thank you for taking the time to complete and return this questionnaire, and for choosing Alexander Rose

**Alexander Rose Ltd.
Alexander House
Victoria Road
BURGESS HILL
West Sussex
RH15 9LE**

Affix
Postage
Stamp

TAPE THIS EDGE

ALEXANDER ROSE 305 SIX SEATER BELFRY PICNIC TABLE ASSEMBLY INSTRUCTIONS

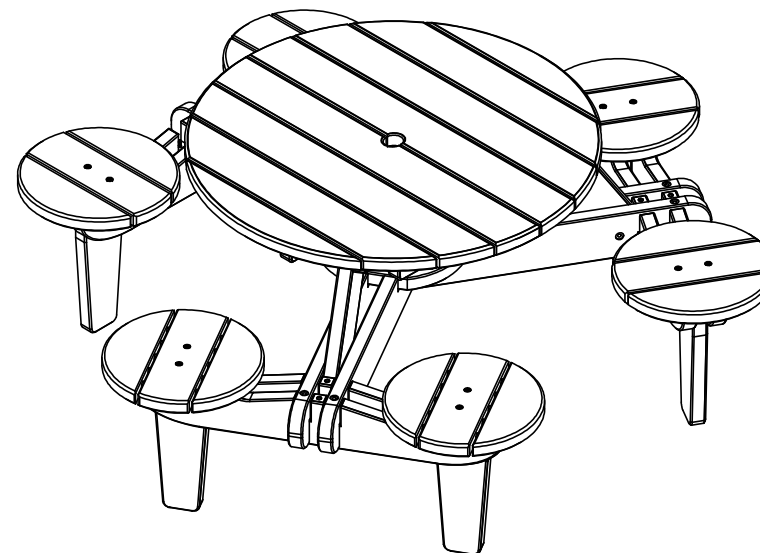

READ IN FULL BEFORE USING THIS PRODUCT

This product is very heavy. two people are required for assembly and moving
Product Information

Your furniture is manufactured using FSC pine from Europe. This is treated with preservative to protect against decay, giving a lifespan in excess of ten years.

Under normal circumstances Pine cracks; this is due to its natural characteristics and will not compromise the strength of your furniture, which is designed with this in mind.

Softwoods are prone to weather staining/blackening caused by moisture activating mould spores present naturally in the wood.

Cleaner should remove this blackening.

We strongly recommend a twice yearly application of a water repellent preservative such as Cuprinol to protect against fungal attack and blackening of the wood

Maintenance

Your furniture can be cleaned using soapy water and stiff brush. More severe stains such as spillages, bird droppings, mildew and blackening of the wood etc. can be removed using Alexander Rose Cleaner or sanding using a medium grit sand paper.

Lifting grain or cracks can be glued using a waterproof adhesive suitable for timber. Clamping may be necessary with excess glue being removed with a damp cloth. The area should be sanded once the glue is dry.

Important Safety Notice

This Picnic Table is VERY HEAVY and requires at least TWO PEOPLE for assembly and THREE PEOPLE when moving. Dragging your table may cause damage to the legs. **ALWAYS LIFT the table when moving**

PLEASE RETAIN THESE ASSEMBLY INSTRUCTIONS FOR FUTURE REFERENCE.

ref: ARL-305 - 6 Seater Belfry Picnic Table 04-08-09

ref: ARL-305 - 6 Seater Belfry Picnic Table 04-08-09

Component Identification

Before starting to assemble your furniture, identify and count all components of your chosen model, as shown in the table and drawings below. In the unlikely event that any components are missing or damaged, please contact the retailer where you purchased this product.

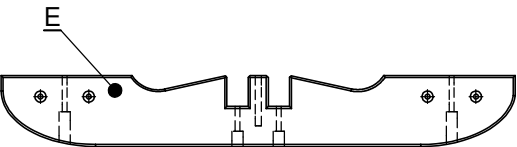
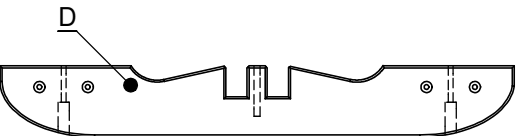
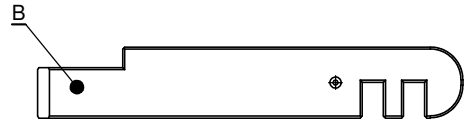
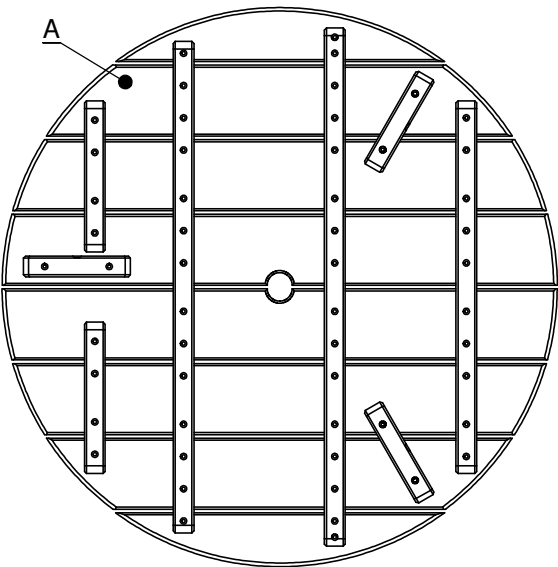

Code	Description	Qty
A	Top	1
B	Left Facing Cross Rails	3
C	Right Facing Cross Rails	3
D	Inner Seat support rails (with pre fitted inserts)	3
E	Outer Seat support rails (without pre fitted inserts)	3
F	Seat Legs	6
G	Upper Leg Rails	3
H	Seats	6
I	Cross Rail centre plate	1
J	Long M8 Allen Bolts	45
K	Short M8 Allen Bolts	3
L	5mm Allen Key	1

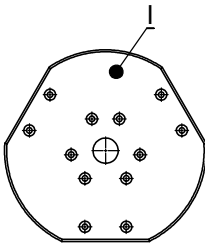
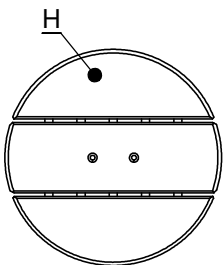

Step 6 - Seat Bases

Attach Seat Bases using Long Allen Bolts

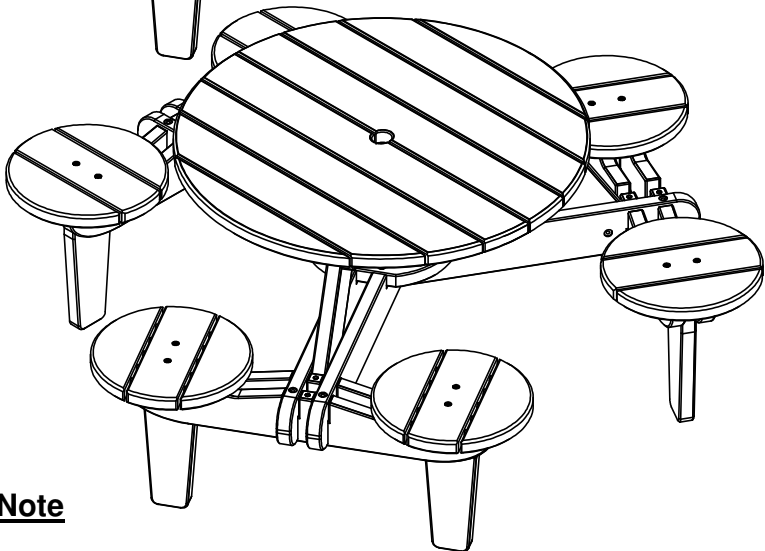
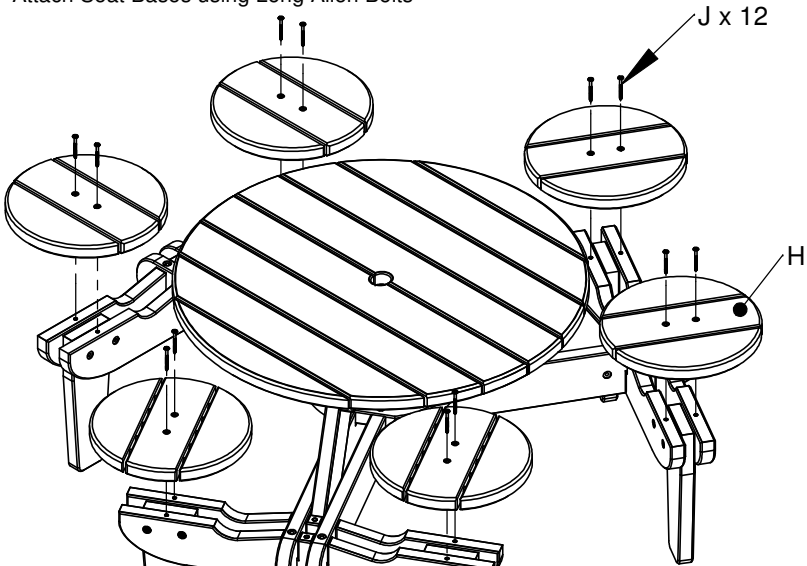

Important Safety Note

This picnic table is VERY HEAVY and requires at least TWO PEOPLE for assembly and Moving

Always Lift The Table When Moving

Dragging your table may cause damage to the legs. ALWAYS LIFT the table when moving

PLEASE RETAIN THESE ASSEMBLY INSTRUCTIONS FOR FUTURE REFERENCE

Step 1 - Attach legs to seat support rails

Attach the seat support rail (without pre-fitted thread inserts) to two seat legs and a seat support rail (with pre-fitted thread inserts) using four long allen bolts, noting that the larger diameter holes in both types of seat support rails face the outside as indicated. **DO NOT TIGHTEN BOLTS FULLY YET**

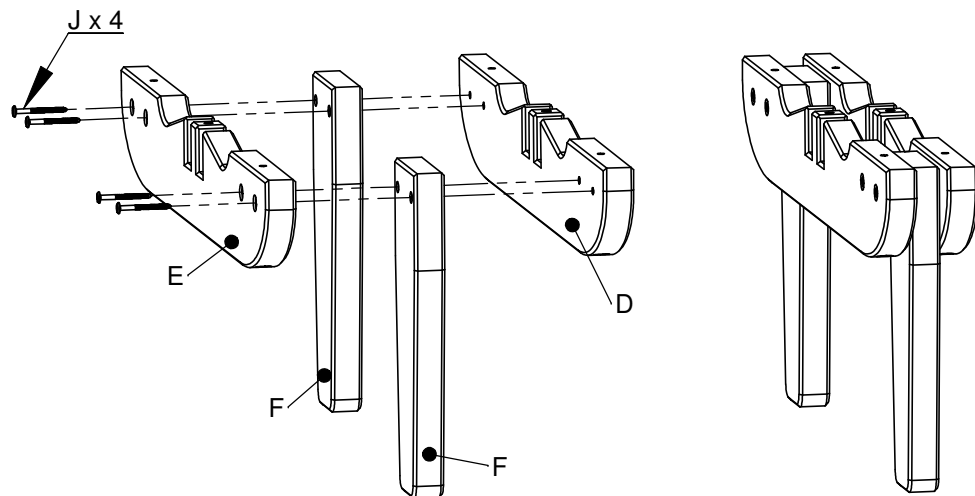

Repeat this procedure with the other two sets of legs

Step 2 - Attach Cross rails to Cross rail centre plate

Attach left and right hand cross rails to the cross rail centre plate, using the long allen bolts

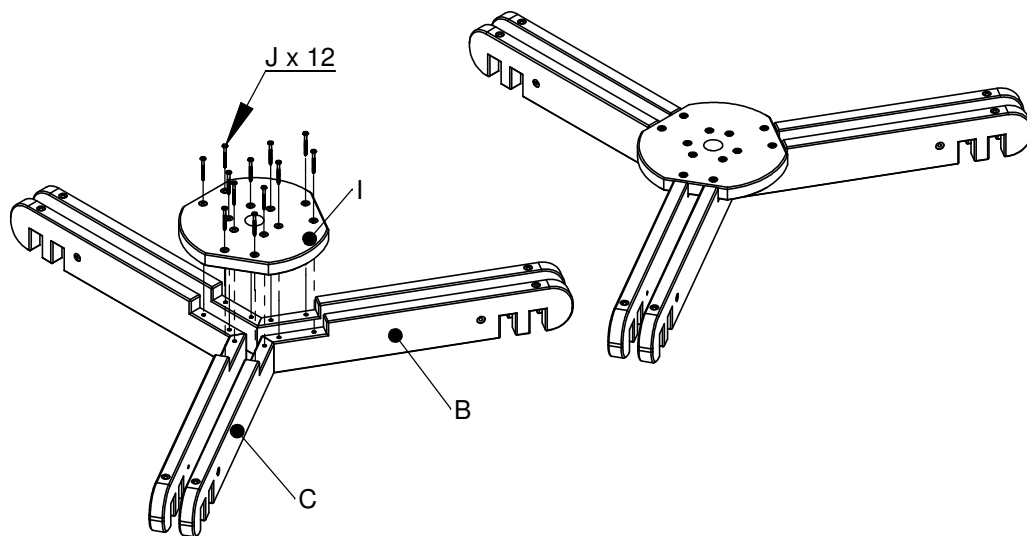

Step 5 - Attach Table Top to Upper Legs

Attach the Table Top to the Upper Legs using Short Allen Bolts

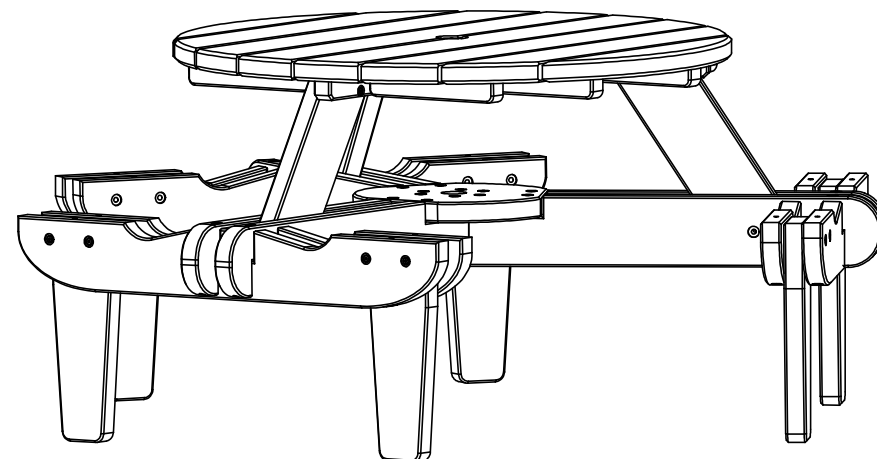
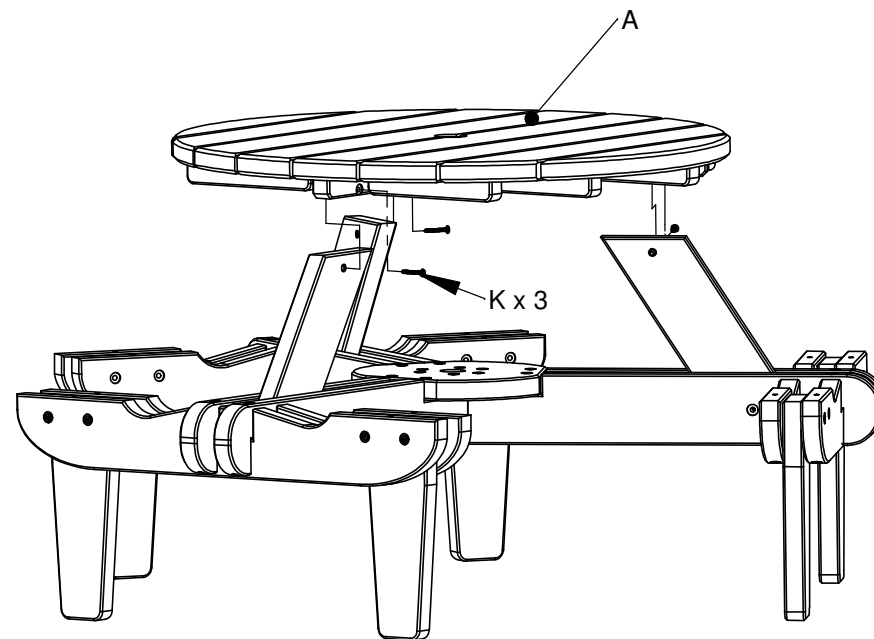

Step 3 - Attach legs to Cross rails

Attach Leg assemblies to cross rail assembly using long allen bolts

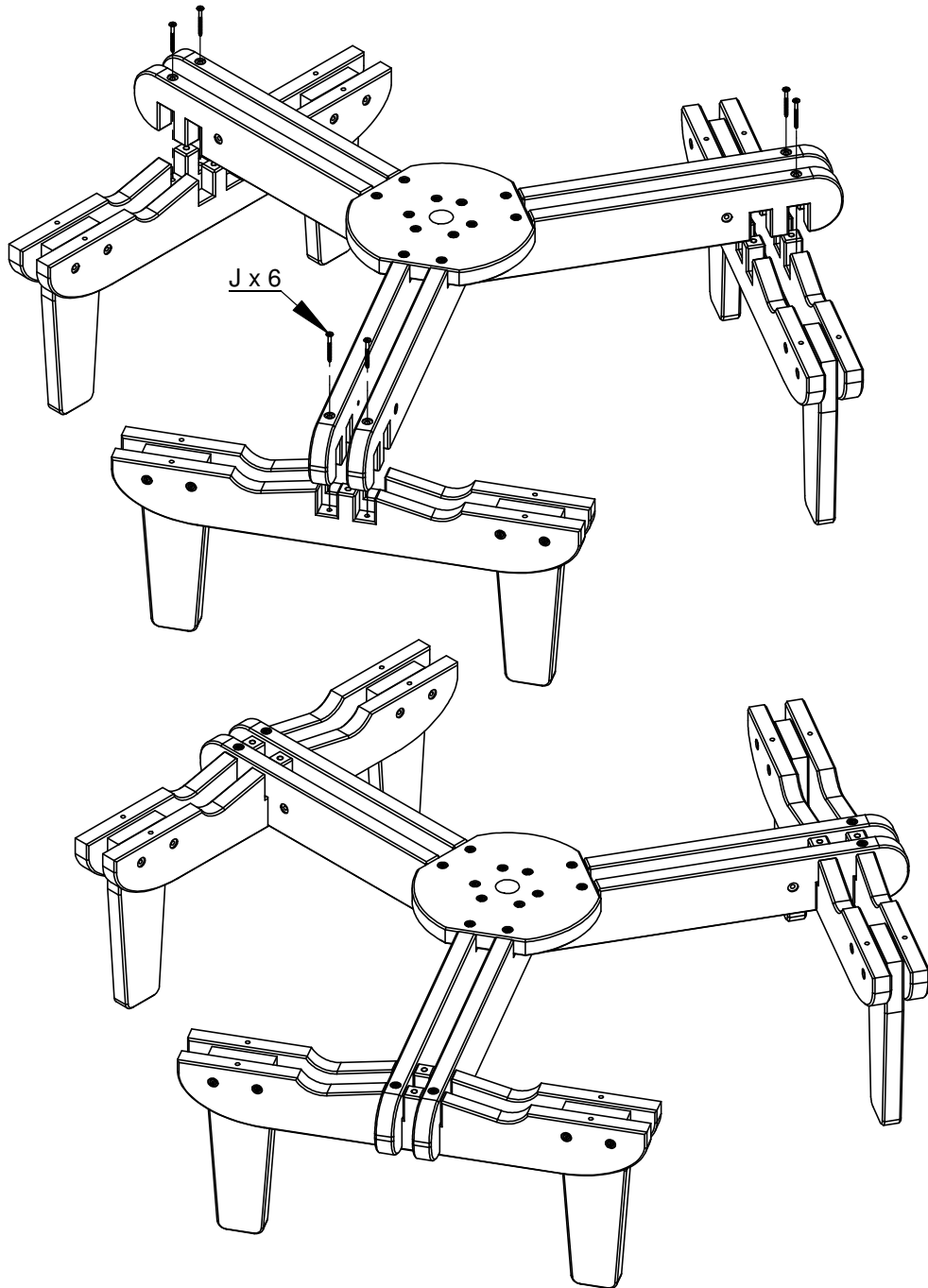

ref: ARL-305 - 6 Seater Belfry Picnic Table 04-08-09

Step 4 - Attach Upper legs to Cross rails

Attach Upper Legs to cross rail assembly using long allen bolts

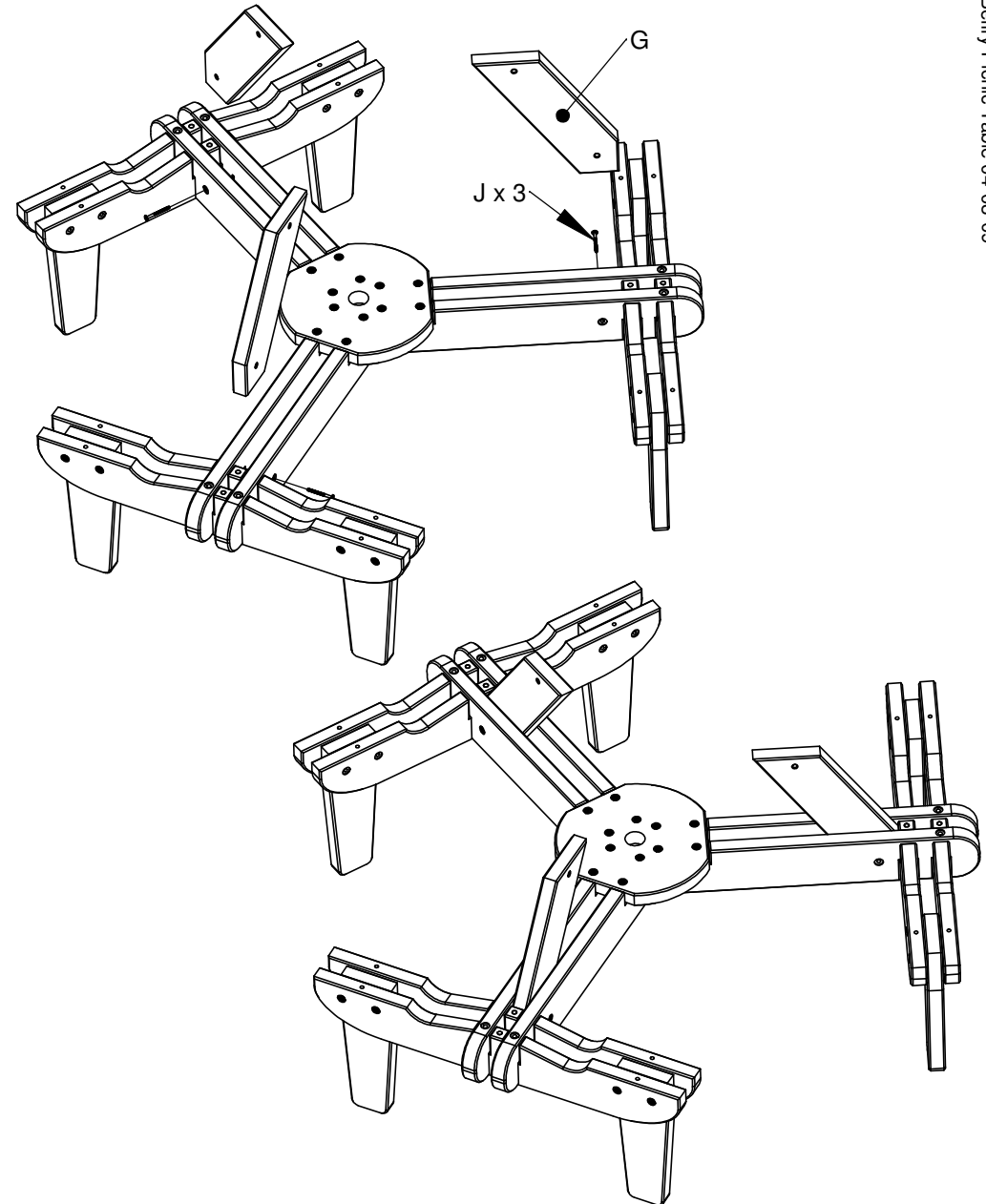

ref: ARL-305 - 6 Seater Belfry Picnic Table 04-08-09