



WORKCENTRE

MODEL #103305NS

ASSEMBLY INSTRUCTIONS

Black & Decker and the Black & Decker logo are trademarks of the Black & Decker Corporation and are used under license. All rights reserved.

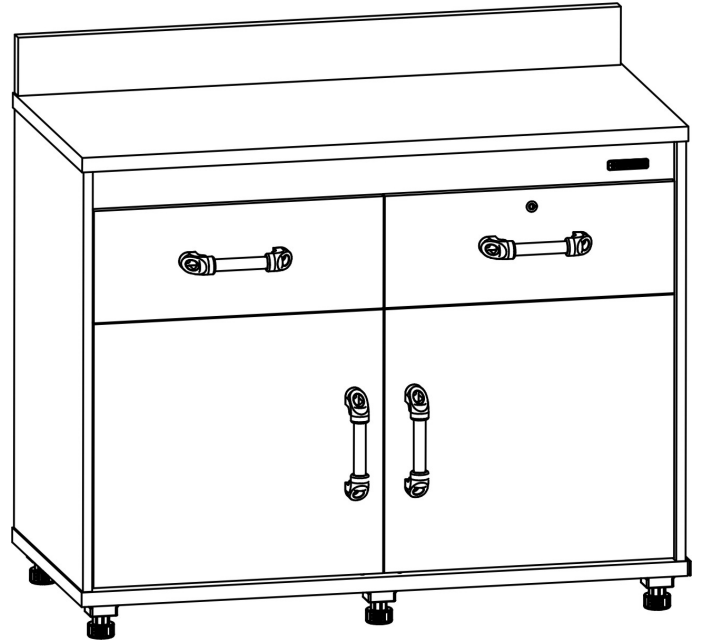

POSTE DE TRAVAIL

MODÈLE #103305NS

INSTRUCTIONS D'ASSEMBLAGE

La mention Black & Decker et le logo Black & Decker sont des marques de commerce déposées de Black & Decker Corporation et sont utilisés en vertu d'une licence. Tous droits réservés.



To replace missing or damaged parts, or in case of any other difficulty with this product, please call toll free:

1-800-668-0490 (Canada & U.S.A. Only)

For a service rep. call between 9 am - 5 pm EST. Monday - Friday.

Required Tools: - #2 Phillips and flathead screwdrivers, hammer, wrench or pliers.

BEFORE STARTING: Identify all panels and hardware from "Parts List" on pages 2 & 3. The letters used to identify the panels do not appear on the actual items. To identify actual panels, note the position of the pre-drilled holes and their relative size and shape. To protect finished surfaces from damage during assembly, use a carpeted surface.

Pour remplacer des pièces manquantes ou endommagées ou pour toute autre difficulté au sujet de ce produit, veuillez composer sans frais: **1-800-668-0490 (Canada et États-Unis seulement)**

Pour contacter un représentant de service, appelez du lundi au vendredi, entre 9:00 et 17:00 hres - H.N.E.

Outils requis : Tournevis Phillips # 2, tournevis à tête plate et marteau, clé ou pinces.

AVANT DE COMMENCER: Identifiez tous les panneaux et la quincaillerie énumérés dans la "Liste des pièces", aux pages 2 et 3. Les lettres utilisées pour l'identification des panneaux n'apparaissent pas véritablement sur les pièces réelles. Pour identifier chacun des panneaux, il faudra prendre note de l'emplacement des trous pré-usinés. Afin d'éviter d'endommager le fini des surfaces durant l'assemblage, utilisez une surface recouverte de tapis.

PARTS LIST / LISTE DES PIÈCES

Hardware Kit / Quincaillerie

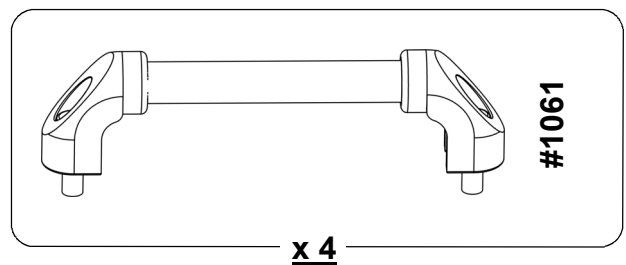
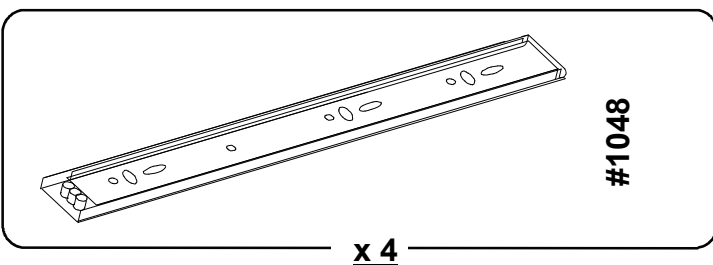
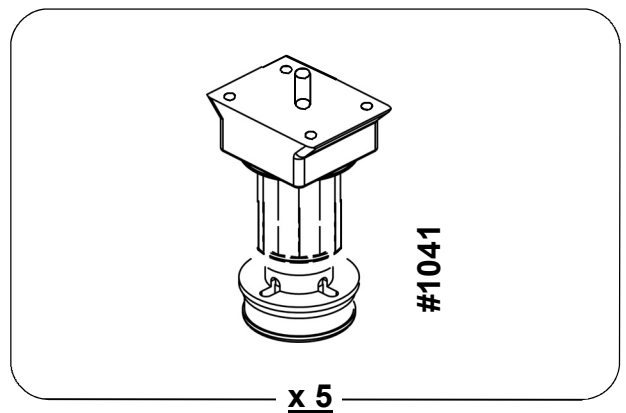
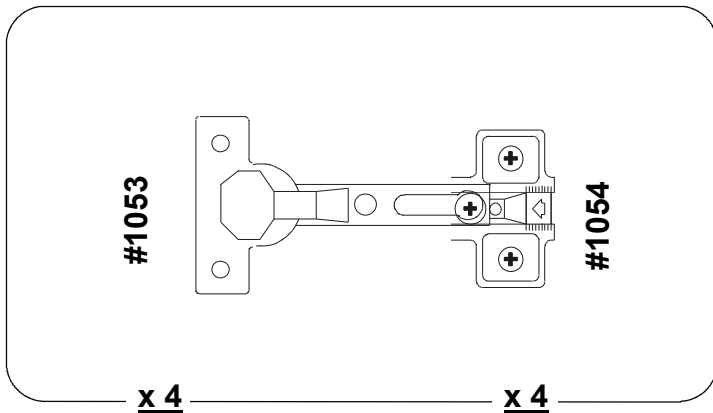
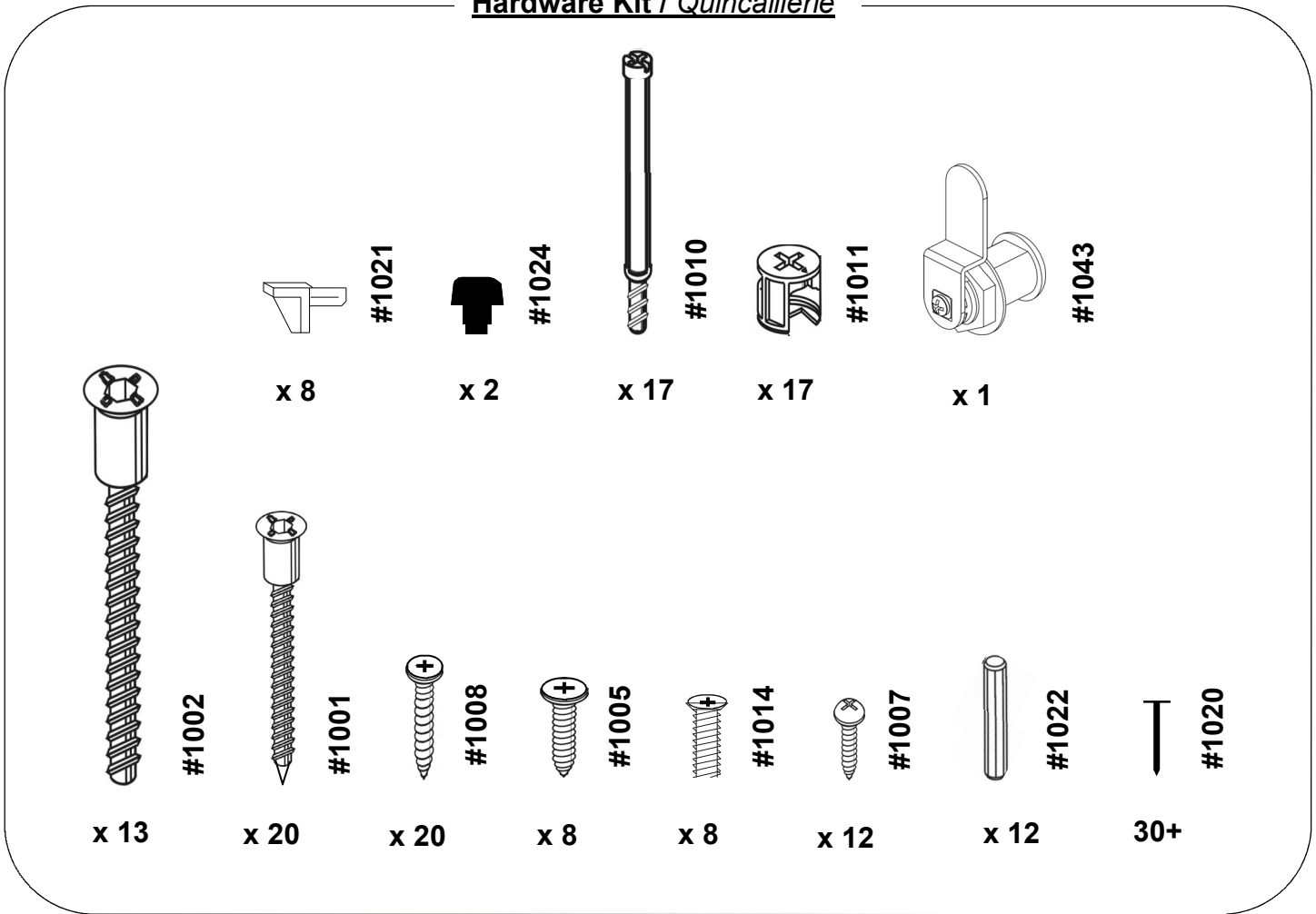

Panel Identification / Panneaux

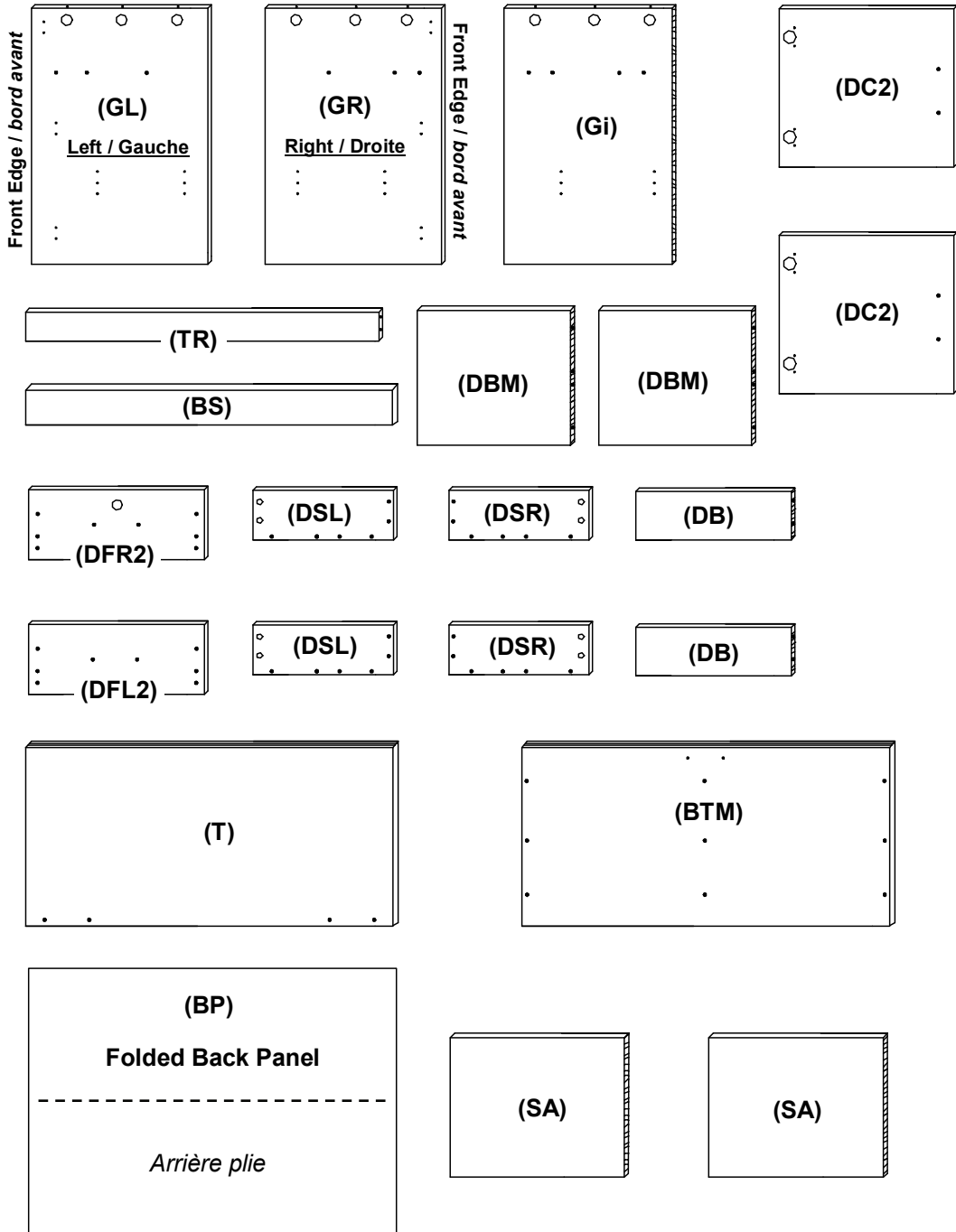

Tools Required: / Outils requis :

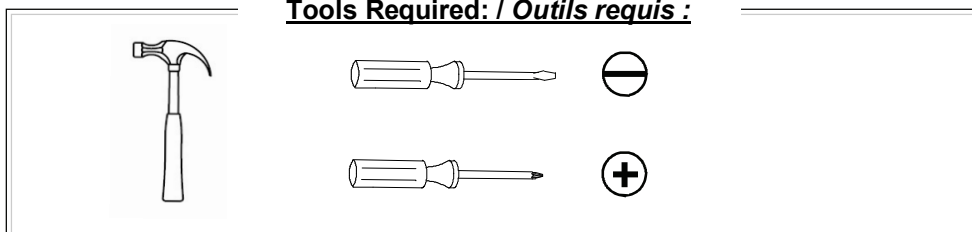

1a

- Attach Drawer Slides #1048 to **both sides** of (Gi) panel. See Steps #1a and 1b.
- On this side, attach slides using the 1st and 3rd holes on slides and panels.

- *Le tiroir d'attache glisse aux deux côtés du panneau (Gi). Voir les étapes #1a et 1b.*
- *De ce côté, attachez les glissières utilisant les 1ers et 3èmes trous sur des glissières et des panneaux.*

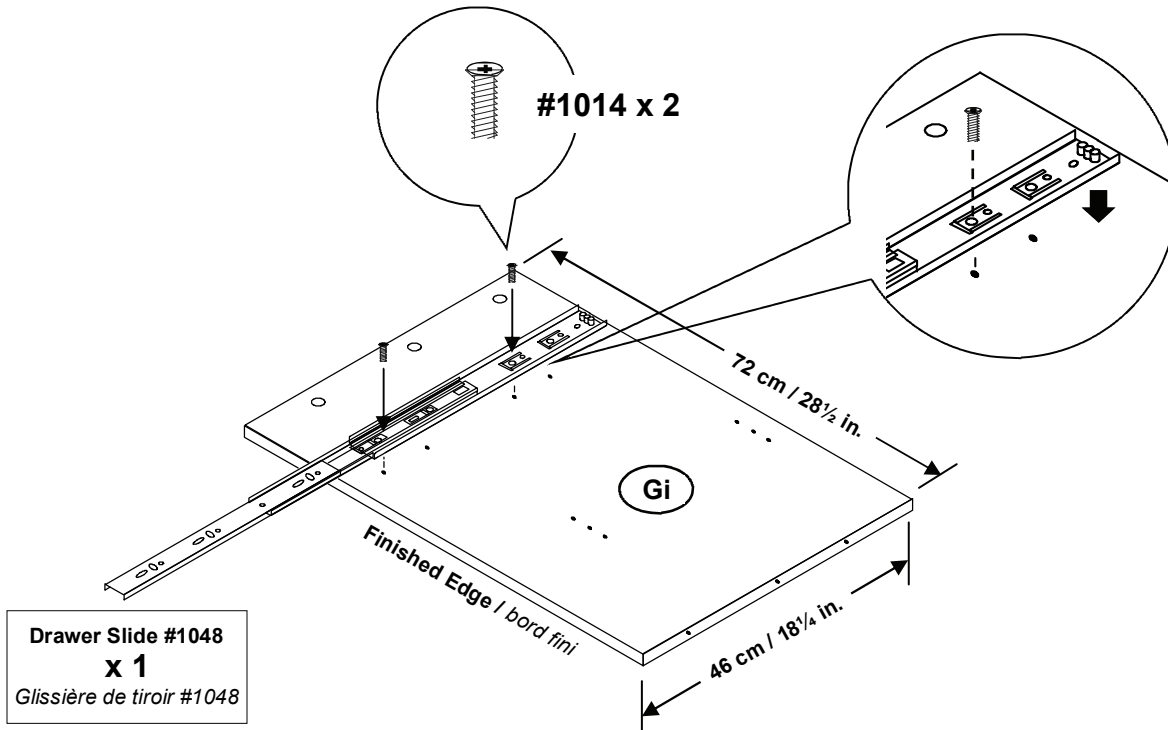

1b

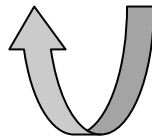

TURN PANEL OVER
Faites tourner le panneau

- **Turn panel over.**
- On other side, attach slide using the 2nd and 4th holes on slide and panel.

Drawer Slide #1048
x 1
Glissière de tiroir #1048

- ***Faites tourner le panneau.***
- *De l'autre côté, attachez la glissière utilisant les 2èmes et 4èmes trous sur la glissière et la lambrissez.*

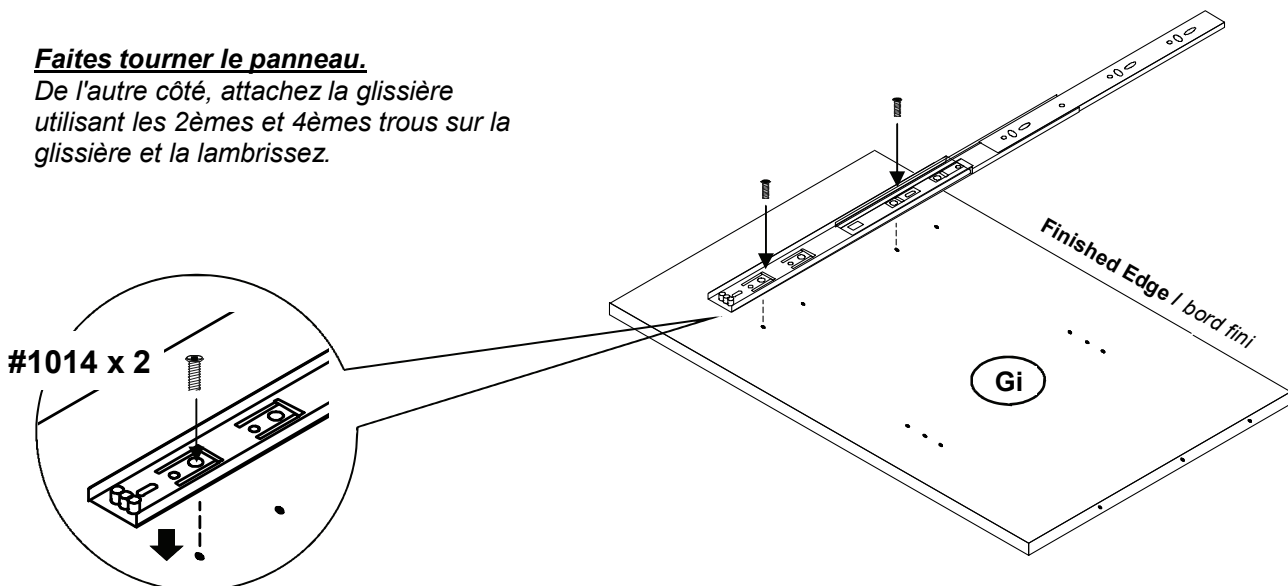

2

- To attach Drawer Slides #1048 to side panels, extend rails out fully to see holes in rail that match holes in panels. Secure with screws.

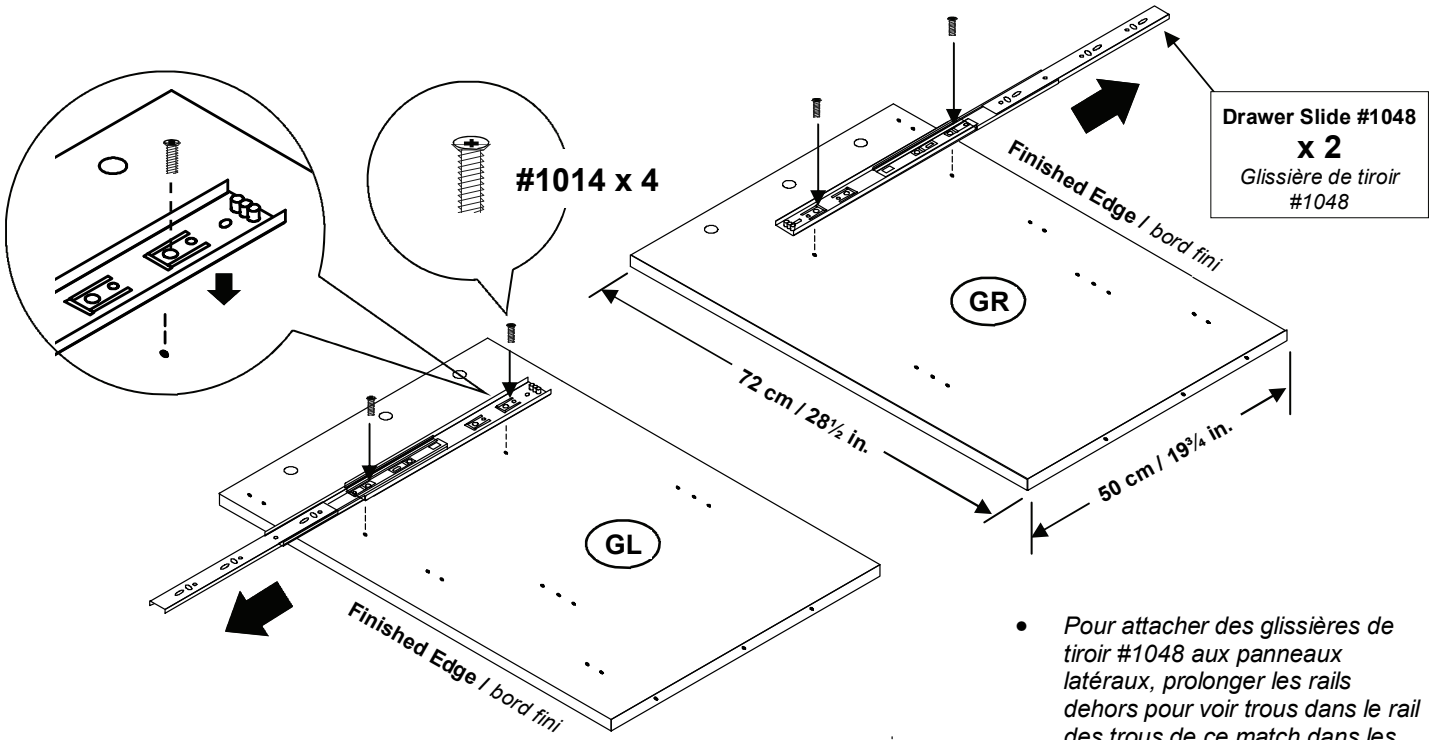

- Pour attacher des glissières de tiroir #1048 aux panneaux latéraux, prolonger les rails dehors pour voir trous dans le rail des trous de ce match dans les panneaux. Fixer avec des vis.

3

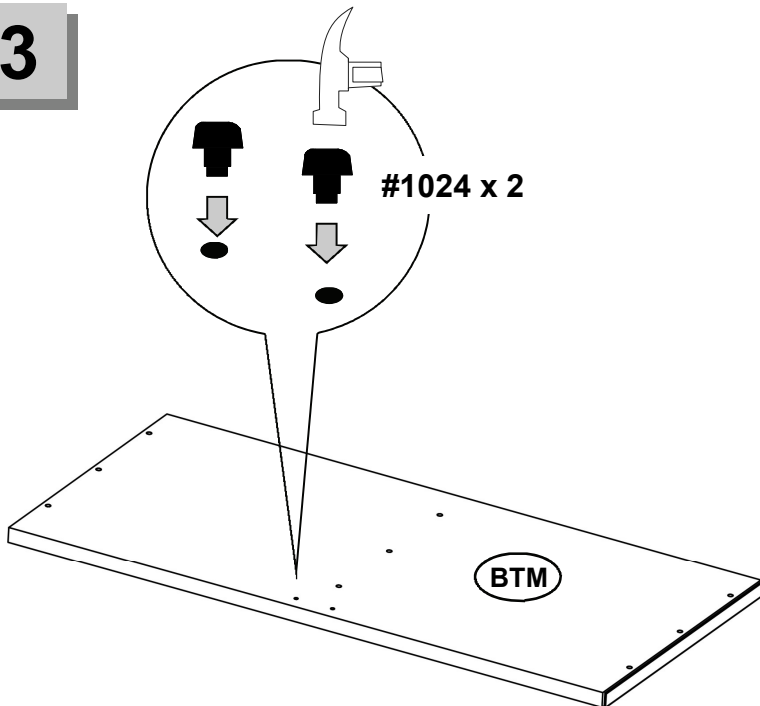

4

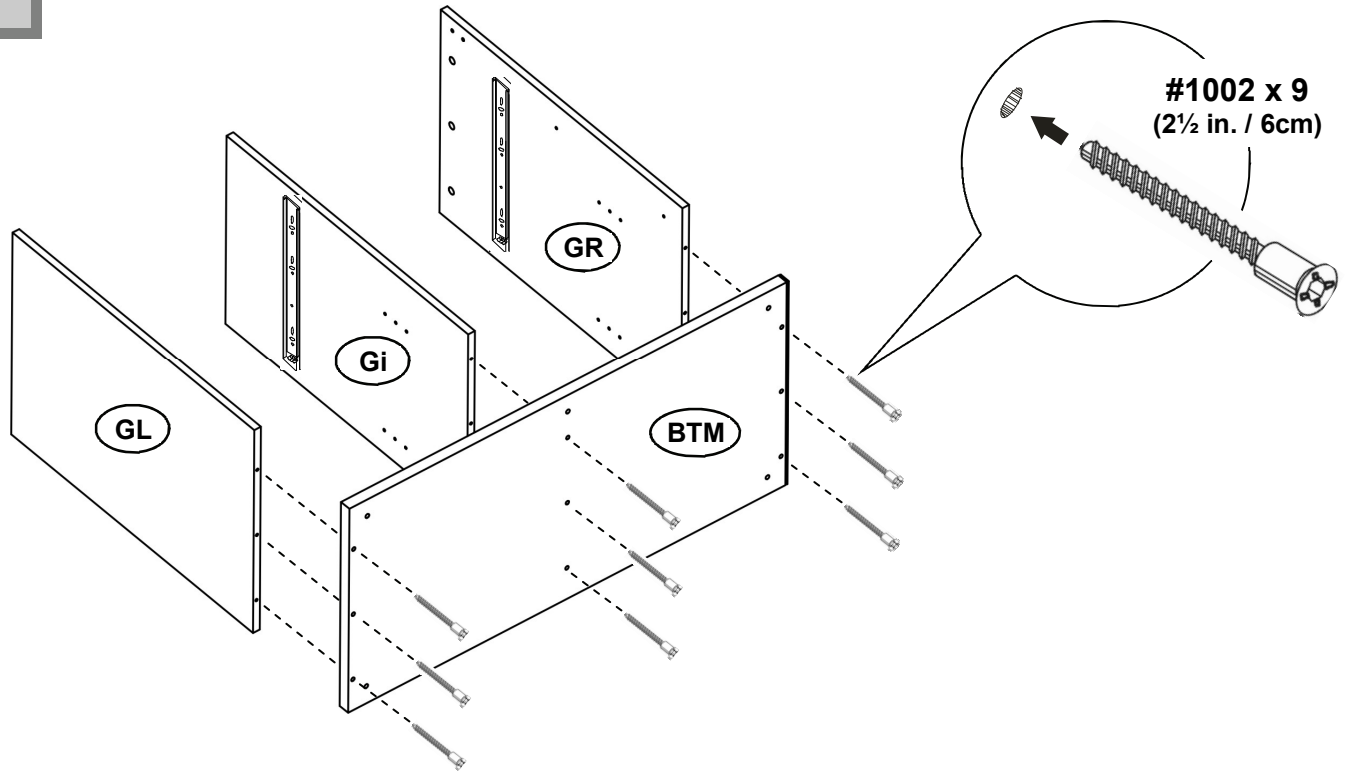

5

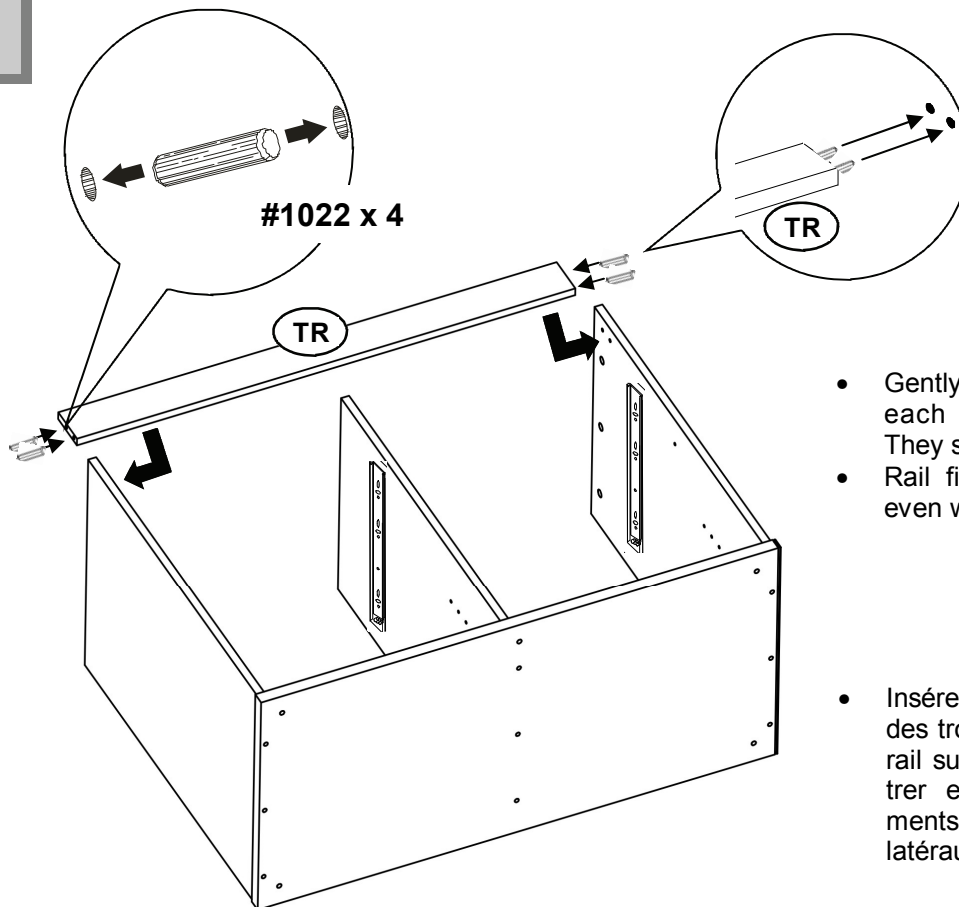

- Gently tap 2 dowels into holes in each end of Top Rail (TR). They should go in about halfway.
- Rail fits between the side panels even with the top edge.

- Insérez doucement 2 chevilles dans des trous dans chaque extrémité du rail supérieur (TR). Ils devraient entrer environ à mi-chemin. Ajustements de rail entre les panneaux latéraux.

6

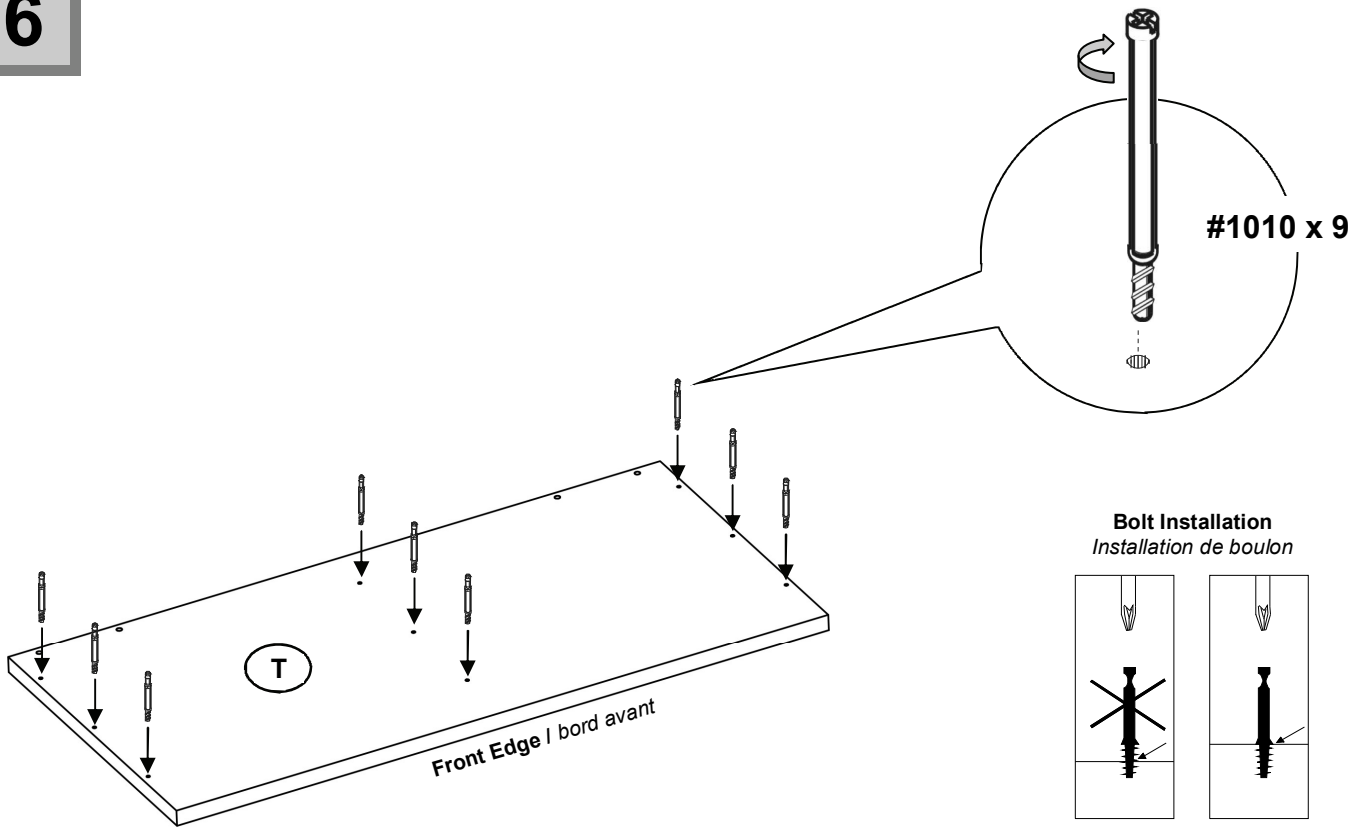

7

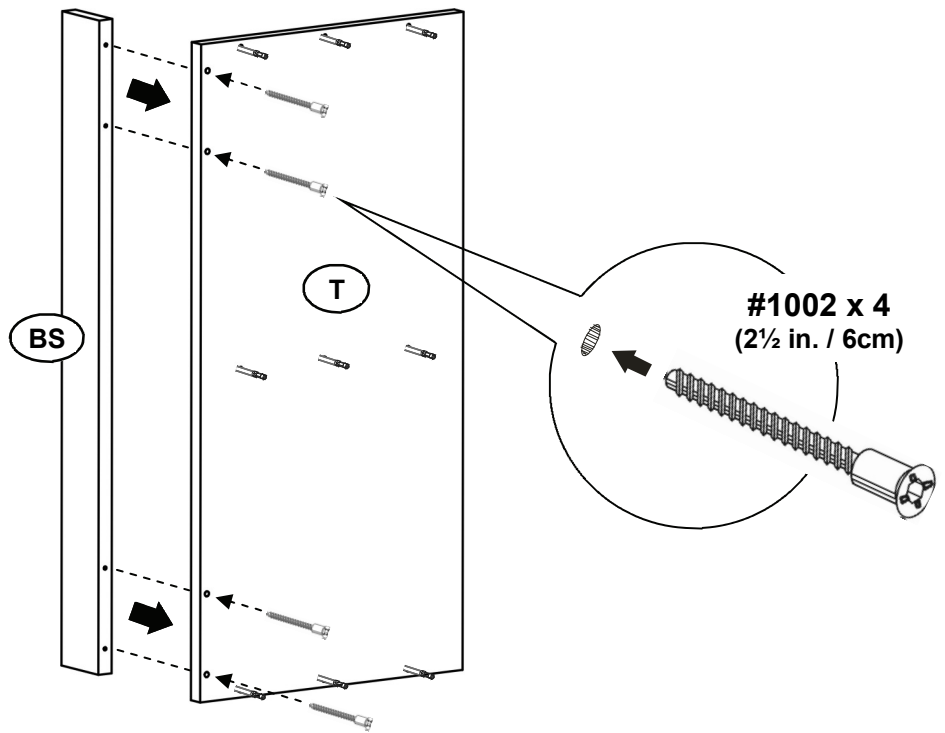

8

- Press cams into holes.
- Aim "arrow" on cam to hole in edge.
- Attach panels together.
- Tighten cams with flathead screwdriver.

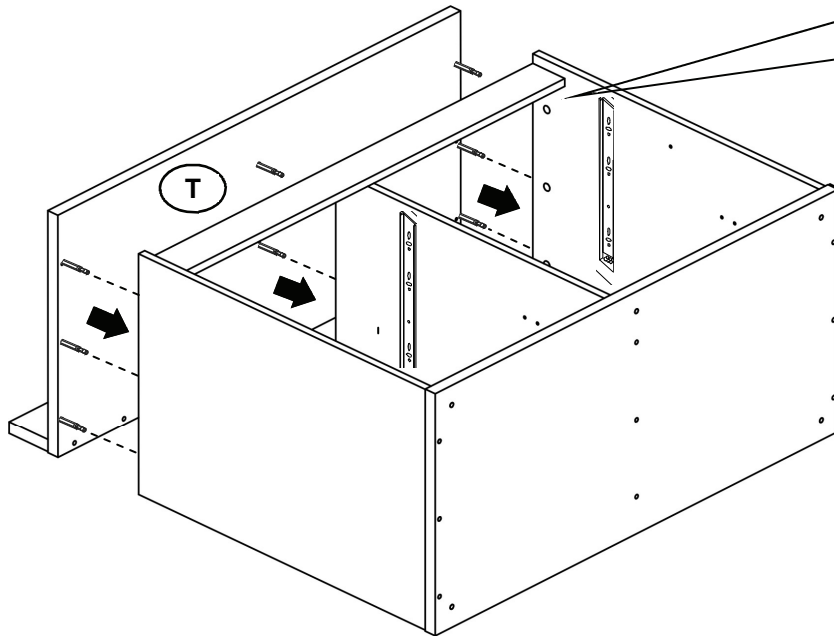

#1011 x 9

- *Pressez les anneaux dans des trous.*
- *Visez la « flèche » sur la came pour trouer en bord.*
- *Attachez les panneaux ensemble.*
- *Serrez les cames avec le tournevis à tête plate.*

9

Turn to adjust foot height
Tourner pour ajuster la taille de pied

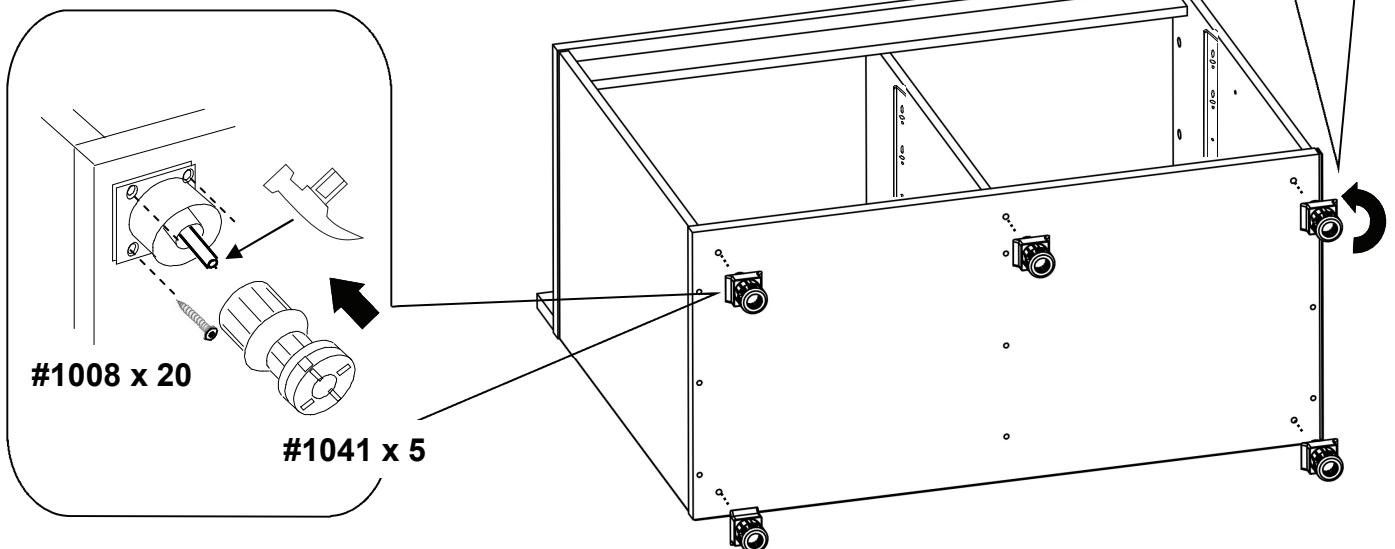

#1008 x 20

#1041 x 5

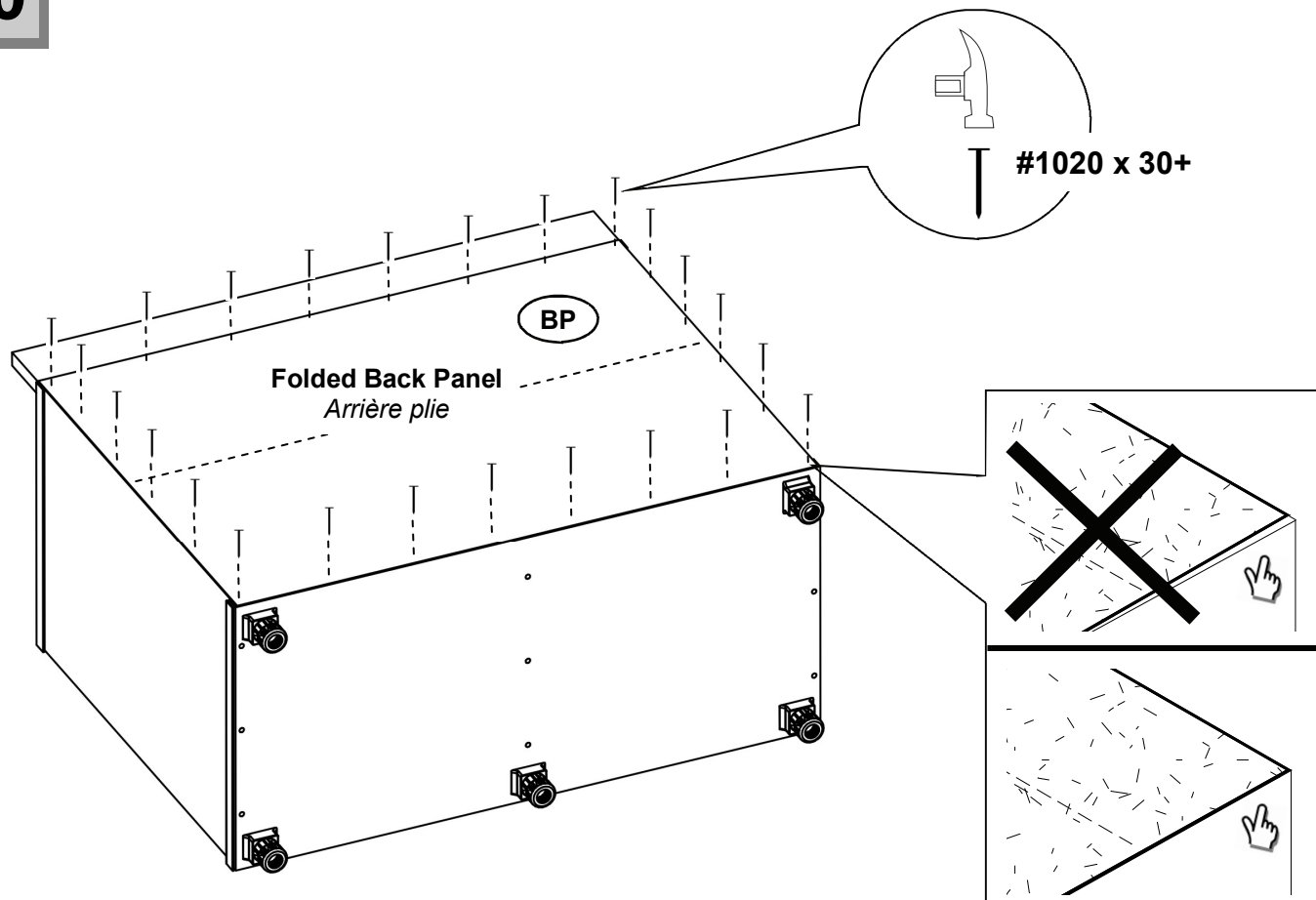

11

Assemble 2 drawers
Assemblez 2 tiroirs

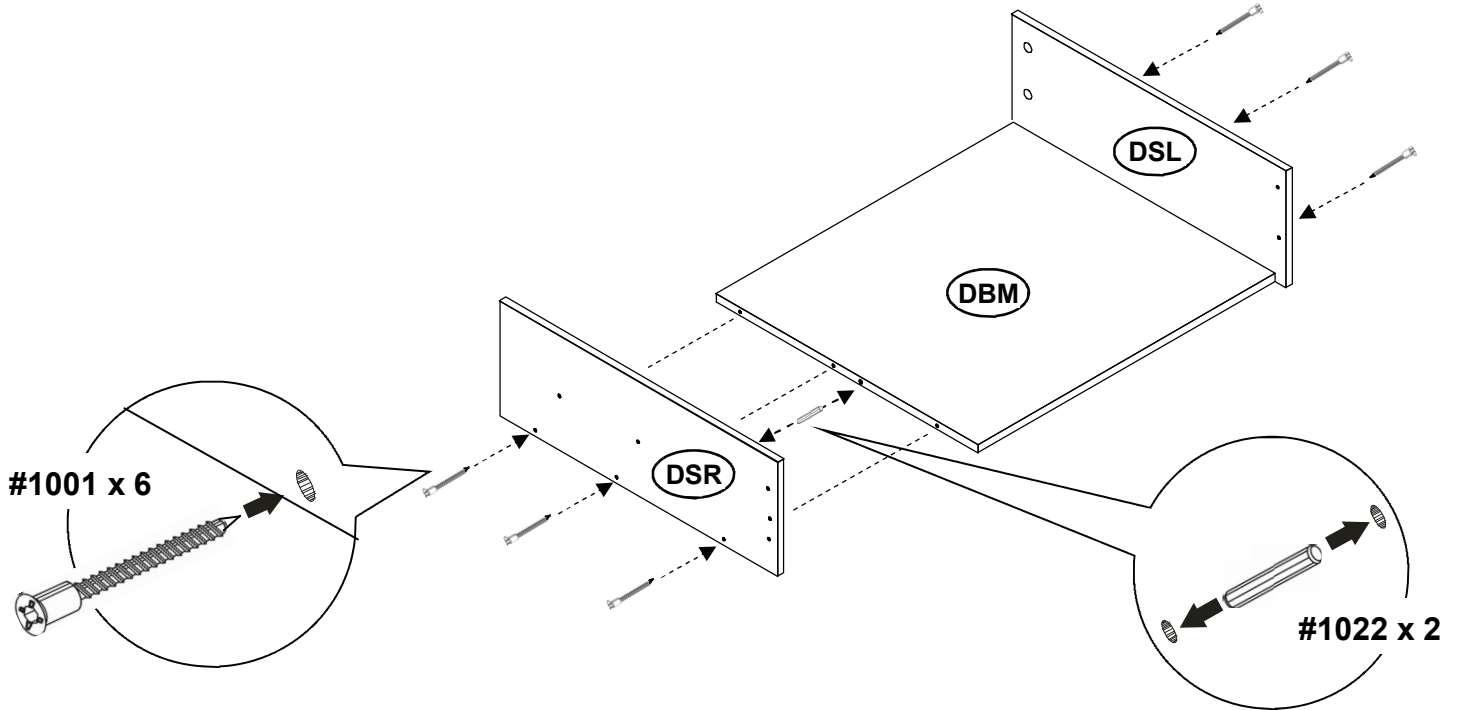
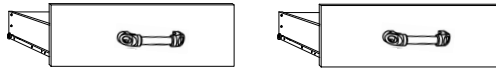

12

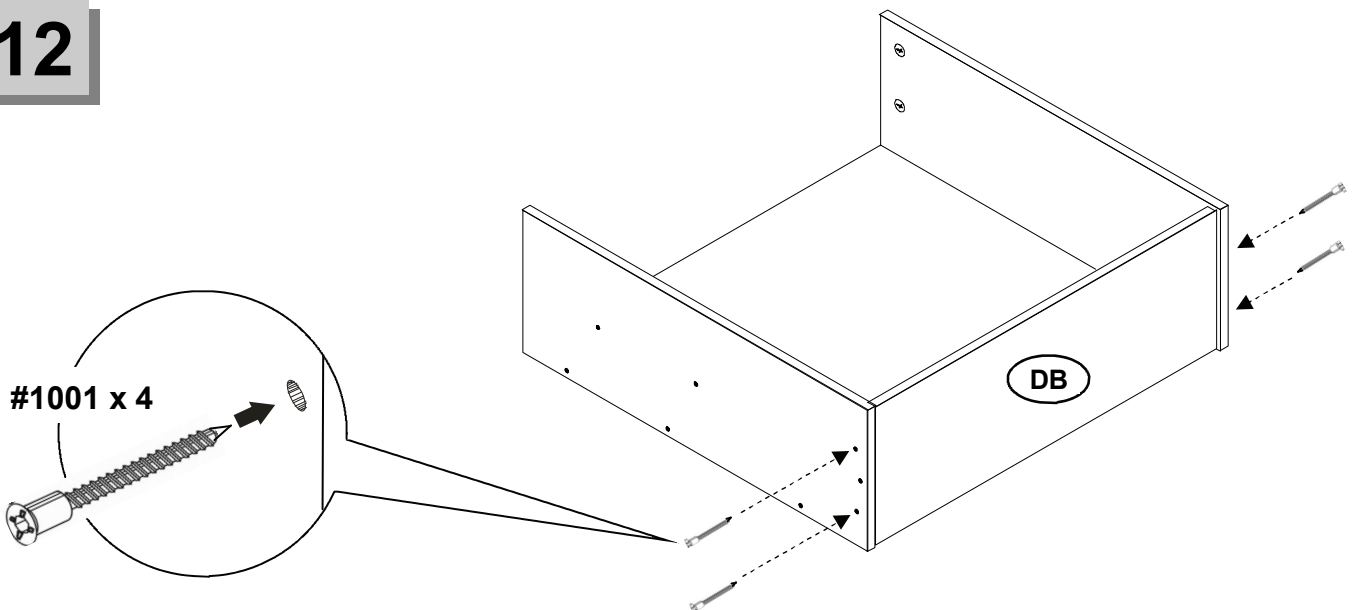

13

ATTENTION

- Only the Right drawer front (DFR) has a hole for the lock.
- *Seulement le bon avant de tiroir (DFR) a un trou pour la serrure.*

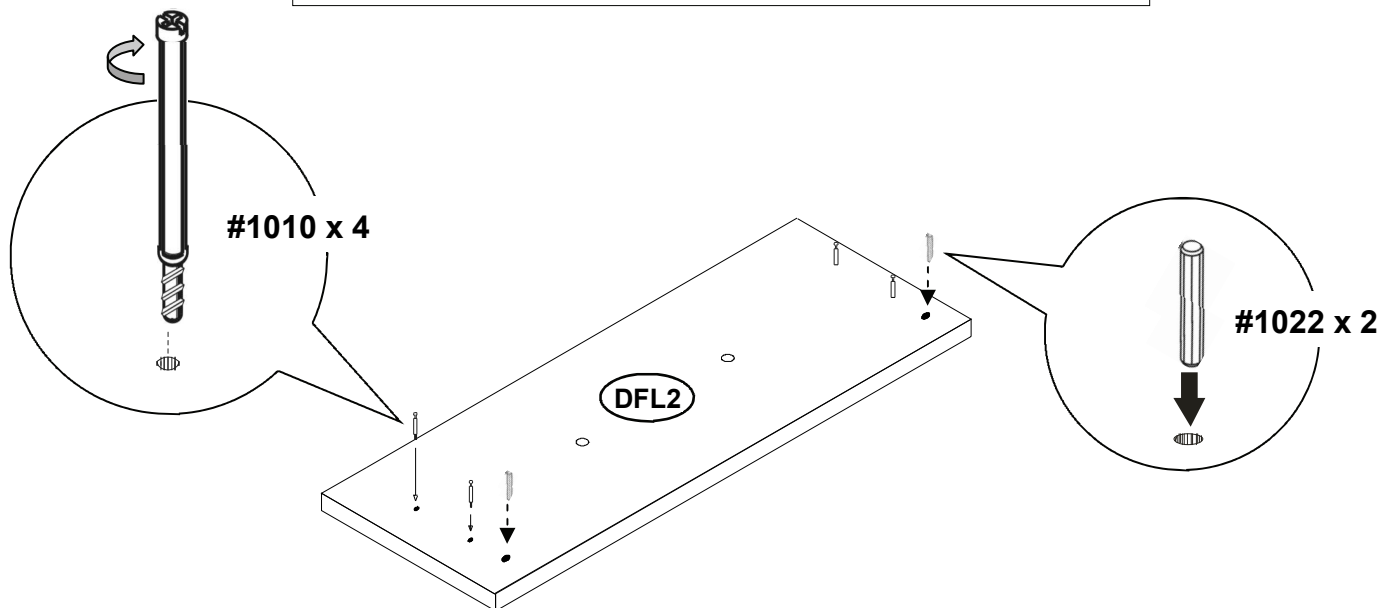

14

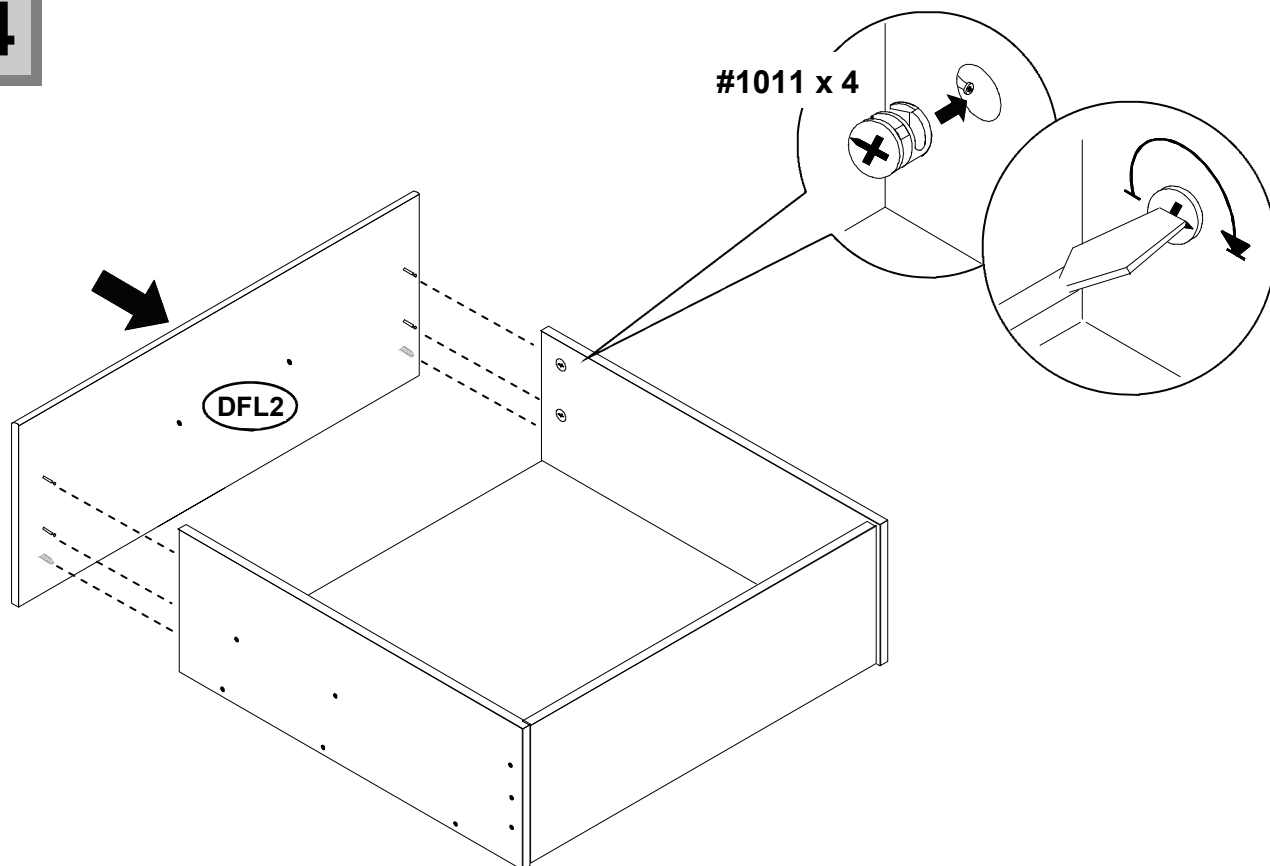

15

- Lift and stand cabinet upright.
- Pull up or push down on the black plastic lever to remove front rail from slide.
- Soulever et tenir le coffret droit.
- Tirer vers le haut sur le levier en plastique noir pour enlever le rail avant de la glissière.

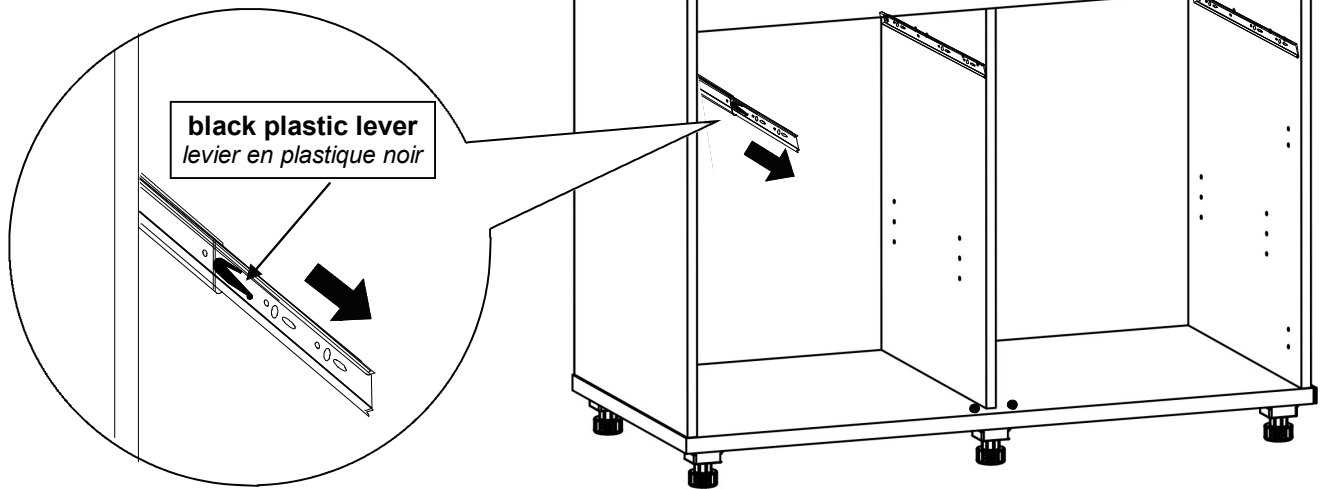

16

- Attach front rail to drawer sides and repeat with other drawer.
- Attacher le rail au côté et à la répétition de tiroir pour l'autre côté.

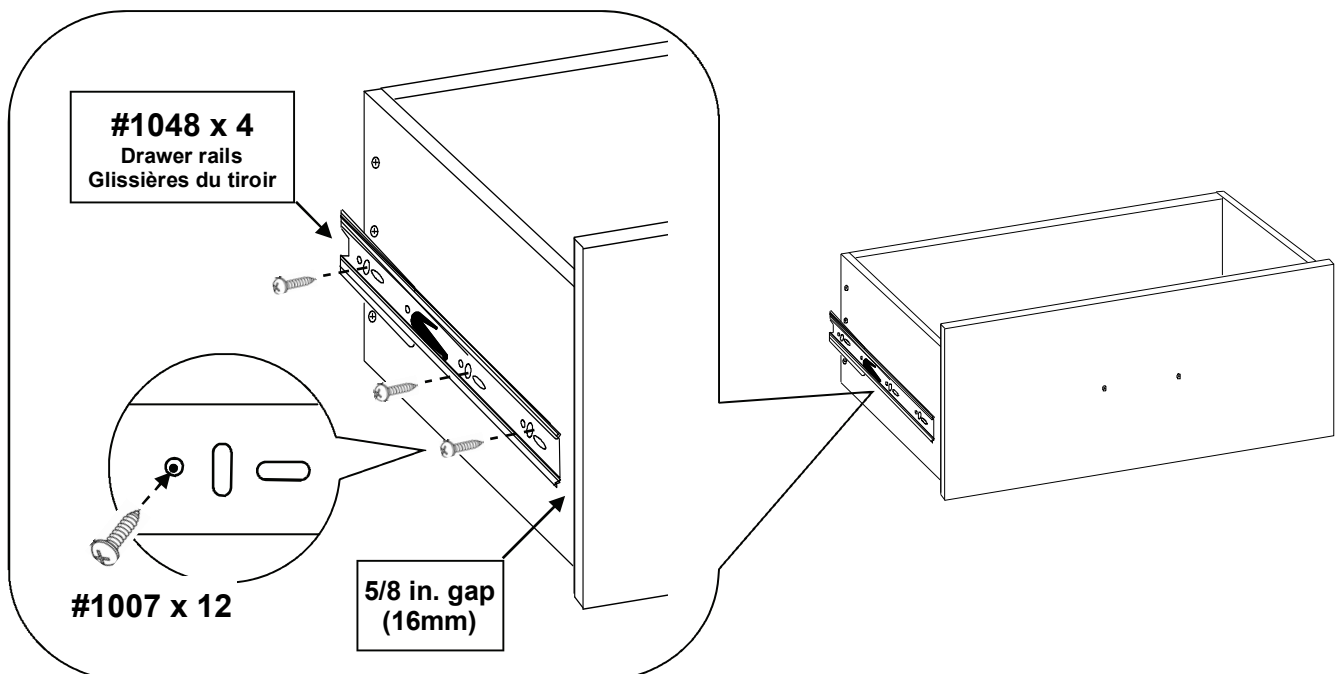

17

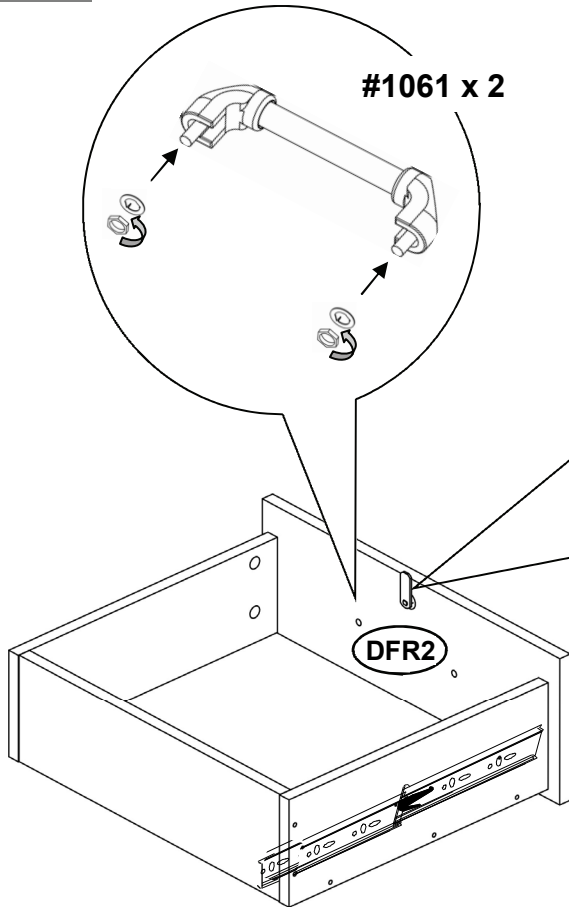

Drawer Lock Assembly - Right Drawer Only

- Remove screw and nut from key lock.
- Attach lock assembly to drawer front as shown.

Bloc de verrou de tiroir - Tiroir droit seulement

- Enlever la vis et l'écrou de la serrure principale.
- Attacher le bloc de verrou à l'avant de tiroir comme montré.

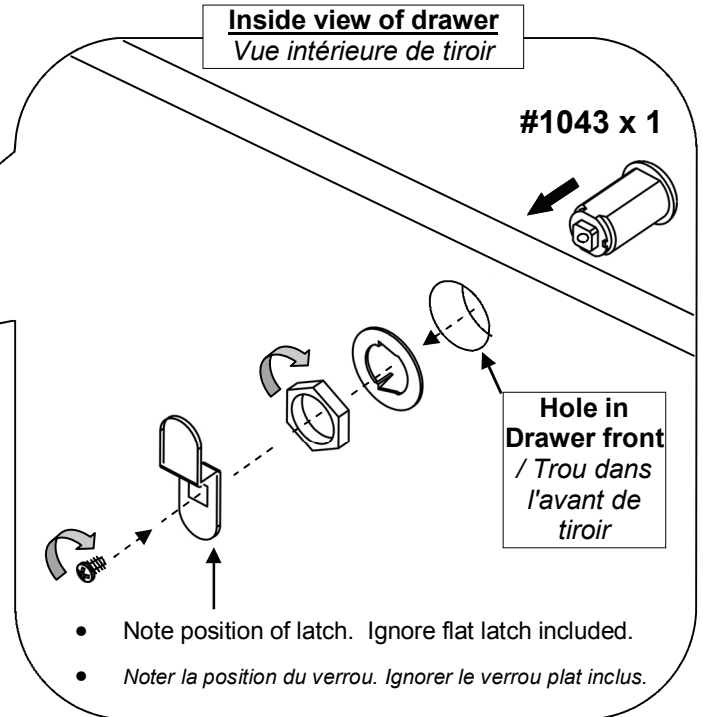

- Note position of latch. Ignore flat latch included.
- Noter la position du verrou. Ignorer le verrou plat inclus.

18

- Insert drawers into cabinet. Drawer with lock on right.
- Insérez les tiroirs dans le coffret. Tiroir avec la serrure sur la droite.

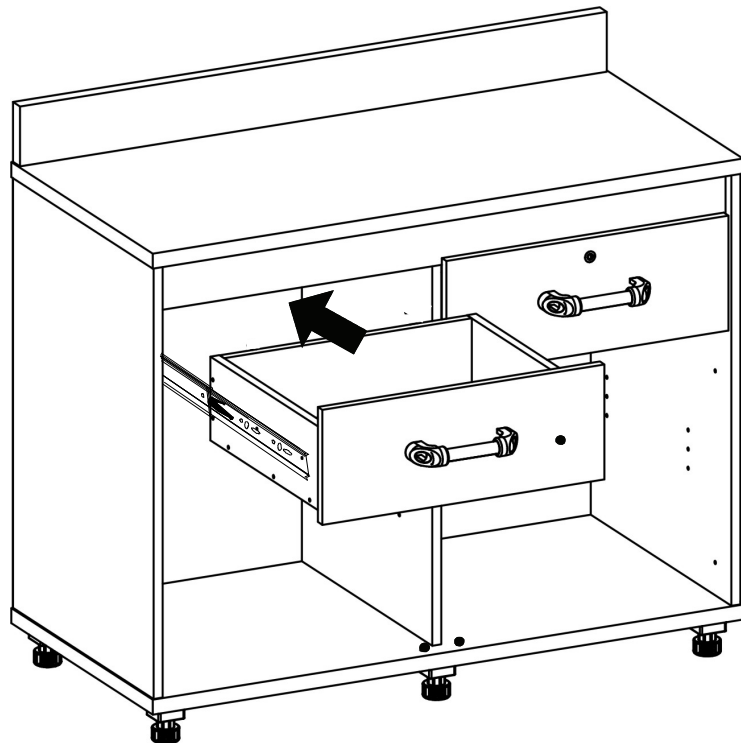

19

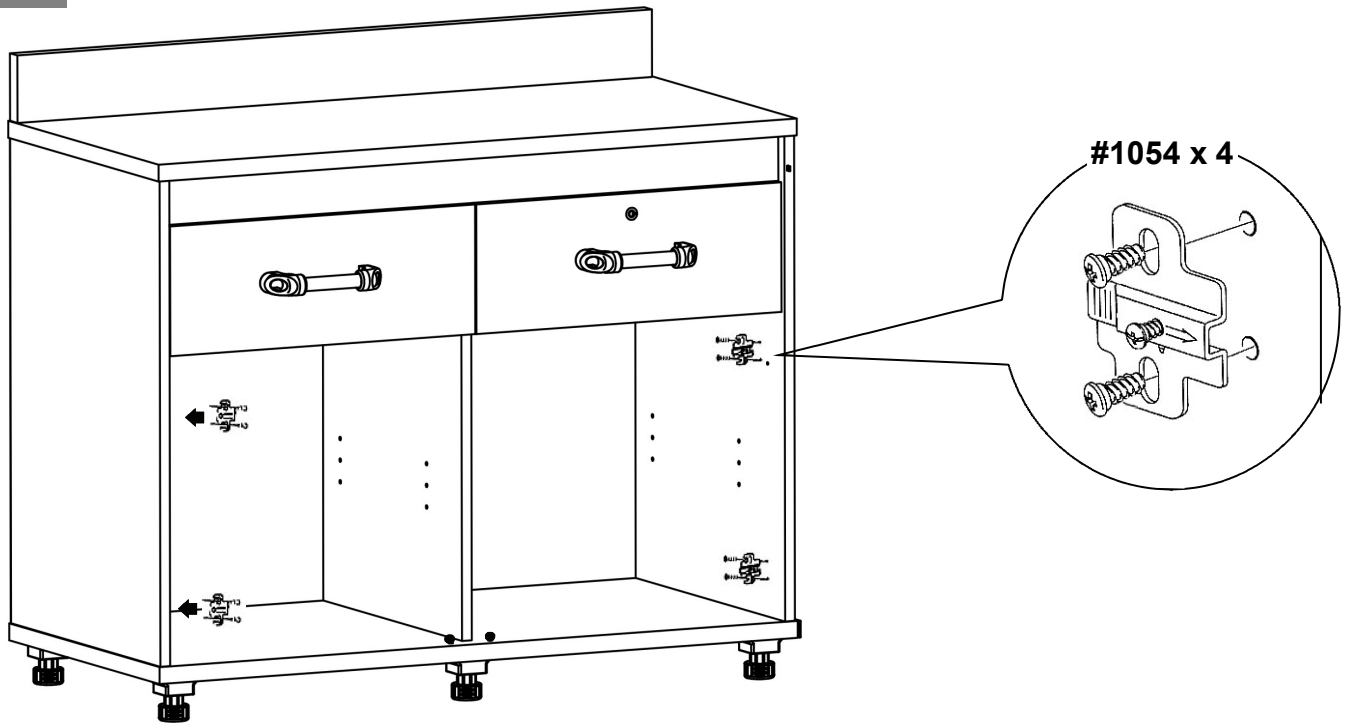

20

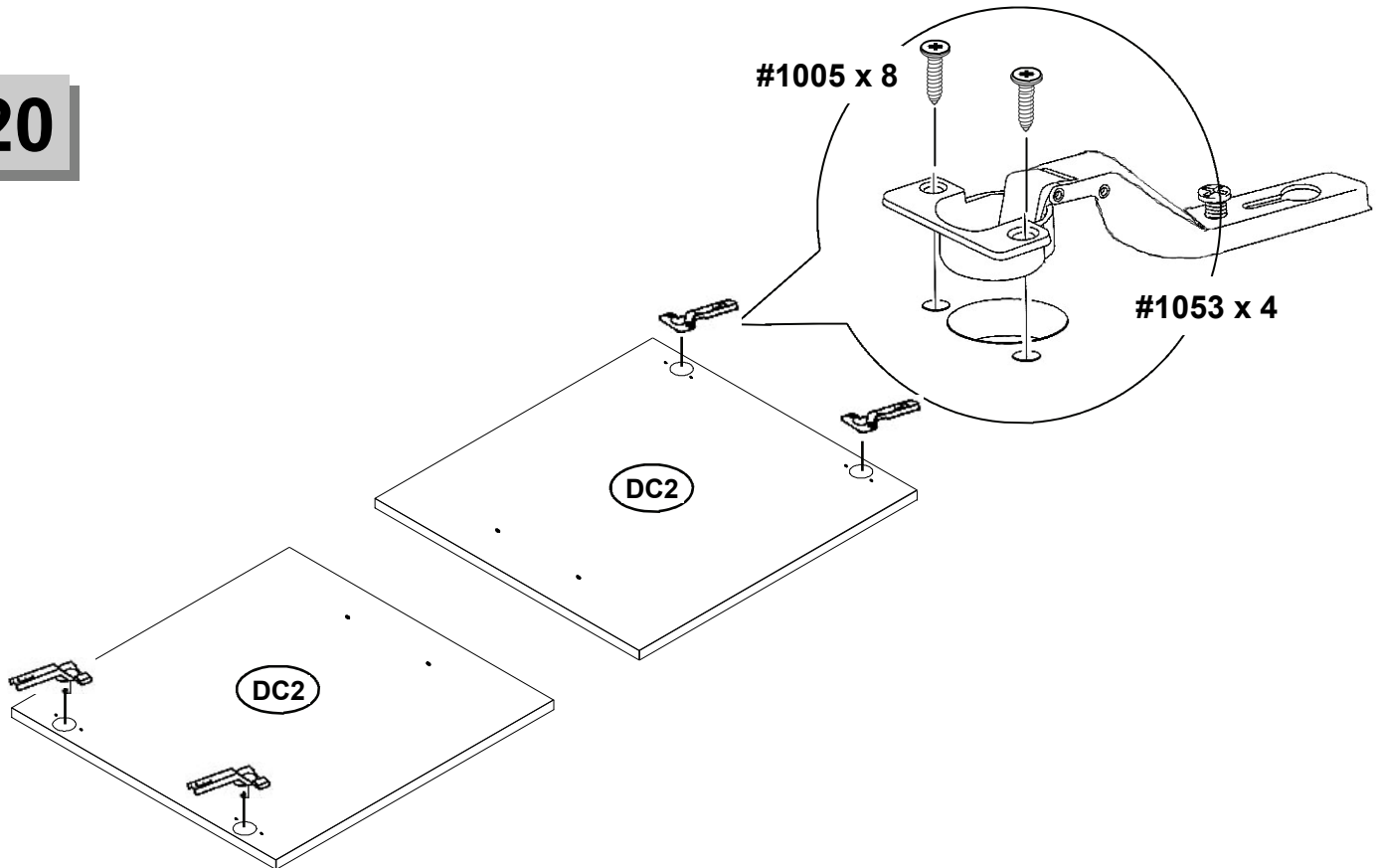

21

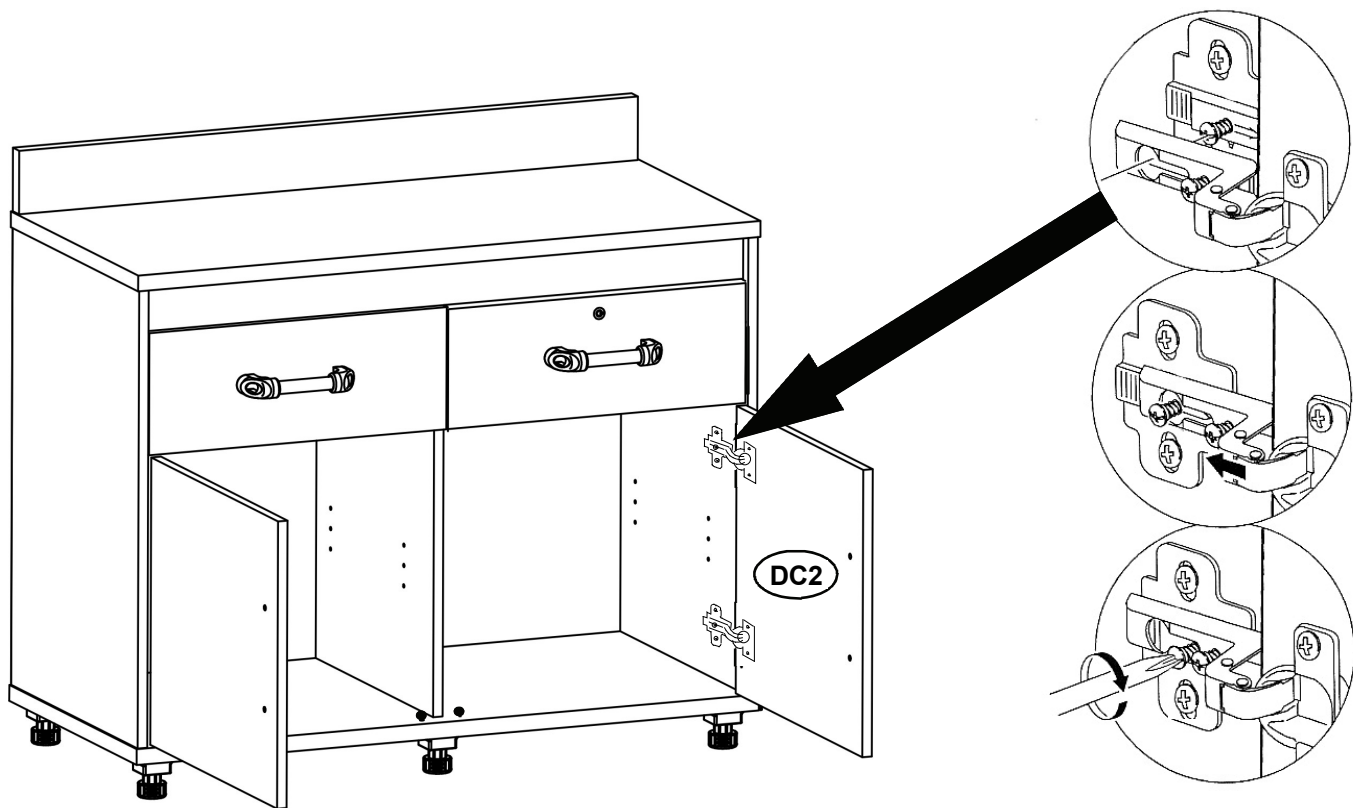

22

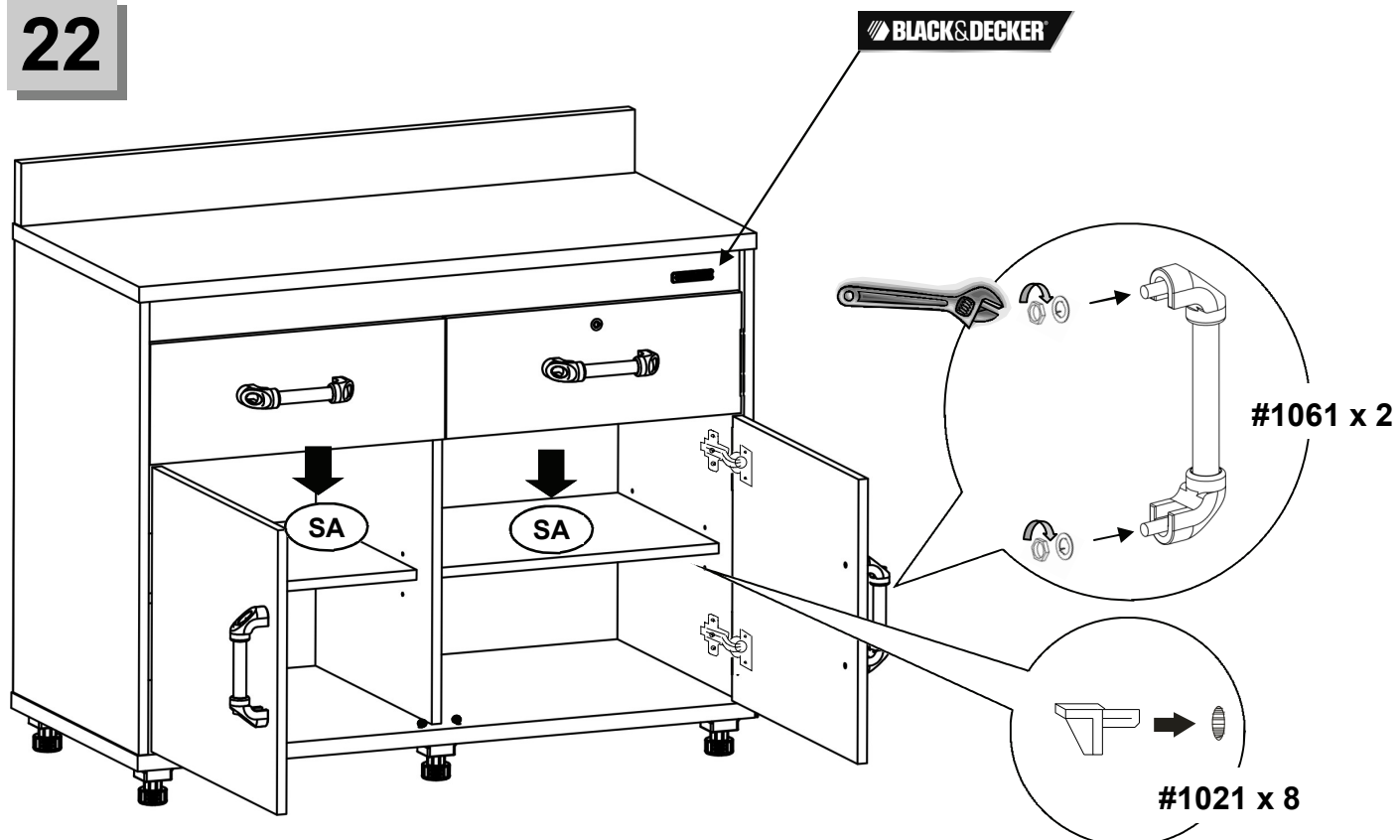

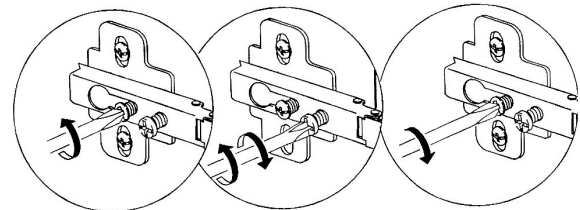
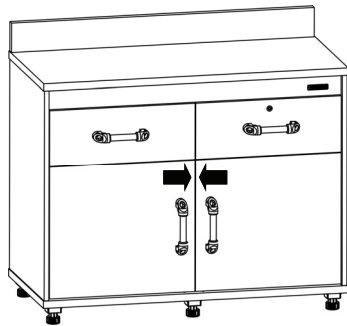
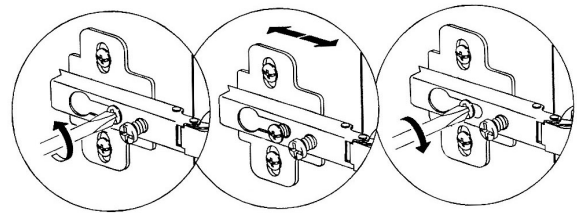
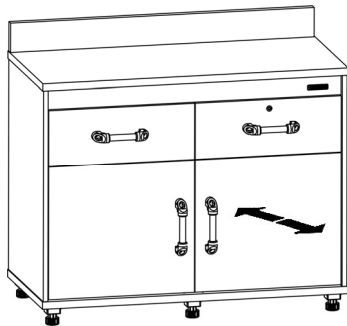
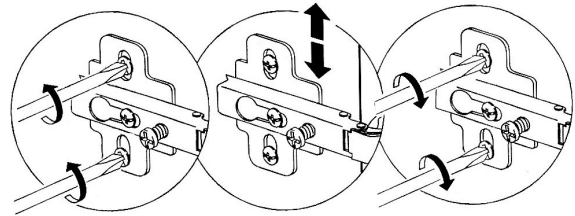
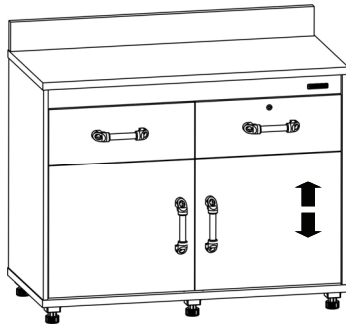

WEIGHT RESTRICTIONS

- Max. 20 lbs. (9 kg) per drawer.
- Max. 50 lbs. (22 kg) per shelf.
- Max. 100 lbs. (45 kg) on worktop.

USE AND CARE

- Dust and clean with a soft damp cloth and wipe with a dry soft cloth.
- Avoid cleaners and any abrasives that may scratch the surface.
- This product is not for outdoor use.

RESTRICTIONS DE POIDS

- Max. 20 livres. (9 kg) par tiroir.
- Max. 50 livres. (22 kg) par étagère.
- Max. 100 livres. (45 kg) sur le worktop.

UTILISATION ET SOIN

- La poussière et nettoient avec un tissu humide mou et essuient avec un tissu mou sec.
- Éviter les décapants et tous les abrasifs qui peuvent rayer la surface.
- Ce produit n'est pas pour l'usage extérieur.