

SSCR3.1/3.2

Height: 75 (2.95")
Length: 1700/2000 (66.93"/78.74")
Width: 75 (2.95")

Tube \varnothing : 31.8 (1.25")
Output @ 50°C Δ T: unheated
Electric element: n/a

All dimensions in millimetres & inches

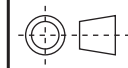

SCALE 1:8

mm's	inches
1700	66.93
2000	78.74
75	2.95

Manufactured from ISO/CEN CuZn30As (BS CZ126) brass tube

