

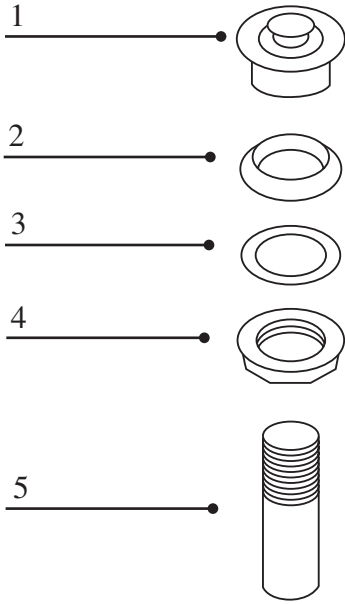

INSTALLATION INSTRUCTIONS
1.5" Lift & Turn Drain, DR160



1. Apply a small bead of 100% Silicone (non-waterbased) around the underside of strainer flange (1) according to putty manufacturer's instructions.

2. Assemble nut (4), gasket (2) and washer (3) taper side up to tailpiece (5). Thread tailpiece (5) into strainer flange (1) and tighten nut (2).

Note: White Foam seat washer is only used for glass sinks.

Remove all excess putty around the drain after the drain has been installed

WWW.NATIVETRAILS.NET



INSTALLATION INSTRUCTIONS
1.5" Lift & Turn Drain, DR160

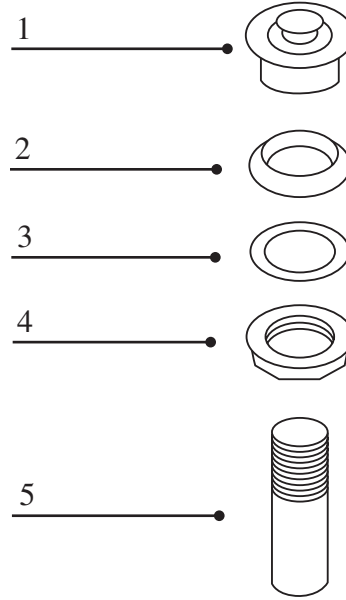

1. Apply a small bead of 100% Silicone (non-waterbased) around the underside of strainer flange (1) according to putty manufacturer's instructions.

2. Assemble nut (4), gasket (2) and washer (3) taper side up to tailpiece (5). Thread tailpiece (5) into strainer flange (1) and tighten nut (2).

Note: White Foam seat washer is only used for glass sinks.

Remove all excess putty around the drain after the drain has been installed

WWW.NATIVETRAILS.NET



INSTALLATION INSTRUCTIONS
1.5" Lift & Turn Drain, DR160

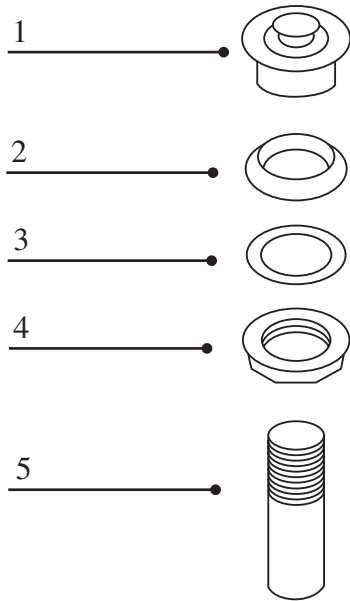

1. Apply a small bead of 100% Silicone (non-waterbased) around the underside of strainer flange (1) according to putty manufacturer's instructions.

2. Assemble nut (4), gasket (2) and washer (3) taper side up to tailpiece (5). Thread tailpiece (5) into strainer flange (1) and tighten nut (2).

Note: White Foam seat washer is only used for glass sinks.

Remove all excess putty around the drain after the drain has been installed

WWW.NATIVETRAILS.NET



INSTALLATION INSTRUCTIONS
1.5" Lift & Turn Drain, DR160

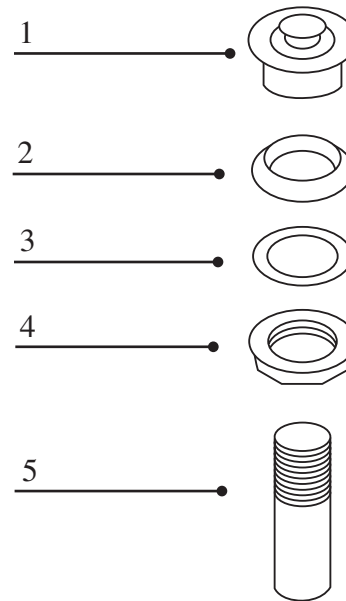

1. Apply a small bead of 100% Silicone (non-waterbased) around the underside of strainer flange (1) according to putty manufacturer's instructions.

2. Assemble nut (4), gasket (2) and washer (3) taper side up to tailpiece (5). Thread tailpiece (5) into strainer flange (1) and tighten nut (2).

Note: White Foam seat washer is only used for glass sinks.

Remove all excess putty around the drain after the drain has been installed

WWW.NATIVETRAILS.NET