



PRODUCT SPECIFICATIONS

Exclusively Designed • INTERNATIONALLY RECOGNIZED™

Rectangular Drop-in/Under Mount Model # {xx} - RT5035

Product Features:

- Natural Marble
- Drop-In or Under Mount Application
- Without Overflow
(Non-Overflow Drain Required)



This Product Complies With:

- SGS USTC
- IAPMO PS 99

Measurements:

- Width: 19-1/2" (49.5 cm)
- Length: 14" (35.6 cm)
- Fits Standard 1-1/4" (3.2 cm) Drain
- Height: 5-1/2" (14 cm)

Recommended Accessories:

- Any D'vontz ® Lavatory Drain Without Overflow
- Any D'vontz ® Vessel Faucet With Extension

PRODUCT DIMENSIONS

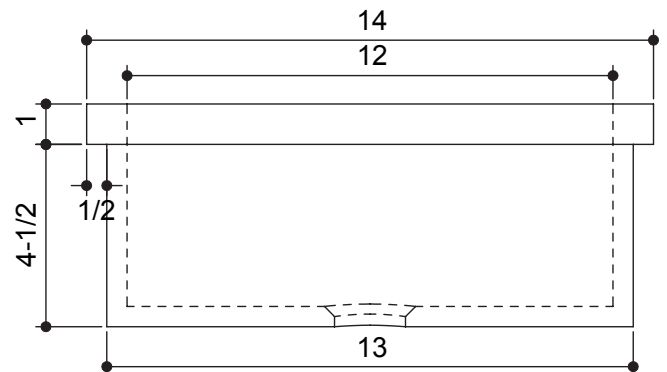
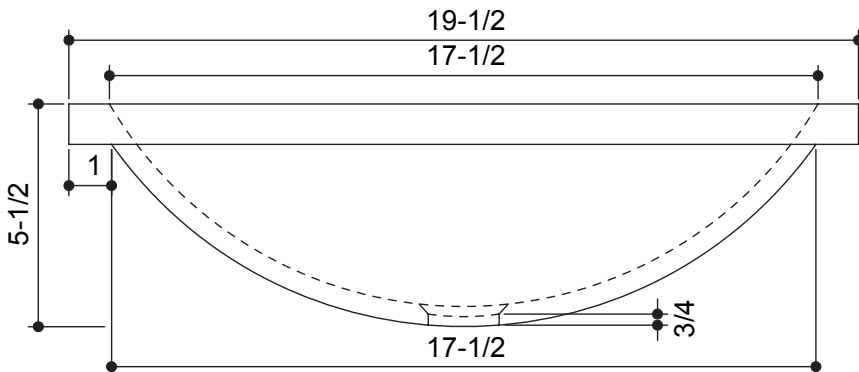
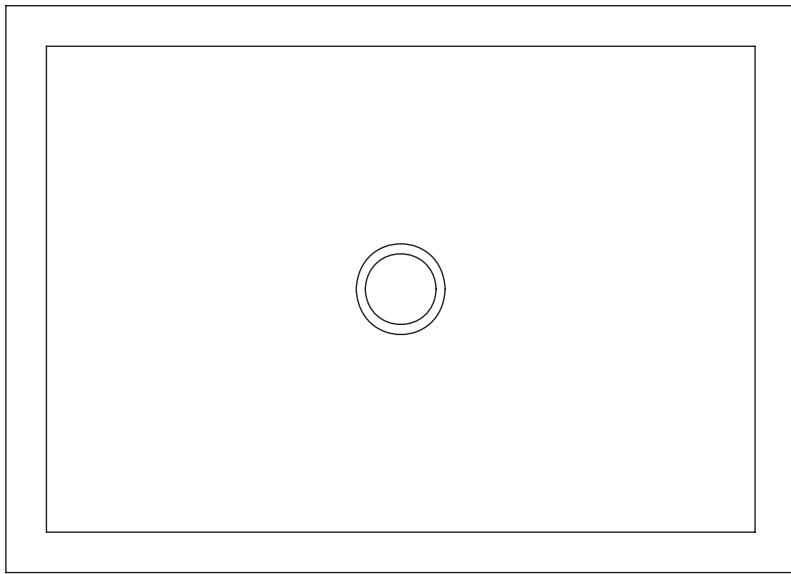

Please install this product according to the installation guide and all local plumbing codes.